

SMB/SMC

Features

- Two different coupling styles available. ie. snap together SMB, screw together SMC.
- Styles suitable for a variety of applications. eg. PCB mount, cable entry (both flexible and semi-rigid), and bulkhead applications.
- A choice of body plating, with gold or bright nickel as standard .
- Approved to meet BS9210, and BT8003 standards.
- A choice of solder/clamp, solder/crimp and crimp/crimp cable entry styles.
- Lipped body on SMB plugs improves lead in and reduces possible damage to mating half through misalignment.
- Most styles available in 50 ohm and 75 ohm versions.
- Straight plug, straight jack and straight bulkhead jack kits available. (comprising of connector and cable boots).

The following factors should be considered when selecting a connector:

- Series(Consider Application, Compatibility)
 Impedance(50 or 75 ohms)
 Style(Plug, Jack, Adapter...etc.)
 Finish(Bright Nickel, Gold...etc.)
 Method of Assembling Connector
 to Cable(Crimp, Clamp or Solder)
 Packingindividual bags or bulk packed

SMB (Snap together)

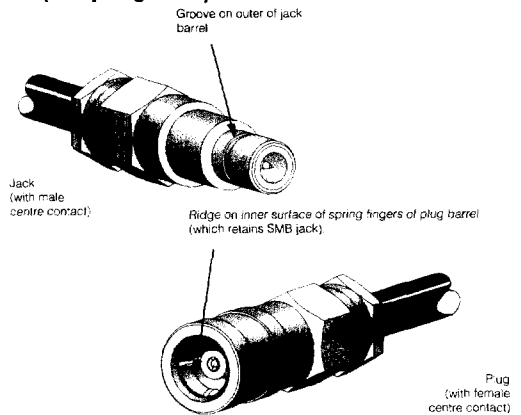

SMC (Screw together)

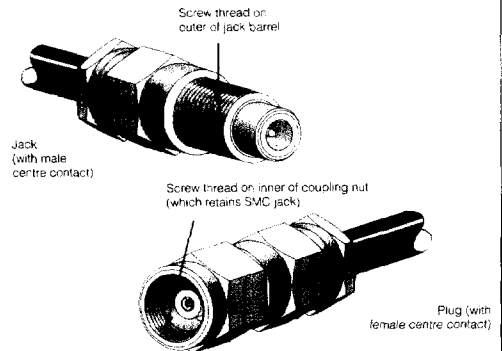

Contents

Typical Piece Parts	107
Specifications	108
Typical VSWR and Insertion Loss Characteristics	110
Straight Plugs	111
Elbow Plugs	112
Straight Jacks	113
Elbow Bulkhead Jacks and Sockets	114
Straight Bulkhead Jacks and Sockets ..	116
Cable Terminations	117
Plugs and Jacks	119
P.C.B. Plugs	121
P.C.B. Sockets	123

M/A-COM, Inc.

North America: Tel. (800) 366-2266 ■ Asia/Pacific: Tel. +85 2 2111 8088 ■ Europe: Tel. +44 (1344) 869 595
 Fax (800) 618-8883 Fax +85 2 2111 8087 Fax +44 (1344) 300 020

SMB/SMC Series

Product Descriptions

The extensive range of SMB, SMC and connectors manufactured by M/A-COM have been designed to satisfy high density, low loss requirements and have been successfully incorporated into a variety of differing systems including instrumentation equipment, airborne systems and communication equipment. The performance achieved from SMB and SMC connectors is similar to that obtained from BNC connectors, but their smaller physical size make them ideal general purpose sub-miniature connectors. The SMB and SMC series are constructed with gold plated brass bodies and gold plated beryllium copper or brass contacts set in PTFE insulators (for maximum reliability under adverse conditions) or nickel plated bodies with gold plated beryllium copper or brass contacts set in PTFE insulators (for commercial or less extreme working conditions).

The latching plug versions of the 75 ohm BT43 series are constructed with hard gold plated beryllium copper in all mating areas, with gold plated beryllium copper contacts.

The SMB and SMC series are fully compatible with BS9210 and MIL-G39012 standards. In addition appropriate items from the SMB/SMC and BT43 series are approved to BS9210 and BT specification 8003.

SMB

SMB connectors are designed to provide a quick connect/disconnect facility. These sub-miniature connector offer an economic solution to many limited space connection problems. SMB connector have a 4GHz frequency rating, similar to the BNC range, but due to their smaller physical size offer an additional high packing capabilities. SMB plugs retain SMB jacks/sockets using a ridge on the inner of the barrel, which snaps into a groove located on the outer of the jack/socket barrel.

SMC

SMC connectors provide an excellent semi-permanent connection, due to their screw together coupling mechanism. These connectors offer ideal solutions to connection problems in vibration environments, where space restraints prevail and a particularly low VSWR is required. SMC connectors have a frequency rating of 10GHz and are extensively used in mobile equipment applications.

M/A-COM, Inc.

North America: Tel. (800) 366-2266
Fax (800) 618-8883

Asia/Pacific: Tel. +85 2 2111 8088
Fax +85 2 2111 8087

Europe: Tel. +44 (1344) 869 595
Fax +44 (1344) 300 020

TYPICAL PIECE PARTS IN SOLDER/CLAMP AND CRIMP/CRIMP CONNECTORS

Solder/clamp connectors

Crimp/crimp connectors

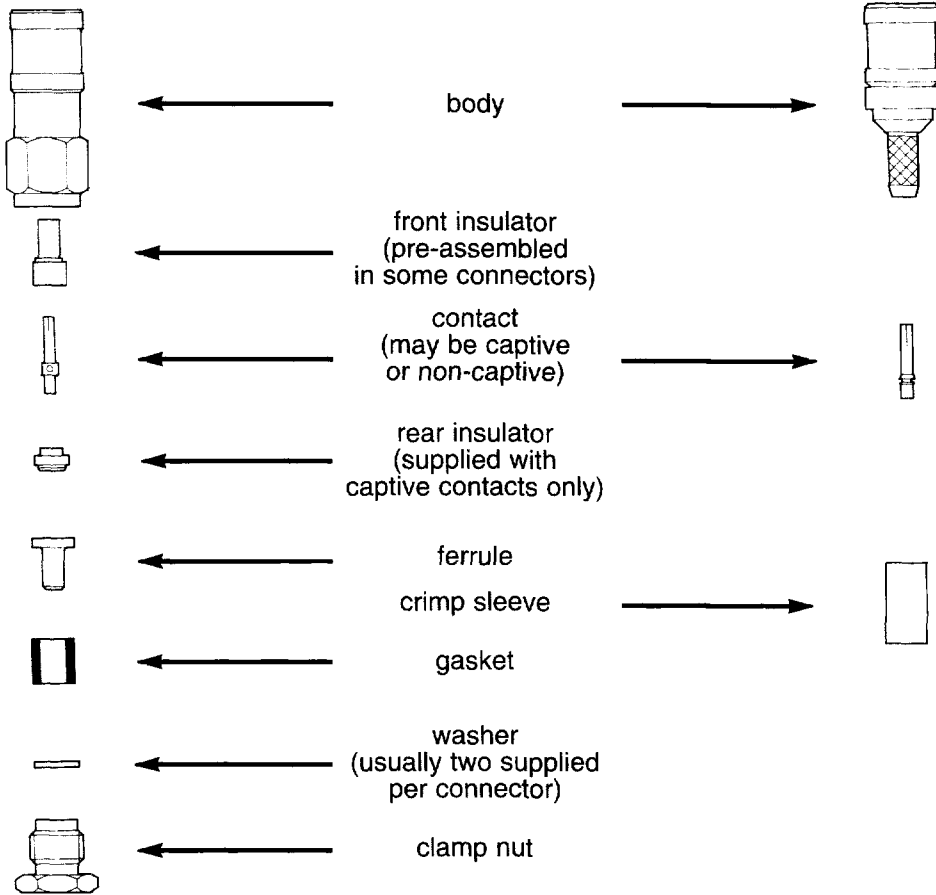

The piece parts indicated above are typical for SMB/SMC connectors. For assembly information and to assist recognition and checking of parts supplied, consult our Sales Office.

M/A-COM, Inc.

North America: Tel. (800) 366-2266
Fax (800) 618-8883

Asia/Pacific: Tel. +85 2 2111 8088
Fax +85 2 2111 8087

Europe: Tel. +44 (1344) 869 595
Fax +44 (1344) 300 020

SMB/SMC Specifications

SMB/SMC connectors have been designed to meet or exceed the requirements of BS9210 and MIL-C-39012. (All the information included within this page is typical for the series but will not necessarily apply to every style or variant.)

	SMB BS 9210N0007 or BS 9210F0026	SMC BS 9210F0027	SMB MIL-C-39012	SMC
VSWR (Straight outlet)	1.46 to 4GHz	1.41 to 4GHz 1.69 to 10GHz	1.30 + 0.04f* to 4GHz	1.25 + 0.04f to 10GHz
VSWR (Right angle outlet)	1.69 to 4GHz	1.57 to 4GHz 2.00 to 10GHz	1.45 + 0.06f to 4GHz (f=frequency in GHz)	1.40 + 0.06f to 10GHz
Working Voltage † (dc or ac peak)				
a) at sea level		500V		250V
b) at 20km		100V		60V
Proof Voltage †				
a) at sea level		1500V		750V
b) at 20 km		300V		185V
† Cable dependent				
Contact Resistance (max)				
a) before conditioning		5mΩ		6mΩ
b) after conditioning		10mΩ		8mΩ
Outer Conductor Continuity				
a) before conditioning		2mΩ		1mΩ
b) after conditioning		5mΩ		1.5mΩ
Insulation Resistance				
a) before conditioning		5GΩ		1GΩ
b) after conditioning		500MΩ		N/A
Vibration Severity				
Frequency range		10Hz to 500Hz		MIL STD 202
Displacement		0.75mm		
Acceleration		98m/s ²	Method 204 (B)	Method 204 (D)
Duration	30 min	6 hrs		
Shock severity	N/A	490m/s ² for 11ms	Method 213 (B)	Method 213 (C)
Impact severity		5 impacts @ 1m		N/A
Bump severity		4000 @ 1 390m/s ²		N/A
Climatic category		55/155/21		Method 102 (C)
Engagement force max.	60N	—	62N	N/A
Separation force max.	60N	—	62N	N/A
Separation force min.	8N	—	9N	N/A
Normal coupling torque	—	420 450 mN.m	N/A	248 354mN.m
Coupling proof torque	—	N/A	N/A	708mN.m

M/A-COM, Inc.

North America: Tel. (800) 366-2266
Fax (800) 618-8883

Asia/Pacific: Tel. +85 2 2111 8088
Fax +85 2 2111 8087

Europe: Tel. +44 (1344) 869 595
Fax +44 (1344) 300 020

SMB/SMC Specifications

	SMB BS 9210N0007 or BS 9210F0026	SMC BS 9210F0027	SMB MIL-C-39012	SMC
Material				
Body parts		Brass		
Center contacts				
Male		Brass		
Female		Heat treated beryllium copper		
Insulation		PTFE		
Gaskets		Silicone rubber		
Finish				
Center contacts		2.54 μm min. hard gold over copper	To requirement of para. 3.14 of specification	
Body parts		Gold plate to meet climatic category		
Design		To control dwgs. part 2		
			Within interface dimensions of specification	

M/A-COM, Inc.

North America: Tel. (800) 366-2266
Fax (800) 618-8883

Asia/Pacific: Tel. +85 2 2111 8088
Fax +85 2 2111 8087

Europe: Tel. +44 (1344) 869 595
Fax +44 (1344) 300 020

TYPICAL VSWR CHARACTERISTICS

SMB

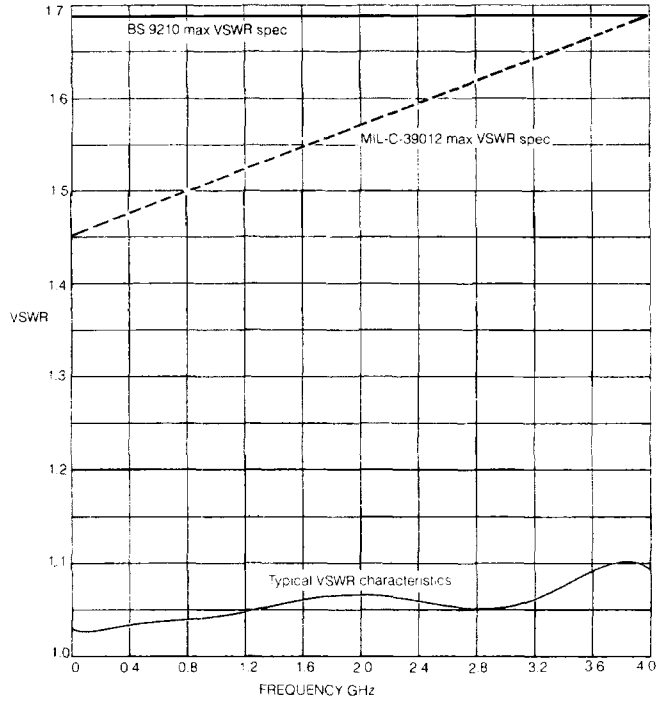

SMC

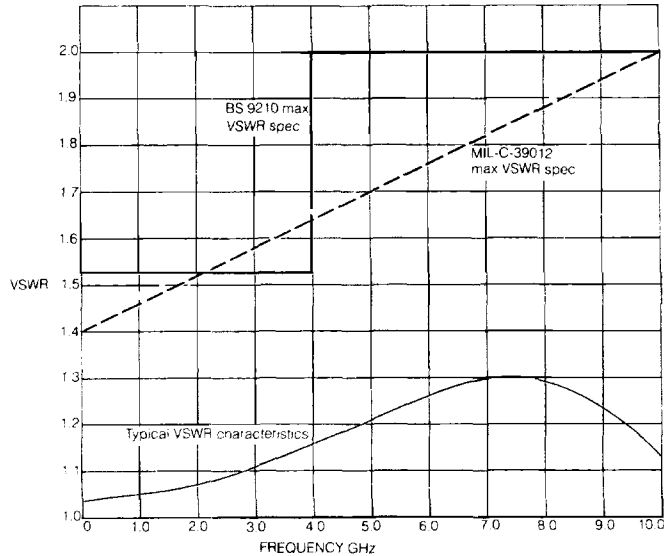

The performance characteristics outlined above are based upon tests carried out upon part numbers B65H48G022X99 and C65H48G022X99. For VSWR details on other versions contact our sales office.

MA-COM, Inc.

North America: Tel. (800) 366-2266
Fax (800) 618-8883

Asia/Pacific: Tel. +85 2 2111 8088
Fax +85 2 2111 8087

Europe: Tel. +44 (1344) 869 595
Fax +44 (1344) 300 020

SMB/SMC Series

STRAIGHT PLUGS/50 OHM (for flexible cable)

**Solder center contact
clamp outer
(female center contact)**

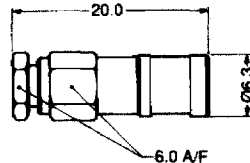

Cable Group ①	Body Plating	Contact Plating	Part Number	
			SMB	SMC
022	Gold	Gold	B65 A01 G022 X99	C65 A01 G022 X99
022	Bright Nickel	Gold	B65 A01 J022 X99	C65 A01 J022 X99
024	Gold	Gold	B65 A01 G024 X99	C65 A01 G024 X99
024	Bright Nickel	Gold	B65 A01 J024 X99	C65 A01 J024 X99

**Crimp center contact
crimp outer
(female center contact)**

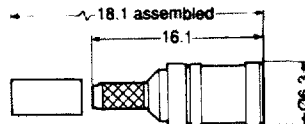

Cable Group ①	Body Plating	Contact Plating	Part Number	
			SMB	SMC
022	Gold	Gold	B65 A61 G022 X99	C65 A61 G022 X99
022	Bright Nickel	Gold	B65 A61 J022 X99	C65 A61 J022 X99
024	Gold	Gold	B65 A61 G024 X99	C65 A61 G024 X99
024	Bright Nickel	Gold	B65 A61 J024 X99	C65 A61 J024 X99

① For cable group to cable type cross reference refer to page 200.

All diagrams are for SMB versions.

All dimensions are nominal.

For 75 ohm versions see page 157 to 167, or contact our sales office for uncataloged requirements.

All measurements are in millimeters unless otherwise specified.

M/A-COM, Inc.

North America: Tel. (800) 366-2266 ■ Asia/Pacific: Tel. +85 2 2111 8088 ■ Europe: Tel. +44 (1344) 869 595
 Fax (800) 618-8883 Fax +85 2 2111 8087 Fax +44 (1344) 300 020

SMB/SMC Series

ELBOW PLUGS/50 OHM (for flexible cable)

**Solder center contact
clamp outer
(female center contact)**

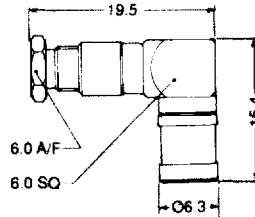

Cable Group ①	Body Plating	Contact Plating	Part Number	
			SMB	SMC
022	Gold	Gold	B65 B02 G022 X99	C65 B02 G022 X99
022	Bright Nickel	Gold	B65 B02 J022 X99	C65 B02 J022 X99
024	Gold	Gold	B65 B02 G024 X99	C65 B02 G024 X99
024	Bright Nickel	Gold	B65 B02 J024 X99	C65 B02 J024 X99

**Low profile solder
center contact
crimp outer
(female center contact)**

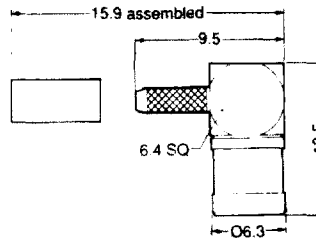

Cable Group ①	Body Plating	Contact Plating	Part Number	
			SMB	SMC
022	Gold	Gold	B65 B37 G022 X99	C65 B37 G022 X99
022	Bright Nickel	Gold	B65 B37 J022 X99	C65 B37 J022 X99
024	Gold	Gold	B65 B37 G024 X99	C65 B37 G024 X99
024	Bright Nickel	Gold	B65 B37 J024 X99	C65 B37 J024 X99

① For cable group to cable type cross reference refer to page 200.

All diagrams are for SMB versions.

All dimensions are nominal.

For 75 ohm versions see page 157 to 167, or contact our sales office for uncataloged requirements.

All measurements are in millimeters unless otherwise specified.

M/A-COM, Inc.

North America: Tel. (800) 366-2266
Fax (800) 618-8883

Asia/Pacific: Tel. +85 2 2111 8088
Fax +85 2 2111 8087

Europe: Tel. +44 (1344) 869 595
Fax +44 (1344) 300 020

SMB/SMC Series

ELBOW PLUGS/50 OHM (for flexible cable)

Solder spill bulkhead (female center contact)

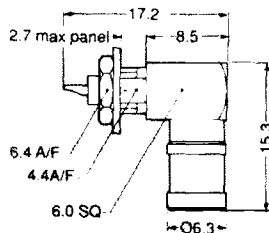

mounting detail

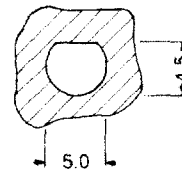

Body Plating	Contact Plating	Part Number	
		SMB	SMC
Gold	Gold	B65 D22 G999 X99	C65 D22 G999 X99
Bright Nickel	Gold	B65 D22 J999 X99	C65 D22 J999 X99

STRAIGHT JACKS/50 OHM (for flexible cable)

Solder center contact clamp outer (male center contact)

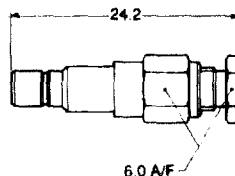

Cable Group ①	Body Plating	Contact Plating	Part Number	
			SMB	SMC
022	Gold	Gold	B65 E06 G022 X99	C65 E06 G022 X99
022	Bright Nickel	Gold	B65 E06 J022 X99	C65 E06 J022 X99
024	Gold	Gold	B65 E06 G024 X99	C65 E06 G024 X99
024	Bright Nickel	Gold	B65 E06 J024 X99	C65 E06 J024 X99

① For cable group to cable type cross reference refer to page 200.

All diagrams are for SMB versions.

All dimensions are nominal.

For 75 ohm versions see page 157 to 167, or contact our sales office for uncataloged requirements.

All measurements are in millimeters unless otherwise specified.

M/A-COM, Inc.

North America: Tel. (800) 366-2266
Fax (800) 618-8883

Asia/Pacific: Tel. +85 2 2111 8088
Fax +85 2 2111 8087

Europe: Tel. +44 (1344) 869 595
Fax +44 (1344) 300 020

SMB/SMC Series

STRAIGHT JACKS/50 OHM (for flexible cable)

**Crimp center contact
crimp outer
(male center contact)**

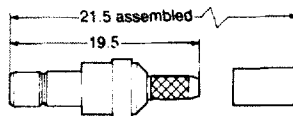

Cable Group ①	Body Plating	Contact Plating	Part Number	
			SMB	SMC
022	Gold	Gold	B65 E66 G022 X99	C65 E66 G022 X99
022	Bright Nickel	Gold	B65 E66 J022 X99	C65 E66 J022 X99
024	Gold	Gold	B65 E66 G024 X99	C65 E66 G024 X99
024	Bright Nickel	Gold	B65 E66 J024 X99	C65 E66 J024 X99

ELBOW BULKHEAD JACKS AND SOCKETS/50 OHM (for flexible cable)

**Solder center contact
clamp outer
(male center contact)**

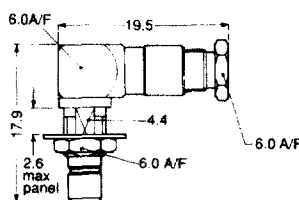

mounting detail

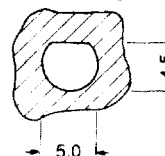

Cable Group ①	Body Plating	Contact Plating	Part Number	
			SMB	SMC
022	Gold	Gold	B65 H48 G022 X99	C65 H48 G022 X99
022	Bright Nickel	Gold	B65 H48 J022 X99	C65 H48 J022 X99
024	Gold	Gold	B65 H48 G024 X99	C65 H48 G024 X99
024	Bright Nickel	Gold	B65 H48 J024 X99	C65 H48 J024 X99

① For cable group to cable type cross reference refer to page 200.

All diagrams are for SMB versions.

All dimensions are nominal.

For 75 ohm versions see page 157 to 167, or contact our sales office for uncataloged requirements.

All measurements are in millimeters unless otherwise specified.

M/A-COM, Inc.

North America: Tel. (800) 366-2266
Fax (800) 618-8883

Asia/Pacific: Tel. +85 2 2111 8088
Fax +85 2 2111 8087

Europe: Tel. +44 (1344) 869 595
Fax +44 (1344) 300 020

SMB/SMC Series

STRAIGHT BULKHEAD JACKS AND SOCKETS/50 OHM (for flexible cable)

**Crimp center contact
crimp outer
(male center contact)**

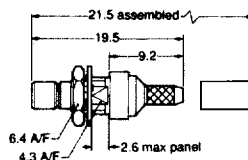

mounting detail

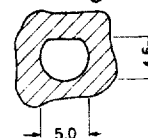

Cable Group ①	Body Plating	Contact Plating	Part Number	
			SMB	SMC
022	Gold	Gold	B65 H65 G022 X99	C65 H65 G022 X99
022	Bright Nickel	Gold	B65 H65 J022 X99	C65 H65 J022 X99
024	Gold	Gold	B65 H65 G024 X99	C65 H65 G024 X99
024	Bright Nickel	Gold	B65 H65 J024 X99	C65 H65 J024 X99

**Solder spill
rear mount socket
(male center contact)**

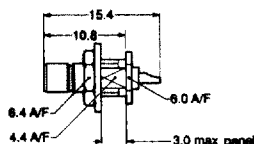

mounting detail

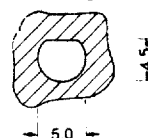

Body Plating	Contact Plating	Part Number	
		SMB	SMC
Gold	Gold	B65 M08 G999 X99	C65 M08 G999 X99
Bright Nickel	Gold	B65 M08 J999 X99	C65 M08 J999 X99

**Solder spill
front mount socket
(male center contact)**

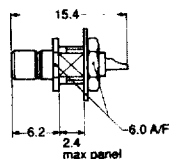

mounting detail

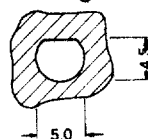

Body Plating	Contact Plating	Part Number	
		SMB	SMC
Gold	Gold	B65 M18 G999 X99	C65 M18 G999 X99
Bright Nickel	Gold	B65 M18 J999 X99	C65 M18 J999 X99

① For cable group to cable type cross reference refer to page 200.

All diagrams are for SMB versions.

All dimensions are nominal.

For 75 ohm versions see page 157 to 167, or contact our sales office for uncataloged requirements.

All measurements are in millimeters unless otherwise specified.

M/A-COM, Inc.

North America: Tel. (800) 366-2266
Fax (800) 618-8883

Asia/Pacific: Tel. +85 2 2111 8088
Fax +85 2 2111 8087

Europe: Tel. +44 (1344) 869 595
Fax +44 (1344) 300 020

SMB/SMC Series

CABLE TERMINATORS/50 OHM (for flexible cable)

Straight clamp

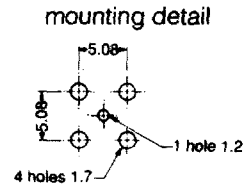
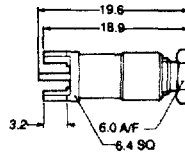

Cable Group ①	Body Plating	Contact Plating	Part Number
022	Gold	Gold	X65 X09 G022 X99
022	Bright Nickel	Gold	X65 X09 J022 X99
024	Gold	Gold	X65 X09 G024 X99
024	Bright Nickel	Gold	X65 X09 J024 X99

Straight crimp

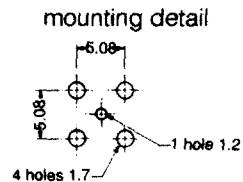
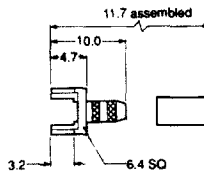

Cable Group ①	Body Plating	Part Number
022	Gold	X65 X08 G022 X99
022	Bright Nickel	X65 X08 J022 X99
024	Gold	X65 X08 G024 X99
024	Bright Nickel	X65 X08 J024 X99

① For cable group to cable type cross reference refer to page 200.

All diagrams are for SMB versions.

All dimensions are nominal.

For 75 ohm versions see page 157 to 167, or contact our sales office for uncataloged requirements.

All measurements are in millimeters unless otherwise specified.

M/A-COM, Inc.

North America: Tel. (800) 366-2266
Fax (800) 618-8883

Asia/Pacific: Tel. +85 2 2111 8088
Fax +85 2 2111 8087

Europe: Tel. +44 (1344) 869 595
Fax +44 (1344) 300 020

SMB/SMC Series

CABLE TERMINATORS/50 OHM (for flexible cable)

Elbow clamp

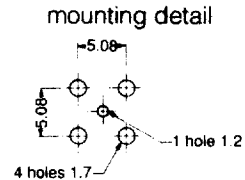
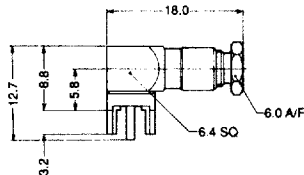

Cable Group ①	Body Plating	Contact Plating	Part Number
022	Gold	Gold	X65 X10 G022 X99
022	Bright Nickel	Gold	X65 X10 J022 X99
024	Gold	Gold	X65 X10 G024 X99
024	Bright Nickel	Gold	X65 X10 J024 X99

Elbow crimp

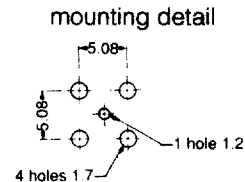
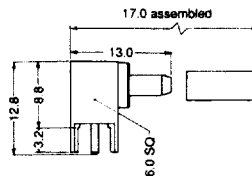

Cable Group ①	Body Plating	Contact Plating	Part Number
022	Gold	Gold	X65 X11 G022 X99
022	Bright Nickel	Gold	X65 X11 J022 X99
024	Gold	Gold	X65 X11 G024 X99
024	Bright Nickel	Gold	X65 X11 J024 X99

① For cable group to cable type cross reference refer to page 200.

All diagrams are for SMB versions.

All dimensions are nominal.

For 75 ohm versions see page 157 to 167, or contact our sales office for uncataloged requirements.

All measurements are in millimeters unless otherwise specified.

M/A-COM, Inc.

North America: Tel. (800) 366-2266
Fax (800) 618-8883

Asia/Pacific: Tel. +85 2 2111 8088
Fax +85 2 2111 8087

Europe: Tel. +44 (1344) 869 595
Fax +44 (1344) 300 020

SMB/SMC Series

PLUGS AND JACKS/50 OHM (for semi-rigid cable)

**Straight plug solder
center contact
clamp outer
(female center contact)**

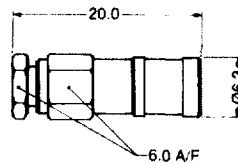

Cable Group ①	Body Plating	Contact Plating	Part Number	
			SMB	SMC
073	Gold	Gold	B65 A01 G073 X99	C65 A01 G073 X99
073	Bright Nickel	Gold	B65 A01 J073 X99	C65 A01 J073 X99
285	Gold	Gold	B65 A01 G285 X99	C65 A01 G285 X99
285	Bright Nickel	Gold	B65 A01 J285 X99	C65 A01 J285 X99

**Elbow plug solder
center contact
clamp outer
(female center contact)**

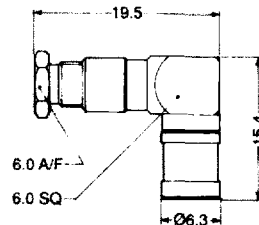

Cable Group ①	Body Plating	Contact Plating	Part Number	
			SMB	SMC
073	Gold	Gold	B65 B02 G073 X99	C65 B02 G073 X99
073	Bright Nickel	Gold	B65 B02 J073 X99	C65 B02 J073 X99
285	Gold	Gold	B65 B02 G285 X99	C65 B02 G285 X99
285	Bright Nickel	Gold	B65 B02 J285 X99	C65 B02 J285 X99

① For cable group to cable type cross reference refer to page 200.

All diagrams are for SMB versions.

All dimensions are nominal.

For 75 ohm versions see page 157 to 167, or contact our sales office for uncataloged requirements.

All measurements are in millimeters unless otherwise specified.

M/A-COM, Inc.

North America: Tel. (800) 366-2266
Fax (800) 618-8883

Asia/Pacific: Tel. +85 2 2111 8088
Fax +85 2 2111 8087

Europe: Tel. +44 (1344) 869 595
Fax +44 (1344) 300 020

SMB/SMC Series

PLUGS AND JACKS/50 OHM (for semi-rigid cable)

**Straight jack solder
center contact
clamp outer
(male center contact)**

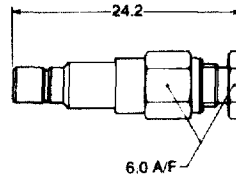

Cable Group ①	Body Plating	Contact Plating	Part Number	
			SMB	SMC
073	Gold	Gold	B65 E06 G073 X99	C65 E06 G073 X99
073	Bright Nickel	Gold	B65 E06 J073 X99	C65 E06 J073 X99
285	Gold	Gold	B65 E06 G285 X99	C65 E06 G285 X99
285	Bright Nickel	Gold	B65 E06 J285 X99	C65 E06 J285 X99

**Straight bulkhead jack
solder center contact
clamp outer
(male center contact)**

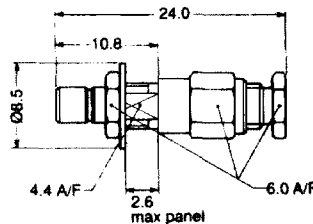

Cable Group ①	Body Plating	Contact Plating	Part Number	
			SMB	SMC
073	Gold	Gold	B65 H05 G073 X99	C65 H05 G073 X99
073	Bright Nickel	Gold	B65 H05 J073 X99	C65 H05 J073 X99
285	Gold	Gold	B65 H05 G285 X99	C65 H05 G285 X99
285	Bright Nickel	Gold	B65 H05 J285 X99	C65 H05 J285 X99

① For cable group to cable type cross reference refer to page 200.

All diagrams are for SMB versions.

All dimensions are nominal.

For 75 ohm versions see page 157 to 167, or contact our sales office for uncataloged requirements.

All measurements are in millimeters unless otherwise specified.

M/A-COM, Inc.

North America: Tel. (800) 366-2266
Fax (800) 618-8883

Asia/Pacific: Tel. +85 2 2111 8088
Fax +85 2 2111 8087

Europe: Tel. +44 (1344) 869 595
Fax +44 (1344) 300 020

SMB/SMC Series

P.C.B. PLUGS/50 OHM

Straight (female center contact)

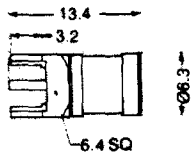

mounting detail

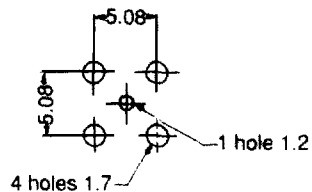

Body Plating	Contact Plating	Part Number	
		SMB	SMC
Gold	Gold	B65 N25 G999 X99	C65 N25 G999 X99
Bright Nickel	Gold	B65 N25 J999 X99	C65 N25 J999 X99

Straight (U.T.E.) (female center contact)

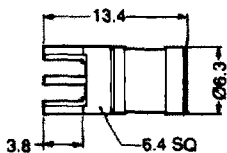

mounting detail

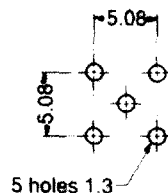

Body Plating	Contact Plating	Part Number	
		SMB	SMC
Gold	Gold	B65 N26 G999 X99	C65 N26 G999 X99
Bright Nickel	Gold	B65 N26 J999 X99	C65 N26 J999 X99

Connector designated U.T.E conform to the relevant Union Technique de L'Electricite specification

All diagrams are for SMB versions.

All dimensions are nominal.

For 75 ohm versions see page 157 to 167, or contact our sales office for uncataloged requirements.

All measurements are in millimeters unless otherwise specified.

M/A-COM, Inc.

North America: Tel. (800) 366-2266 ■ Asia/Pacific: Tel. +85 2 2111 8088 ■ Europe: Tel. +44 (1344) 869 595
 Fax (800) 618-8883 Fax +85 2 2111 8087 Fax +44 (1344) 300 020

SMB/SMC Series

P.C.B. PLUGS/50 OHM

Elbow (female center contact)

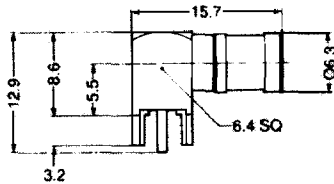

mounting detail

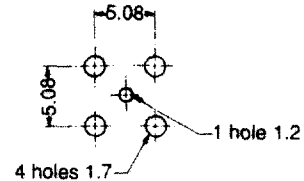

Body Plating	Contact Plating	Part Number	
		SMB	SMC
Gold	Gold	B65 N11 G999 X99	C65 N11 G999 X99
Bright Nickel	Gold	B65 N11 J999 X99	C65 N11 J999 X99

Elbow (U.T.E.) (female center contact)

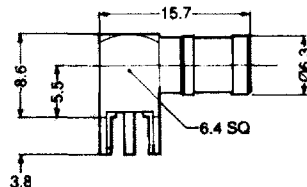

mounting detail

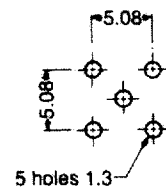

Body Plating	Contact Plating	Part Number	
		SMB	SMC
Gold	Gold	B65 N31 G999 X99	C65 N31 G999 X99
Bright Nickel	Gold	B65 N31 J999 X99	C65 N31 J999 X99

Connector designated U.T.E conform to the relevant Union Technique de L'Electricite specification.

All diagrams are for SMB versions.

All dimensions are nominal.

For 75 ohm versions see page 157 to 167, or contact our sales office for uncataloged requirements.

All measurements are in millimeters unless otherwise specified.

M/A-COM, Inc.

North America: Tel. (800) 366-2266
Fax (800) 618-8883

Asia/Pacific: Tel. +85 2 2111 8088
Fax +85 2 2111 8087

Europe: Tel. +44 (1344) 869 595
Fax +44 (1344) 300 020

SMB/SMC Series

P.C.B. SOCKETS/50 OHM

Straight (male center contact)

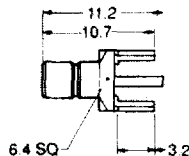

mounting detail

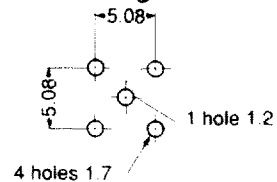

Body Plating	Contact Plating	Part Number	
		SMB	SMC
Gold	Gold	B65 N07 G999 X99	C65 N07 G999 X99
Bright Nickel	Gold	B65 N07 J999 X99	C65 N07 J999 X99

Straight (U.T.E.) (male center contact)

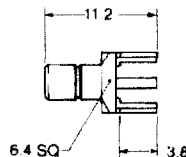

mounting detail

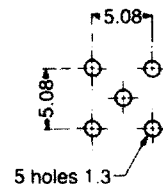

Body Plating	Contact Plating	Part Number	
		SMB	SMC
Gold	Gold	B65 N27 G999 X99	C65 N27 G999 X99
Bright Nickel	Gold	B65 N27 J999 X99	C65 N27 J999 X99

Connector designated U.T.E. conform to the relevant Union Technique de L'Electricite specification.

All diagrams are for SMB versions.

All dimensions are nominal.

For 75 ohm versions see page 157 to 167, or contact our sales office for uncataloged requirements.

All measurements are in millimeters unless otherwise specified.

M/A-COM, Inc.

North America: Tel. (800) 366-2266
Fax (800) 618-8883

Asia/Pacific: Tel. +85 2 2111 8088
Fax +85 2 2111 8087

Europe: Tel. +44 (1344) 869 595
Fax +44 (1344) 300 020

SMB/SMC Series

P.C.B. SOCKETS/50 OHM

Elbow (male center contact)

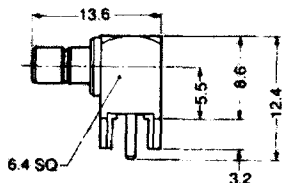

mounting detail

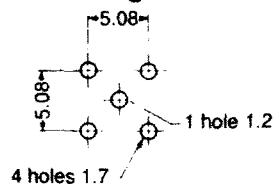

Body Plating	Contact Plating	Part Number	
		SMB	SMC
Gold	Gold	B65 N10 G999 X99	C65 N10 G999 X99
Bright Nickel	Gold	B65 N10 J999 X99	C65 N10 J999 X99

Elbow (U.T.E.) (male center contact)

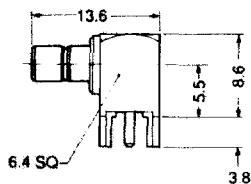

mounting detail

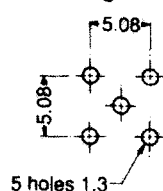

Body Plating	Contact Plating	Part Number	
		SMB	SMC
Gold	Gold	B65 N30 G999 X99	C65 N30 G999 X99
Bright Nickel	Gold	B65 N30 J999 X99	C65 N30 J999 X99

Connector designated U.T.E. conform to the relevant Union Technique de Electricite specification.

All diagrams are for SMB versions.

All dimensions are nominal.

For 75 ohm versions see page 157 to 167, or contact our sales office for uncataloged requirements.

All measurements are in millimeters unless otherwise specified.

M/A-COM, Inc.

North America: Tel. (800) 366-2266 ■ Asia/Pacific: Tel. +85 2 2111 8088 ■ Europe: Tel. +44 (1344) 869 595
 Fax (800) 618-8883 Fax +85 2 2111 8087 Fax +44 (1344) 300 020