

PRODUCT DATA DRAWING

REVISION HISTORY			
REV	DESCRIPTION	DATE	APPROVED
01	PRELIMINARY		STW
-	REL. NRN 36796	05/23/11	STW

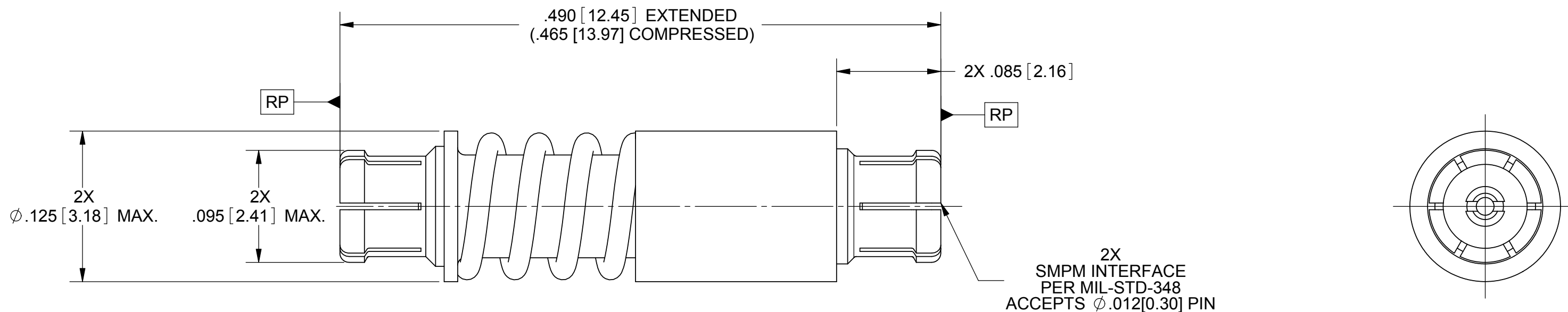

MATERIALS:
BODIES & CONTACTS: BERYLLIUM COPPER PER ASTM B196, ALLOY No. UNS C17300, TD04.
INSULATORS: PTFE PER ASTM D1710.
SPRING: STAINLESS STEEL PER ASTM A313, ALLOY S30200.

FINISHES:
BODIES & CONTACTS: GOLD PER ASTM B488, TYPE II GRADE C, CLASS 1.27, OVER NICKEL PER AMS-QQ-N-290, .000050" MINIMUM.
SPRING: PASSIVATED PER ASTM A967

ELECTRICAL:
IMPEDANCE: 50 OHMS.
FREQ. RANGE: DC TO 22 GHZ.
VSWR: 1.25:1 MAXIMUM, DC TO 22 GHZ.
INSERTION LOSS: 0.25dB MAXIMUM, DC TO 22 GHZ.
D.W.V.: 325 VRMS.
INSULATION RES.: 5,000 MEGOHMS MINIMUM.
CORONA LEVEL: 100 VRMS @70000 FEET

SPRING FORCE: 1.6 LBS PRELOAD.
SPRING RATE: 4.0 MAX. COMPRESSED.
AXIAL COMPRESSION: .025 NOMINAL.

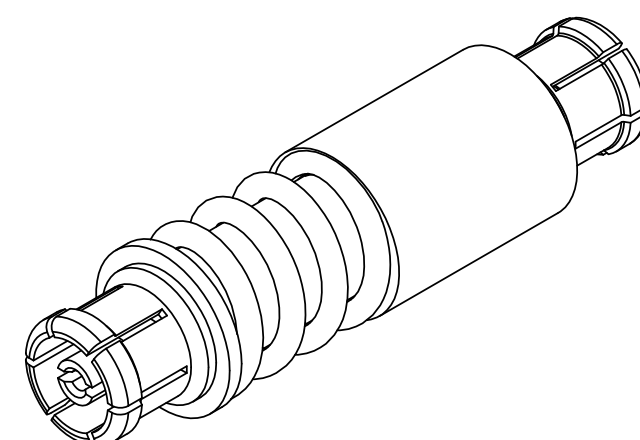

MATERIAL: SEE NOTES	DIMENSIONS ARE IN INCHES TOLERANCES: FRACTIONAL: ±1/64 ANGULAR: X° ±1'0" X"X' ±15'	UNLESS OTHERWISE SPECIFIED 1) ALL DIMENSIONS ARE IN INCHES (MILLIMETERS) 2) ALL DIMENSIONS ARE AFTER PLATING. 3) BREAK CORNERS & EDGES .005 R. MAX. 4) CHAM. 1ST & LAST THREADS. 5) SURFACE ROUGHNESS 63-MIL-STD-10. 6) DIA. 'S ON COMMON CENTERS TO BE CONCENTRIC WITHIN .005 T.I.R. 7) REMOVE ALL BURRS	SV Microwave, Inc. 2400 Centrepark West Drive, Suite 100 West Palm Beach, FL 33409
FINISH: SEE NOTES	DECIMAL: X ±.030 .XX ±.010 .XXX ±.005	INTERPRET DIMENSIONS AND TOLERANCES PER ASME Y14.5M - 1994	TITLE: ADAPTOR SMPM FEMALE TO FEMALE
SURFACE AREA: N/A	THIRD ANGLE PROJECTION	DRAWN: JMC 02/15/11	SIZE: B CAGE CODE: 95077 DWG. NO. 1132-4015
PROPRIETARY THE INFORMATION CONTAINED IN THIS DRAWING IS THE SOLE PROPERTY OF SV MICROWAVE, INC. ANY REPRODUCTION IN PART OR AS A WHOLE WITHOUT THE WRITTEN PERMISSION OF SV MICROWAVE, INC IS PROHIBITED.		CHECKED: STW 02/15/11 APPROVED: STW 02/15/11	SCALE: 12:1 SHEET 1 OF 1