

EXTERNAL DESKTOP POWER SUPPLY 12VDC 30WATT

POWERPAX: SW3473G

Features:

- Universal Input
- IEC-320-C8 Input Connector
- 3 Year Warranty
- Efficiency Level VI



Description:

Our Range of 30 watt AC/DC switch mode power supplies provide 30 watts of continuous output power in a high quality compact enclosure suitable for many general power applications.

Specification	
Part Code	SW3473G
Input Voltage Range	100 → 240Vac
Input Frequency Range	50/60Hz +/-3Hz
Input Connector	IEC 320-C8
Input Current Rated	1.0A max.
Inrush Current	Shall be limited to 100A max
Leakage Current	<0.25mA
Efficiency	86.95% Min
Power Consumption	Max. 0.1W
Output Voltage Rating	12 VDC
Output Current Range	2.5A
Total Power	30W
Output Connection Type	2.5x5.5x12mm centre positive — Right Angle
Over Voltage Protection	18V Max.
Over Current Protection	The power supply will be protection when output power at 110-200% of all rated dc output
Short Circuit Protection	No Damage
Ripple Voltage	150 mV Max.
Hi-Pot	3000 Vac 10mA 1 min
Safety Approved	EN62368-1, BS EN62368-1
EMC Standard	BS EN55032 BS EN55035 BS EN IEC 61000-3-2 BS EN 61000-3-3
Operating Temperature Range	0°C → +40°C
Storage Temperature	-20°C → +85°C
Operating Humidity	10% to 95%
Storage Humidity	10% to 95%
Dimensions	110.8 (L) x 48 (W) x 33.6 (H) mm
Product Weight	200g
MTBF	50K Hrs.
Regulator Type	Switched Mode Power Supply

General Note

TT Electronics reserves the right to make changes in product specification without notice or liability. All information is subject to TT Electronics' own data and is considered accurate at time of going to print.

POWERPAX

TT Electronics IoT Solutions Ltd
Tofts Farm East, Brenda Road, Hartlepool, TS25 2BQ, UK
t: +44 (0) 1429 852 500

EXTERNAL DESKTOP POWER SUPPLY 12VDC 30WATT

POWERPAX: SW3473G

Diagrams

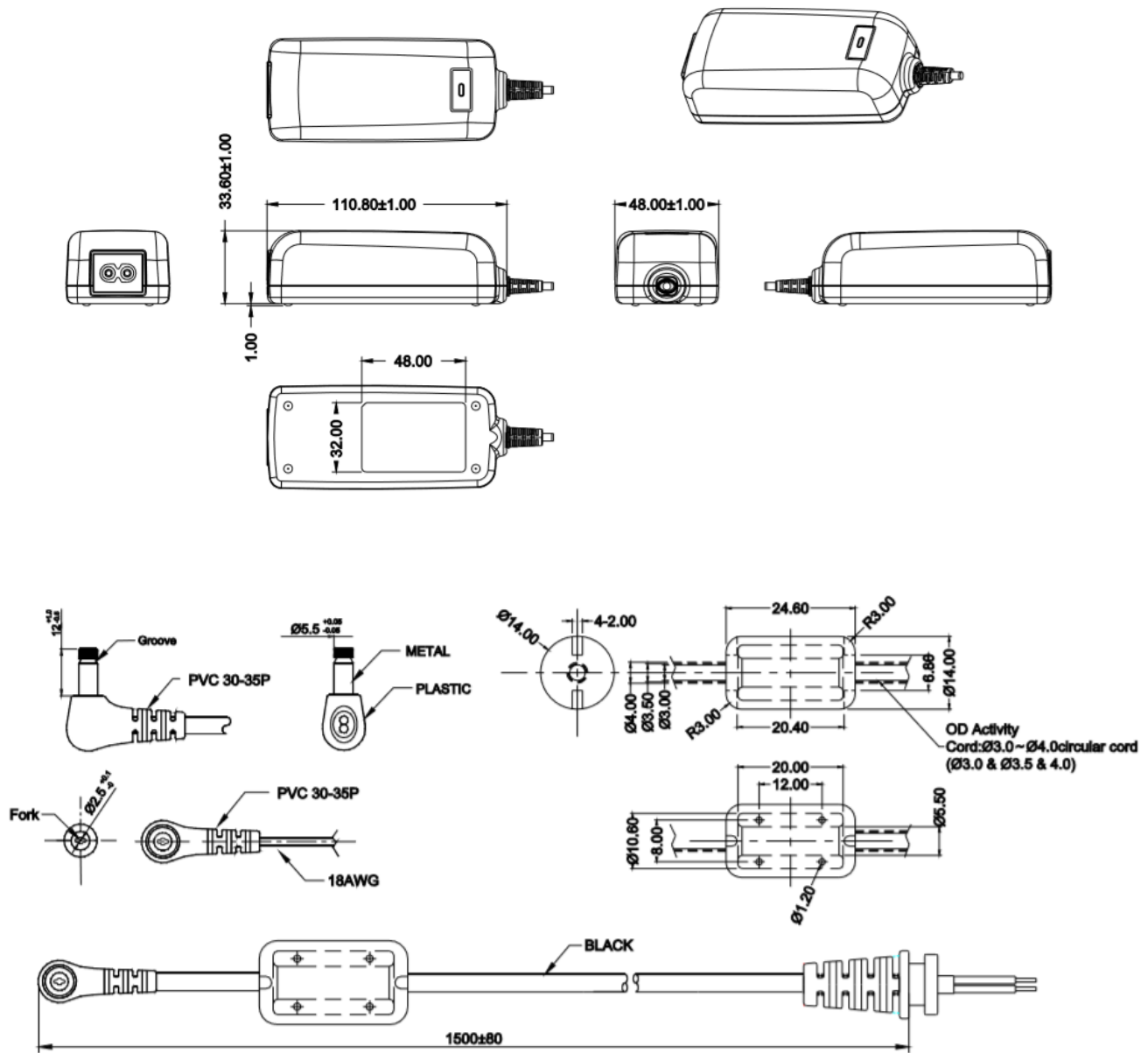

General Note
 TT Electronics reserves the right to make changes in product specification without notice or liability. All information is subject to TT Electronics' own data and is considered accurate at time of going to print.