

**小形ジャック (φ2.5, プリント基板用)**  
**Miniature Jacks (2.5 DIA, P.C. Board Terminals)**

UNIT: mm

**h=2 mm**

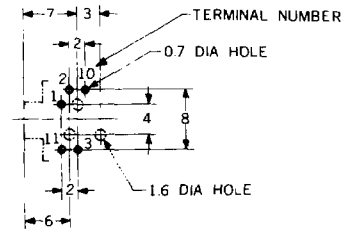
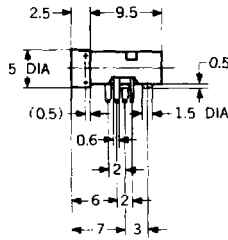
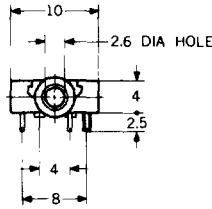

**HOLE LAYOUT**  
(BOTTOM VIEW)

**HSJ1102-01-510**

|           |           |                |                |                |                |                |
|-----------|-----------|----------------|----------------|----------------|----------------|----------------|
| Schematic |           |                |                |                |                |                |
|           | Model No. | HSJ1102-01-510 | HSJ1102-01-520 | HSJ1102-01-530 | HSJ1102-01-540 | HSJ1102-01-550 |

— 体積比約 50% (HSJ0861 比) の小形、薄形タイプ—  
 超薄形、小形で回路構成はフルチョイスが可能です。ボディを上げ底構成とし、フラックス流入防止の向上と密閉化を計っています。

— Small thin type, about 50% in volume  
 (compared with HSJ0861) —  
 It is extra-thin and compact, and allows full choice of circuit configuration. The housing is a raised bottom structure so that flux inflow can be effectively prevented.

**h=2.5 mm**

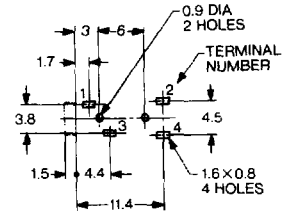
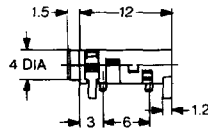
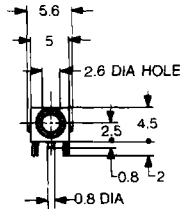

**HOLE LAYOUT**  
(BOTTOM VIEW)

**HSJ1650-010040**

|           |                |                |
|-----------|----------------|----------------|
| Schematic |                |                |
|           | Housing Color  | Black          |
| Model No. | HSJ1650-010020 | HSJ1650-010040 |

**h=2.5 mm**

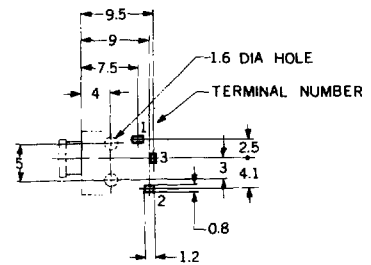
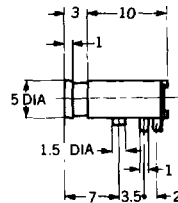
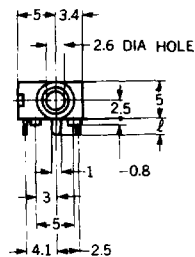

**HOLE LAYOUT**  
(BOTTOM VIEW)

**HSJ0838-01-010**

|             |                |
|-------------|----------------|
| Schematic   |                |
|             | Model No.      |
| Height (mm) | 1.8            |
| Model No.   | HSJ0838-01-500 |

**小形ジャック (φ2.5, プリント基板用)**  
**Miniature Jacks (2.5 DIA, P.C. Board Terminals)**

UNIT: mm

$h=2.5$  mm

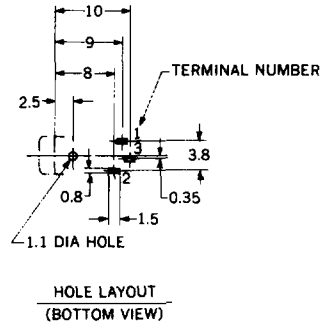
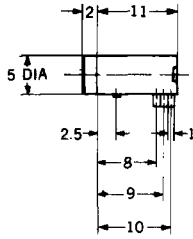
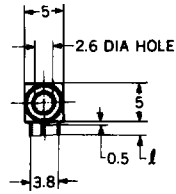

**HSJ1080-01-010**

|           |                |
|-----------|----------------|
| Schematic |                |
| $l$ (mm)  |                |
| 1.8       | HSJ1080-01-010 |
| 2.5       | HSJ1080-01-110 |

$h=2.5$  mm

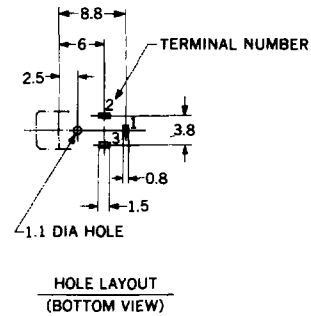
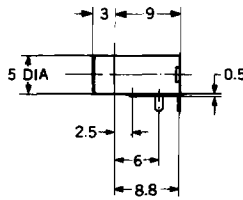
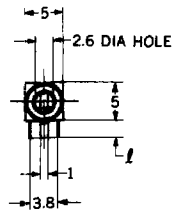

**HSJ1122-010010**

|           |                |
|-----------|----------------|
| Schematic |                |
| $l$ (mm)  |                |
| 1.8       | HSJ1122-010010 |
| 2.3       | HSJ1122-010110 |

$h=2.5$  mm

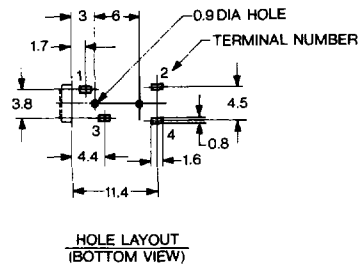
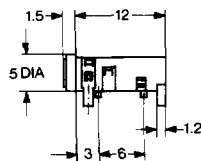
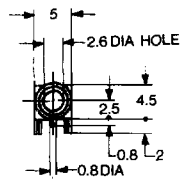

**HSJ1550-010010**

|           |                |
|-----------|----------------|
| Schematic |                |
| Model No. | HSJ1550-010010 |

**小形ジャック (φ2.5, プリント基板用)**  
**Miniature Jacks (2.5 DIA, P.C. Board Terminals)**

UNIT: mm

**h=5 mm**

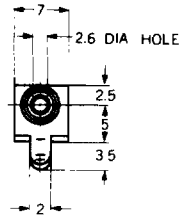

WITH OR WITHOUT THREAD

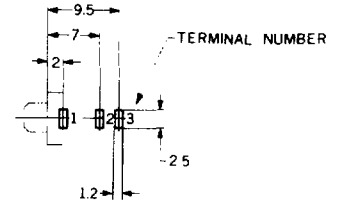
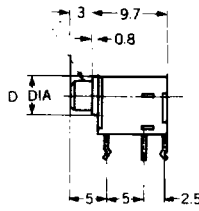

HOLE LAYOUT  
(BOTTOM VIEW)

**HSJ0789-01-020**

|                   |        |                |
|-------------------|--------|----------------|
| Schematic         |        |                |
| Flange D DIA (mm) | Sleeve |                |
| 5                 | M4-0.5 | HSJ0789-01-010 |
| 5                 | 4 DIA  | HSJ0789-01-020 |
| 6                 | M4-0.5 | HSJ0789-01-030 |

**h=5.5 mm**

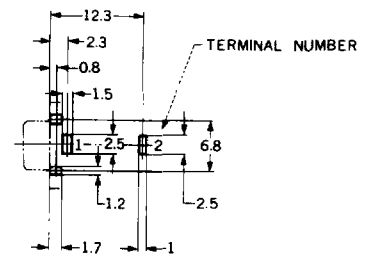
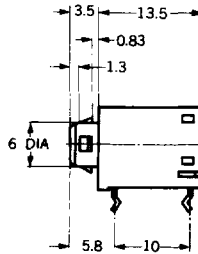
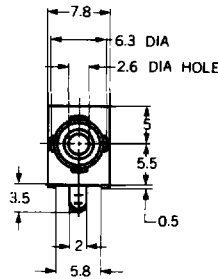

HOLE LAYOUT  
(BOTTOM VIEW)

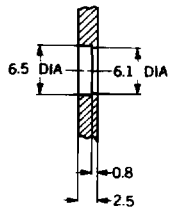

MOUNTING HOLE

**HSJ0803-01-010**

|           |                |
|-----------|----------------|
| Schematic |                |
| Model No. | HSJ0803-01-010 |

**小形ジャック (φ2.5, プリント基板用)**  
**Miniature Jacks (2.5 DIA, P.C. Board Terminals)**

UNIT: mm

**h=6.5 mm**

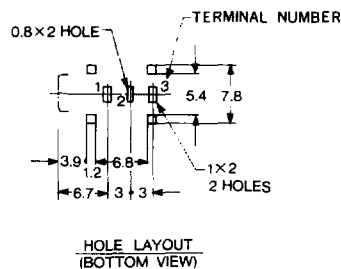
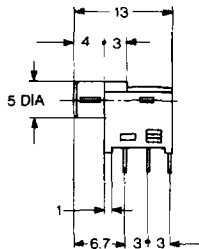
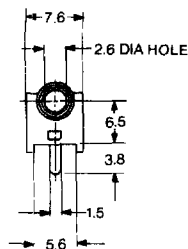

**HSJ1462-01-010**

|           |                |
|-----------|----------------|
| Schematic |                |
| Model No. | HSJ1462-01-010 |

**h=6.5 mm**

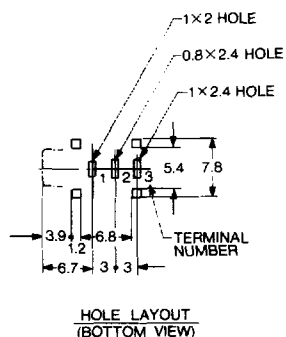
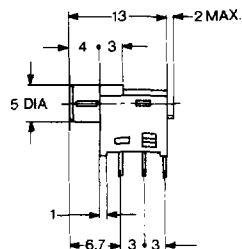
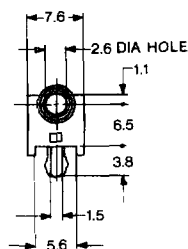

**HSJ1492-01-010**

|           |                |
|-----------|----------------|
| Schematic |                |
| Model No. | HSJ1492-01-010 |

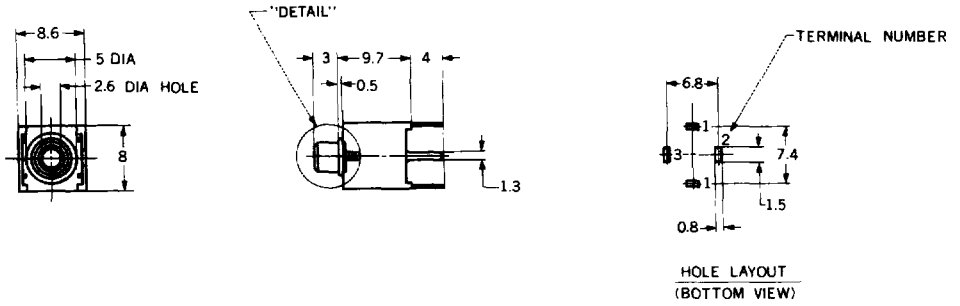
$\ell = 12.7 \text{ mm}$ 

**HSJ0798-01-010**

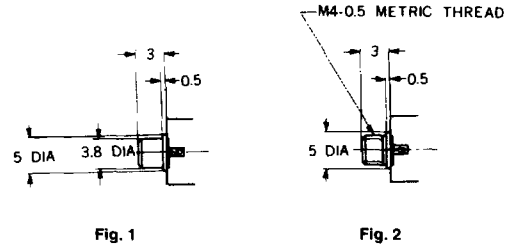
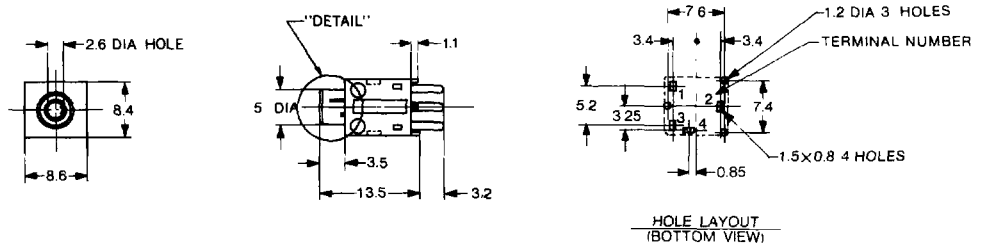
|           |                |
|-----------|----------------|
| Schematic |                |
| Sleeve    |                |
| Fig. 1    | HSJ0798-01-010 |
| Fig. 2    | HSJ0798-01-020 |

 $\ell = 13.5 \text{ mm}$ 

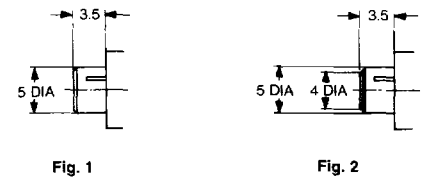
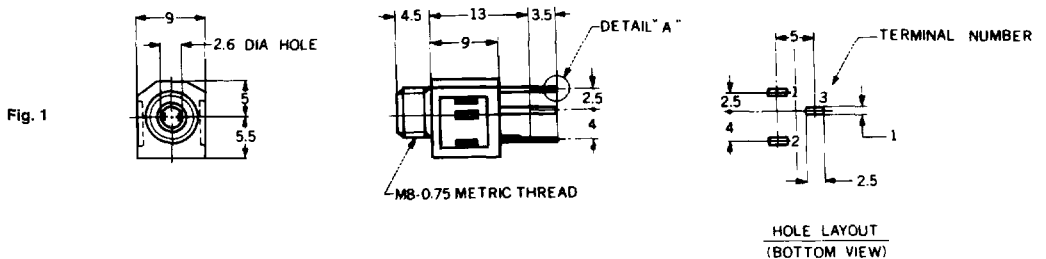
**HSJ1552-010020**

|                |                               |                                  |                                  |
|----------------|-------------------------------|----------------------------------|----------------------------------|
| スリーブ<br>Sleeve | ボディ<br>色調<br>Housing<br>Color |                                  |                                  |
| Fig. 1         | Black<br>Blue                 | HSJ1552-010010<br>HSJ1552-010018 | HSJ1552-010020                   |
| Fig. 2         | Black<br>Blue                 |                                  | HSJ1553-010610<br>HSJ1553-010618 |

 $\ell = 17.5 \text{ mm}$ 

**HSJ0834-01-010**

 リード配線も可能です。  
Available Lead Wire Terminals.

|           |                |
|-----------|----------------|
| Schematic |                |
| Housing   |                |
| Fig. 1    | HSJ0834-01-010 |
| Fig. 2    | HSJ1516-010010 |

