

CRIMP CONNECTOR

● Socket terminal

Part No.	Applicable Electrical Wire Size(AWG)	Electrical Wire Sheath Dia.(mm)	Material	Plating	No. of Terminal/Reel
W-T5301-11#01	14~20	$\phi 3.6 \sim 1.7$	Brass	Tinned	3000
W-T5302-11#01	18~24	$\phi 3.0 \sim 1.0$		(Rellow Treatment)	4000

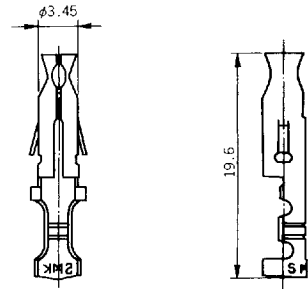

● Socket Housing

No. of Pins	Part No.	A	B	C	D
2	W-E3102-IN#01	6.5	13.3	—	6.8
4	W-E3104-IN#01	19.5	26.3	—	6.8
6	W-E3106-IN#01	13.0	20.5	6.5	14.0
9	W-E3109-IN#01	13.0	20.5	13.0	20.5
12	W-E3112-IN#01	19.5	27.0	13.0	20.5
15	W-E3115-IN#01	26.0	33.5	13.0	20.5

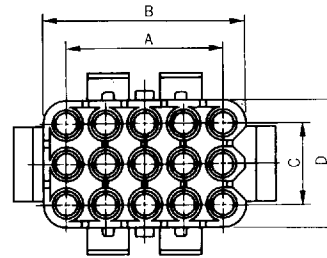

■ Material

- Housing: Polyamide (Natural color) 94V-2

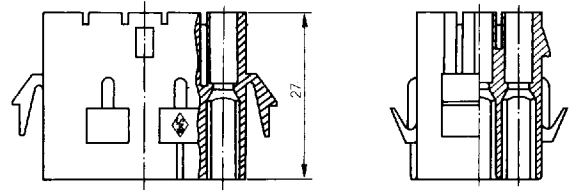

● Plug Terminal

Part No.	Applicable Electrical Wire Size(AWG)	Electrical Wire Sheath Dia.(mm)	Material	Plating	No. of Terminal/Reel
W-T0301-11#01	14~20	$\phi 3.6 \sim \phi 1.7$	Brass	Tinned	3000
W-T0302-11#01	18~24	$\phi 3.0 \sim \phi 1.0$		(Rellow Treatment)	4000

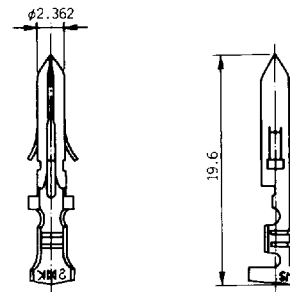

● Plug Housing

No. of Pins	Part No.	A	B	C	D
2	W-E3002-IN#01	6.5	15.9	—	9.4
4	W-E3004-IN#01	19.5	28.9	—	9.4
6	W-E3006-IN#01	13.0	23.1	6.5	16.6
9	W-E3009-IN#01	13.0	23.1	13.0	23.1
12	W-E3012-IN#01	19.5	29.6	13.0	23.1
15	W-E3015-IN#01	26.0	37.7	13.0	24.7

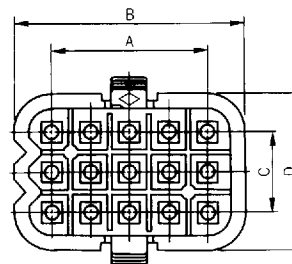

■ Material

- Housing: Polyamide (Natural color) 94V-2

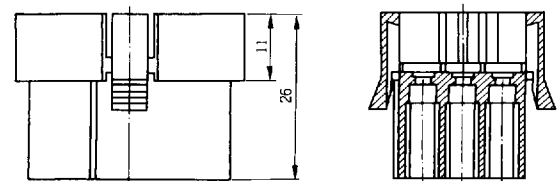

CRIMP CONNECTOR

PL Series 6.5mm Spacing

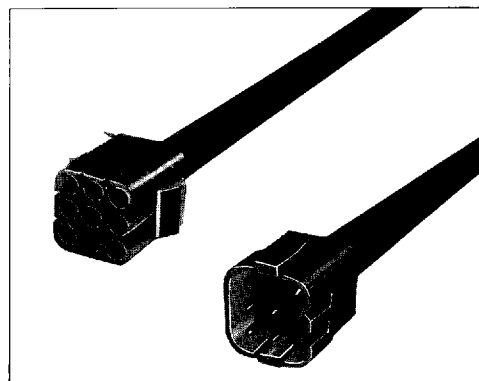

Features

1. PL series connectors are crimp connectors which can be used for both relay between leads or mounting on panels.
2. The socket terminal is multi-polar type which enables easy insertion.
3. A housing lock is incorporated in the PL series to improve connection reliability.

Specifications

1. Rating: 7A 250V AC/DC
2. Contact Resistance: 10mΩ max.
3. Insulation Resistance: 1000MΩ min. at 500V DC
4. Breakdown Voltage: 1000V AC for one minute
5. Operating Temperature: -25°C to +85°C
6. Applicable Wire Size: AWG14 to 24 (Sheath dia. ϕ 3.6 to ϕ 1.0mm)
7. Applicable PC Board Thickness: 0.8mm to 1.6mm

NOTE

1. Consult with our company for requisitioning the 94V-0 type.
2. Contact the our company for the Safety Standards.

Connection Diagram

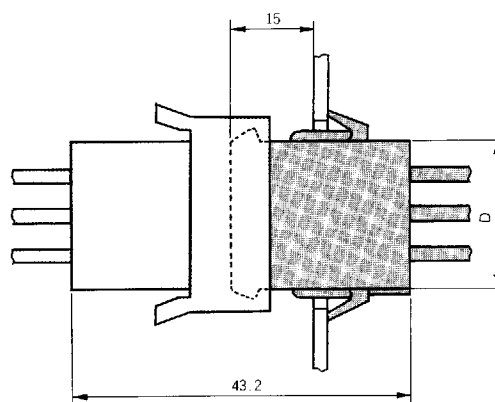

No. of Pins	D
2	6.8
4	6.8
6	14.0
9	20.5
12	20.5
15	20.5

Diagram for Panel Mount Holes

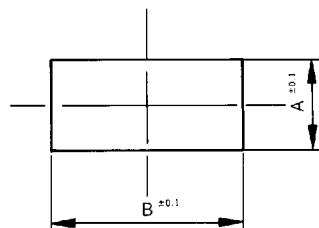

No. of Pins	Part No.	A	B
2	W-E3102-IN#01	10.1	20.2
4	W-E3104-IN#01	10.1	33.2
6	W-E3106-IN#01	17.3	27.2
9	W-E3109-IN#01	23.8	27.2
12	W-E3112-IN#01	23.8	33.7
15	W-E3115-IN#01	23.8	40.2

Structural Configuration Diagram

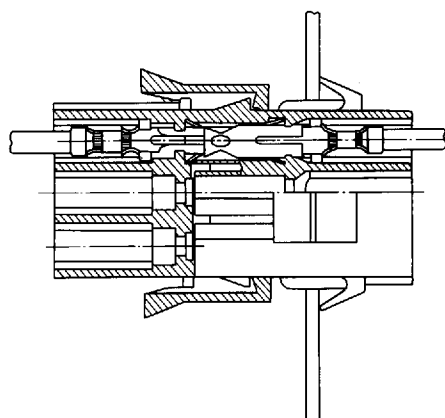

CRIMP CONNECTOR