

**Part Number: CW1620 Series**  
**Vibration Sensor**  
**Product Data Sheet**

**PICTURE**

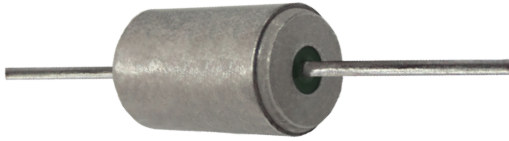

**FEATURES**

- Resistant to Ambient Environmental Conditions
- Case Material : Tin Plated
- Customization Available
- Hermetically Sealed & Inert Gas Filled
- Single Pole, Double Throw
- Can be used as a Tilt switch

✓ **RoHS Compliant**

**OPERATION**

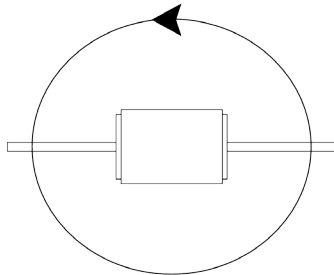

SWITCH MAY BE ON OR OFF IN ANY POSITION. WILL EXHIBIT CHANGE OF STATE UPON MOVEMENT.

**GENERAL SPECIFICATIONS**

Contact Voltage	60 VOLTS MAX
Contact Current	0.1 A MAX
Contact Capacity	3 VA MAX
Contact Resistance	400 Ohms MAX Measured at 45° Below Horizontal at 5 VDC
Operating Temperature Range	-37° +100°C
Storage Temperature Range	-40° +125°C

**DIMENSIONS**

Click drawings for more information.

**Part Number: CW1620-0**

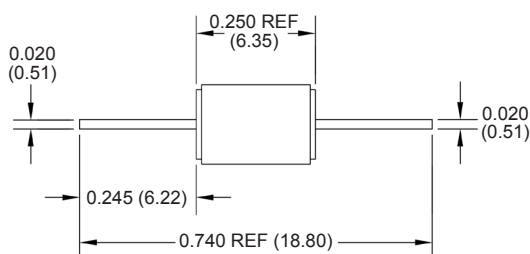

**Part Number: CW1620-3**

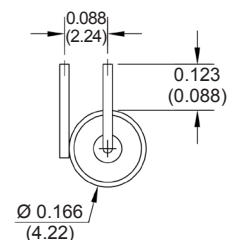
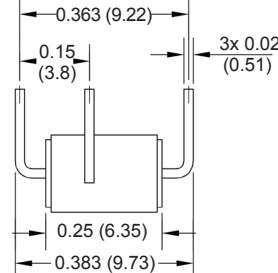

Drawings not to scale. All dimensions in inches (mm) nominal.

As part of the company policy of continued product improvement, specifications may change without notice. Our sales office will be pleased to help you with the latest information on this product range and the details of our full design and manufacturing service. All products are supplied to our standard conditions of sale unless otherwise agreed in writing.

**Phone: (1) 973 777 6900**

**www.comus-intl.com**

**Fax: (1) 973 777 8405**

Belgium: + 32 (0)12 390400 - Comus Europe Ltd (Assembletech) UK: +44 (0) 1255 862236 - Germany: +49 (0)911 923 15 943 - Netherlands: +31(0)45 54 39 345 - India: +(91) (44) 43219090  
©2014 Copyright Comus International, 454 Allwood Road, Clifton NJ 07012, USA

An ISO 9001 Certified Company