

SPECIFICATION CONTROL DRAWING

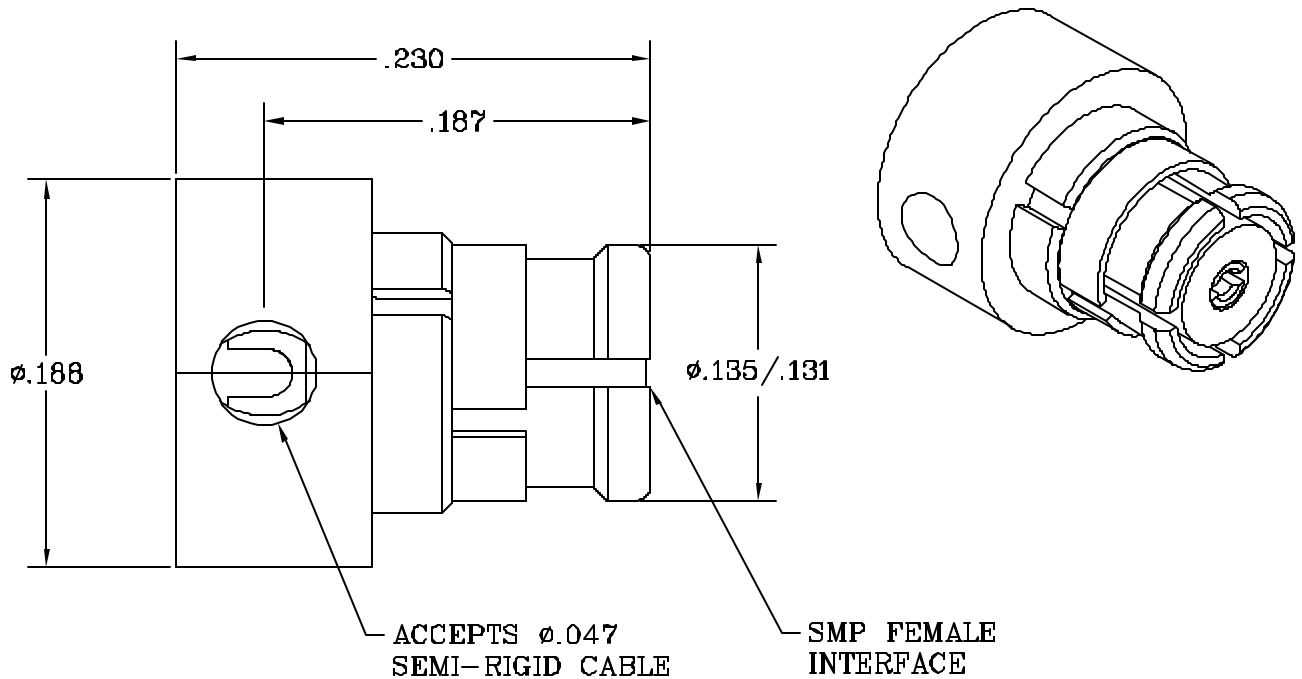

1. MATING INTERFACE DIMENSIONS PER MIL-STD-348 Fig. 326.1a AND DYNAWAVE SPECIFICATION MD-20

2. ELECTRICAL

FREQUENCY RANGE GHz	_____	DC TO 12.5 GHz.
VSWR (MAX.) *	_____	1.35
INSERTION LOSS (dB MAX.)*	_____	.12 dB x $\sqrt{\text{FGHz}}$.
NOMINAL IMPEDANCE (OHMS)	_____	50
VOLTAGE RATING (MAX. VRMS)	_____	170
RF LEAKAGE (MIN. dB DOWN)	_____	65 dB
TEMPERATURE RATING (DEGREES CENTIGRADE)	_____	-65° c TO + 165° c
DIELECTRIC WITHESTANDING VOLTAGE (MAX. VRMS)	_____	375
INSULATION RESISTANCE (MIN. MEGOHMS)	_____	5,000
CONTACT RESISTANCE		
• CENTER CONTACT (MAX. MILLIOHMS)	_____	6.0
• OUTER CONTACT (MAX. MILLIOHMS)	_____	2.0

* TERMINATED IN A 50 OHM LOAD

REV.	DCN NO.	DATE	APP.	DIMENSIONS ARE IN INCHES TOLERANCES			INCORPORATED GEORGETOWN MA. 01633	
AA	03-2059	8/22/03	DC	DECIMALS	FRACTIONAL	ANGULAR		
AB	04-1209	2/18/04	DC	X ± .030 XX ± .010 XXX ± .005	± 1/64	X° ± 1' 0" X° X' ± 15'		
				DRAWN	BN	DATE	6/21/03	TITLE SMP FEMALE RIGHT ANGLE, DIRECT SOLDER TO .047 S.R. CABLE
				APPROVED	DC	DATE	8/22/03	
				CODE IDENT.	SHEET 1 OF 2		DWG. NO.	2001-4720-5425
				2J899				

SPECIFICATION CONTROL DRAWING

3. MECHANICAL

CAPTIVATION-CENTER CONTACT

- MIN. AXIAL FORCE _____ 1.5 LBS.
- MIN. RADIAL TORQUE _____ N/A

CONNECTOR ENGAGEMENT FORCES

- INSERTION (MAX. LBS.) _____ 15.0*
 - WITHDRAWAL (MIN. LBS.) _____ 5.0*
- CONNECTOR DURABILITY (MIN. CYCLES) _____ 100*

*FULL DETENT SHROUD

4. ENVIRONMENTAL

- TEMPERATURE CYCLING _____ MIL-STD-202, METHOD 102, COND. C (-65 ° c TO + 165 ° c)
- SHOCK _____ MIL-STD-202, METHOD 213, COND. I (100 G's)
- VIBRATION _____ MIL-STD-202, METHOD 204, COND. D (20 G's)
- MOISTURE RESISTANCE _____ MIL-STD-202, METHOD 106, LESS STEP 7b
- CORROSION _____ MIL-STD-202, METHOD 101, COND. B (48 HOURS)
- BAROMETRIC PRESSURE (ALTITUDE) _____ MIL-STD-202, METHOD 106, COND. C (70,000 FT.) (95 VRMS)

5. MATERIAL

- CONNECTOR BODY, CENTER CONTACT, _____ BERYLLIUM COPPER PER ASTM B 196, COPPER ALLOY UNS C17300.
ANTI-ROCK RING AND EMI RING
- INSULATOR _____ TEFLON PER ASTM D 4894-91
- CAP _____ BRASS PER ASTM B16, TEMPER H02, ALLOY C38000

6. FINISH

- CONNECTOR BODY, CENTER CONTACT, _____ GOLD PER ASTM B488 TYPE II, GRADE C, CLASS 1 (.000050 MIN.)
ANTI-ROCK RING, EMI RING AND CAP _____ OVER NICKEL PER QQ-N-290 CLASS 1 (.00015 MIN.)
- INSULATOR _____ N/A



SHEET 2 OF 2

DWG.
NO.

2001-4720-5425

REV.

AB