

DASH NO.	M CODE	MADE FROM
----------	--------	-----------

GSD

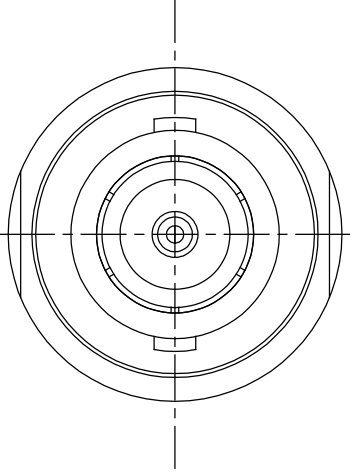
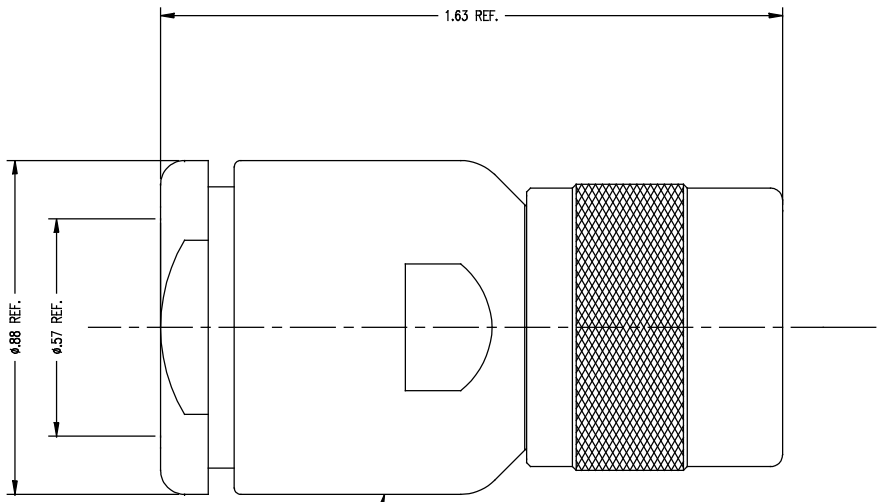

STAMP: 91836 M39012/06-0003
KINGS KD-59-133
YRWK (DATE CODE)

- NOTES:
- FOR USE WITH RG-14 & 217/U CABLE GROUPS.
 - FOR CABLING INSTRUCTIONS SEE CP-1040.
 - MATERIALS:
GASKETS: SILICON RUBBER
INSULATOR AND WASHER: TEFLON
SPRING WASHERS AND OUTER CONTACT: BER. COP.
ALL OTHER METAL PARTS: BRASS
 - FINISHES:
ALL METAL PARTS: SILVER PLATED
 - ELECTRICAL CHARACTERISTICS:
NOMINAL IMPEDANCE: 50 OHMS
WORKING VOLTAGE: 1000 VRMS
FREQUENCY RANGE: DC TO 11 GHz

M39012/06-0003

REVISIONS	
ISSUE	CHANGES
0	ER 6956 02/03/69
1	CN 8543 A CRS 05/08/70
2	CN 12564 A JGL 08/07/73
3	CN 15080 A JL 01/09/76
4	CN 23168 E GJG 03/24/82
5	CN 32263 A LNM 06/07/90
6	CN 38686 C BDH 10/10/02

SCALE	3:1	
APPROX SURFACE AREA	KD-59-133	
USED ON		
REF:		
C PLUG		
DRAWN	HFE	DATE 09/06/68
DESIGN		DATE
APPR.	LJ	DATE 02/11/69
 ROCK HILL, SOUTH CAROLINA 29730		

GSD

M39012/06-0003