

DO NOT SCALE FROM THIS PRINT

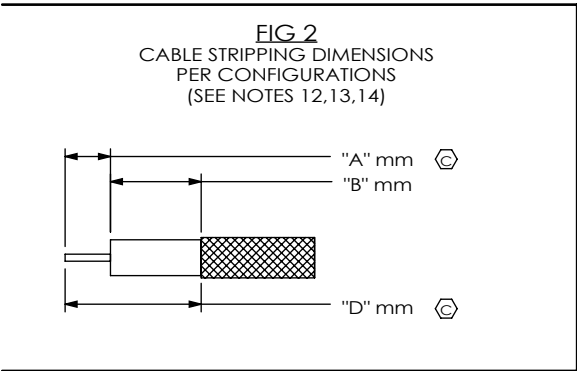

STYLE	CABLE CUT LENGTH		HI POT
	SUBTRACTOR	DCV	
-01SPX	5.8 [0.23]	1000	
-01RPX	3.1 [0.12]	1000	
*-92SJX	8.4 [0.33]	1000	
*-92SPX	9.1 [0.36]	1000	
-SING	0.0 [0.00]	1000	
XXXX	0.0 [0.00]	1000	

LENGTH	TOLERANCE
0100-0200 [3.92-7.87]	+3.0 [.12]/-0.0 [.00]
0200-0500 [7.87-19.69]	+5.0 [.20]/-0.0 [.00]
0500-1100 [19.69-43.30]	+10.0 [.40]/-0.0 [.00]
>1100 [43.30]	± 1%

NOTES:

- ⊕ REPRESENTS A CRITICAL DIMENSION.
- CABLE CUT LENGTH:
= (LENGTH: XXXX) - (SUBTRACTOR FOR END 1) - (SUBTRACTOR FOR END 2).
(SEE TABLE 1 FOR SUBTRACTORS)
- ASSEMBLY TO BE 100% TESTED FOR OPENS & SHORTS.
- ASSEMBLY TO BE 100% HI-POT TESTED PER TABLE 1, THE TEST VOLTAGE FOR THE ASSEMBLY SHOULD BE SET TO THE END OPTION WITH THE LOWEST TEST VOLTAGE RATING.
- AFTER FINAL ELECTRICAL TESTS, LABEL EACH CABLE ASSEMBLY WITH 1 LABEL -ET.
- CRITICALS ON CONNECTOR PRINTS TO BE CHECKED IN PROCESS.
- FINISHED ASSEMBLIES TO BE PACKAGED PER PACKAGING STANDARD CO-RF-WI-3040-M. ASSEMBLIES WITH LOCKWASHERS, NUTS, AND GASKETS TO BE SHIPPED KITTED AS ONE ASSEMBLY PER BAG, UNASSEMBLED.
- CABLE STOCKED IN INCHES, 1 INCH = 25.4 MILLIMETERS.
- CABLE LENGTHS LONGER THAN 1000 MILLIMETERS ARE NOT SUPPORTED BY S.I. TEST DATA.
- MINIMUM BEND RADIUS FOR RF402 = 6.35 [0.250],
RR402 SUPPLIED AS STRAIGHT ASSEMBLIES ONLY, WITH MAX LENGTH = 585[23"].
- FOR SING ENDED OR STRIPPED AND TINNED ASSEMBLIES: MAKE A DOUBLE ENDED ASSEMBLY AT TWICE THE CABLE LENGTH AND TEST BEFORE CUTTING ASSEMBLY IN HALF.
- DIM "A" AND "B" HAVE A MINIMUM VALUE OF 0.0mm & A MAXIMUM VALUE OF 9.9mm.
- PRODUCTION OF STRIP AND TIN FOR CENTER DIELECTIC USE: A.
- PRODUCTION OF STRIP AND TIN FOR SHIELD USE: D=A+B.
- NOTE DELETED.
- FOR STRIPPED AND TINNED OPTION, ONLY THE CENTER CONDUCTOR IS TINNED.
- CONNECTORS TO BE ORIENTED ACCORDING TO CO-HD-WI-3048-M.

OPTION
F: SEMI FLEXIBLE
*R: SEMI RIGID
(SEE NOTE 10)

CABLE CALLOUT
402: CCA-402-X(RG-402 COAXIAL CABLE)

END 1 CONNECTOR
-01SP: SMA-P-C-XX-ST-CA9 (SEE SHEET 2)
-01RP: SMA-P-C-XX-RA-CA9 (SEE SHEET 2)
*-92SJ: 292XX-J-C-XX-ST-CA9 (SEE SHEET 2)
*-92SP: 292XX-P-C-XX-ST-CA9 (SEE SHEET 2)

END 1 PLATING OPTION
1: GOLD ALL COMPONENTS
4: ALTERNATE GOLD /GOLD FLASH/ NICKEL
6: ALTERNATE H GOLD / H GOLD / NICKEL
7: ALTERNATE GOLD MEDIUM/ GOLD FLASH
9: ALTERNATE HEAVY GOLD/MEDIUM GOLD
P: HEAVY GOLD / PASSIVATED STAINLESS STEEL
(SEE SHEET 2 FOR PLATING SPECIFICS)

* = NOT RELEASED

OVERALL CABLE LENGTH
MILLIMETERS OF CABLE (SEE NOTES 8 & 9)
0100 MIN - 1000 MAX FOR RF402 (SEMI-FLEXIBLE)
0100 MIN - 0305 MAX FOR RR402 (SEMI-RIGID)

END 2 PLATING OPTION
1: GOLD ALL COMPONENTS
4: ALTERNATE GOLD /GOLD FLASH/ NICKEL
6: ALTERNATE H GOLD / H GOLD / NICKEL
7: ALTERNATE GOLD MEDIUM/ GOLD FLASH
9: ALTERNATE HEAVY GOLD/MEDIUM GOLD
P: HEAVY GOLD / PASSIVATED STAINLESS STEEL
(SEE SHEET 2 FOR PLATING SPECIFICS)
(LEAVE BLANK FOR -SING OR -XXXX END 2 PREPARATION)

END 2 CONNECTOR OR PREPARATION
-01SP: SMA-P-C-XX-ST-CA9 (SEE SHEET 2)
-01RP: SMA-P-C-XX-RA-CA9 (SEE SHEET 2)
*-92SJ: 292XX-J-C-XX-ST-CA9 (SEE SHEET 2)
*-92SP: 292XX-P-C-XX-ST-CA9 (SEE SHEET 2)
-SING: SINGLE ENDED (ONE END ONLY, SEE NOTE 11)
-XXXX : STRIPPED AND TINNED (THIS END ONLY-
SEE NOTES 11-16 & SHEET 2, FIG 3)

(SEE FIG 2) "B" FORMAT: X.X mm
(SEE FIG 2) "A" FORMAT: X.X mm

DO NOT LEAVE ANY SPACE BLANK, EACH MUST CONTAIN A NUMERIC CHARACTER 0 THRU 9.

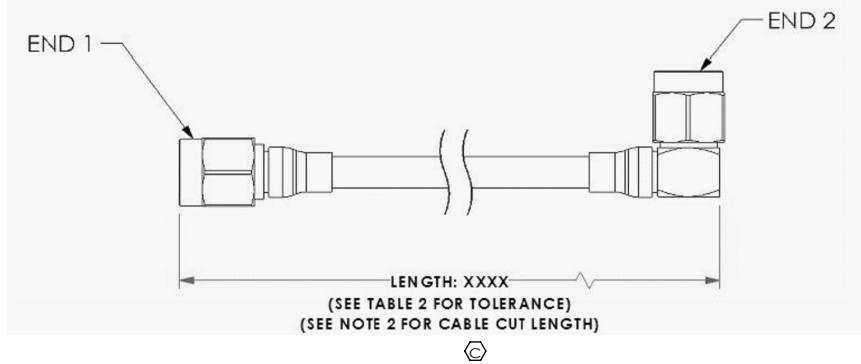

FIG 1
RF402-01SPX-01RPX-XXXX SHOWN

F:\DWG\MISC\MKTG\RX402-XXXXX-XXXXX-XXXX-MKT.SLDDRW

UNLESS OTHERWISE SPECIFIED, DIMENSIONS ARE IN MILLIMETERS [INCHES]. TOLERANCES ARE: DECIMALS ANGLES .X: ±0.3 [0.1] 2° .XX: ±0.13 [0.05] .XXX: ±0.051 [0.020]	PROPRIETARY NOTE THIS DOCUMENT CONTAINS CONFIDENTIAL AND PROPRIETARY INFORMATION AND ALL DESIGN, MANUFACTURING, REPRODUCTION, USE, PATENT RIGHTS AND SALES RIGHTS ARE EXPRESSLY RESERVED BY SAMTEC, INC. THIS DOCUMENT SHALL NOT BE DISCLOSED, IN WHOLE OR PART, TO ANY UNAUTHORIZED PERSON OR ENTITY NOR REPRODUCED, TRANSFERRED OR INCORPORATED IN ANY OTHER PRODUCT IN ANY MANNER WITHOUT THE EXPRESS WRITTEN CONSENT OF SAMTEC, INC.	DESCRIPTION: RF402 OR RR402 CABLE ASSEMBLY	
		DWG. NO. RX402-XXXXX-XXXXX-XXXX	
MATERIAL: DO NOT SCALE DRAWING SHEET SCALE: 2:1 SEE END 1 AND END 2 ASSEMBLY PRINTS		BY: ALVIN W 01/11/2011	SHEET 1 OF 2

REVISION H

-01SP
(STRAIGHT PLUG)

(USE DRAWING No. SMA-P-C-XX-ST-CA9
FOR ASSEMBLY INSTRUCTIONS)

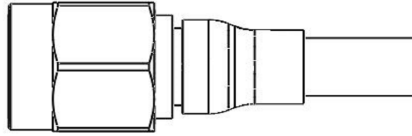

PLATING OPTIONS

- 1: 30µ" MIN. GOLD CENTER CONTACT
3µ" MIN. GOLD OUTER CONTACT
3µ" MIN. GOLD REMAINING METAL PARTS
(END CONNECTOR P/N: SMA-P-C-HF-ST-CA9)
- 4: 10µ" MIN. GOLD CENTER CONTACT
3µ" MIN. GOLD OUTER CONTACT
100µ" MIN. NICKEL REMAINING METAL PARTS
(END CONNECTOR P/N: SMA-P-C-GN-ST-CA9)
- 7: 10µ" MIN. GOLD CENTER CONTACT
3µ" MIN. GOLD OUTER CONTACT
3µ" MIN. GOLD REMAINING METAL PARTS
(END CONNECTOR P/N: SMA-P-C-GF-ST-CA9)

NOTE: ALL CRITICAL DIMENSIONS ON SMA-P-C-XX-ST-CA9
THAT APPLY MUST BE VERIFIED.

-01RP
(RIGHT ANGLE PLUG)

(USE DRAWING No. SMA-P-C-XX-RA-CA9
FOR ASSEMBLY INSTRUCTIONS)

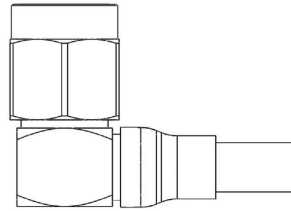

PLATING OPTIONS

- 1: 30µ" MIN. GOLD CENTER CONTACT
3µ" MIN. GOLD OUTER CONTACT
3µ" MIN. GOLD REMAINING METAL PARTS
(END CONNECTOR P/N: SMA-P-C-HF-RA-CA9)
- 4: 10µ" MIN. GOLD CENTER CONTACT
3µ" MIN. GOLD OUTER CONTACT
100µ" MIN. NICKEL REMAINING METAL PARTS
(END CONNECTOR P/N: SMA-P-C-GN-RA-CA9)
- 7: 10µ" MIN. GOLD CENTER CONTACT
3µ" MIN. GOLD OUTER CONTACT
3µ" MIN. GOLD REMAINING METAL PARTS
(END CONNECTOR P/N: SMA-P-C-GF-RA-CA9)

NOTE: ALL CRITICAL DIMENSIONS ON SMA-P-C-XX-RA-CA9
THAT APPLY MUST BE VERIFIED.

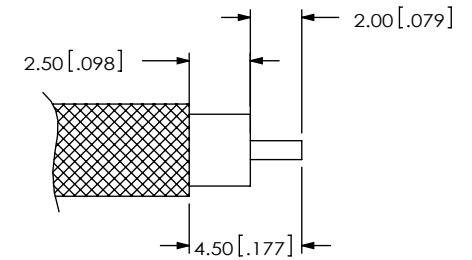
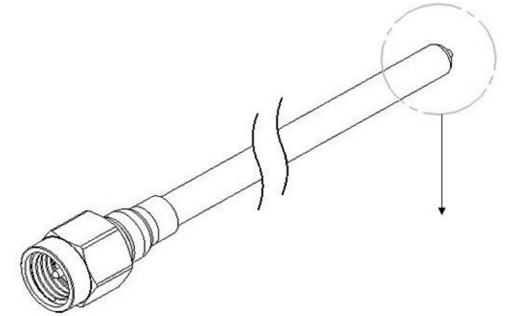
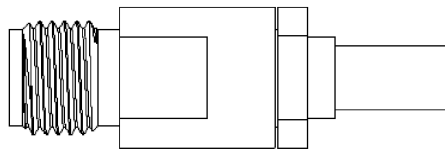

FIG 3
RX402-01SPX-2025-XXXX SHOWN

*** -92SJ**
(STRAIGHT JACK)

(USE DRAWING No. 292XX-J-C-XX-ST-CA9
FOR ASSEMBLY INSTRUCTIONS)



PLATING OPTIONS

- 6: 30µ" MIN. GOLD CENTER CONTACT
30µ" MIN. GOLD OUTER CONTACT
3µ" MIN. GOLD REMAINING METAL PARTS
(END CONNECTOR P/N: 292PB-J-C-HH-ST-CA9)
- 9: 30µ" MIN. GOLD CENTER CONTACT
10µ" MIN. GOLD OUTER CONTACT
3µ" MIN. GOLD REMAINING METAL PARTS
(END CONNECTOR P/N: 292PB-J-C-HG-ST-CA9)
- P: 30µ" MIN. GOLD CENTER CONTACT
PASSIVATED STAINLESS STEEL OUTER CONTACT
3µ" MIN. GOLD REMAINING METAL PARTS
(END CONNECTOR P/N: 292PS-J-C-HP-ST-CA9)

NOTE: ALL CRITICAL DIMENSIONS ON 292XX-J-C-XX-ST-CA9
THAT APPLY MUST BE VERIFIED.

*** -92SP**
(STRAIGHT PLUG)

(USE DRAWING No. 292XX-P-C-XX-ST-CA9
FOR ASSEMBLY INSTRUCTIONS)

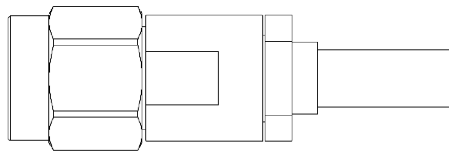

PLATING OPTIONS

- 6: 30µ" MIN. GOLD CENTER CONTACT
30µ" MIN. GOLD OUTER CONTACT
3µ" MIN. GOLD REMAINING METAL PARTS
(END CONNECTOR P/N: 292PB-P-C-HH-ST-CA9)
- 9: 30µ" MIN. GOLD CENTER CONTACT
10µ" MIN. GOLD OUTER CONTACT
3µ" MIN. GOLD REMAINING METAL PARTS
(END CONNECTOR P/N: 292PB-P-C-HG-ST-CA9)
- P: 30µ" MIN. GOLD CENTER CONTACT
PASSIVATED STAINLESS STEEL OUTER CONTACT
3µ" MIN. GOLD REMAINING METAL PARTS
(END CONNECTOR P/N: 292PS-P-C-HP-ST-CA9)

NOTE: ALL CRITICAL DIMENSIONS ON 292XX-P-C-XX-ST-CA9
THAT APPLY MUST BE VERIFIED.

F:\DWG\MISC\MKTG\RX402-XXXX-XXXX-XXXX -MKT.SLDDRW

*** PROPRIETARY NOTE ***
THIS DOCUMENT CONTAINS CONFIDENTIAL AND PROPRIETARY INFORMATION AND ALL DESIGN, MANUFACTURING, REPRODUCTION, USE, PATENT RIGHTS AND SALES RIGHTS ARE EXPRESSLY RESERVED BY SAMTEC, INC. THIS DOCUMENT SHALL NOT BE DISCLOSED, IN WHOLE OR PART, TO ANY UNAUTHORIZED PERSON OR ENTITY NOR REPRODUCED, TRANSFERRED OR INCORPORATED IN ANY OTHER PROJECT IN ANY MANNER WITHOUT THE EXPRESS WRITTEN CONSENT OF SAMTEC, INC.

DO NOT SCALE DRAWING

SHEET SCALE: 1:1



520 PARK EAST BLVD, NEW ALBANY, IN 47150
PHONE: 812-944-6733 FAX: 812-948-5047
e-Mail info@SAMTEC.com code 55322

DESCRIPTION:
RF402 OR RR402 CABLE ASSEMBLY

DWG. NO.
RX402-XXXXX-XXXXX-XXXX

BY: ALVIN W 01/11/2011 SHEET 2 OF 2