



The SSMB series are snap-on coupling micro-miniature coaxial connectors which are produced according to the specifications of IEC169-19 and CECC 22170. They have the characteristics of light weight, small size, easy to connect and disconnect, vibration-proof and high reliability, are suitable for connecting RF coaxial cables in micro-electronic equipments and instruments.

TECHNICAL CHARACTERISTICS

Environmental

Temperature range	-55 ~ +155° C
-------------------	---------------

Electrical Characteristics

Characteristic impedance	50 Ω
Frequency range	0-3GHz
Working voltage	250V
Contact resistance	Center contact: $\leq 5m\Omega$, Outer contact: $\leq 25m\Omega$
Insulation resistance	$\geq 1000M\Omega$
Dielectric withstanding voltage	500V
VSWR	Straight ≤ 1.22 (0-1GHz), ≤ 1.35 (0-3GHz)
	Right angle ≤ 1.50 (0-1GHz), ≤ 1.63 (0-3GHz)

Materials and Plating

Body	Brass, gold/nickel plated
Male center contacts	Phosphor bronze, gold plated
Female center contacts	Beryllium copper, gold plated
Insulators	PTFE
Crimp ferrules	Copper alloy, Gold or nickel plated

Mechanical Characteristics

Durability	500 cycles
------------	------------

INTERFACE MATING DIMENSIONS

Letter	PLUG (mm)	
	Minimum	Maximum
A	4.50	-
B	2.74	-
C	-	-
D	-	1.35
E	2.74	-
F	-	2.26
G	0.53	-
H	0.53	0.89

Letter	JACK (mm)	
	Minimum	Maximum
A	-	2.69
B	1.37	-
C	0.35	0.38
D	2.10	2.14
E	2.30	-
F	-	2.77
G	-	2.44
H	0.00	0.13
J	-	0.56

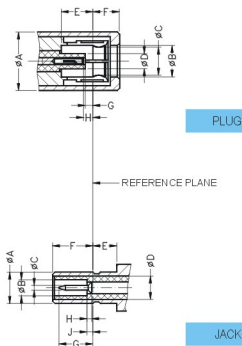

1. FLEXIBLE CABLE CONNECTORS

Straight Cable Jack, MD5

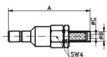

Part Number	GB Type	Cable Group	Remarks
SSMB1112001	SSMB-J2	2/50S	A=18.0, B=2.5, C=1.6
SSMB1112005	SSMB-(E)J2.5	2.6/50S	A=20.0, B=2.8, C=1.6
SSMB1112006	SSMB-(E)J2.5D	2.6/50D	A=20.0, B=3.4, C=1.6
SSMB1112002	SSMB-J3	3/50S	A=19.5, B=3.1, C=1.6

Straight Cable Jack, MD1



SSMB1112003	SSMB-J2A	2/50S	A=19.9, B=2.5, C=1.6
SSMB1112007	SSMB-(E)J2.5A	2.6/50S	A=21.9, B=2.8, C=1.6
SSMB1112008	SSMB-(E)J2.5DA	2.6/50D	A=21.9, B=3.4, C=1.6
SSMB1112004	SSMB-J3A	3/50S	A=21.4, B=3.1, C=1.6

1. FLEXIBLE CABLE CONNECTORS

Right Angle Cable Jack, MD4

Part Number	GB Type	Cable Group	Remarks
SSMB2112001	SSMB-JW2	2/50S	A=12.5, B=2.5, C=1.0
SSMB2112002	SSMB-(E)JW2.5	2.6/50S	A=14.5, B=2.8, C=1.6
SSMB2112003	SSMB-(E)JW2.5D	2.6/50D	A=14.5, B=3.4, C=1.6
SSMB2112004	SSMB-JW3	3/50S	A=14.0, B=3.1, C=1.6

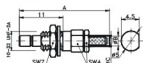
Straight Bulkhead Cable Jack, MD5

SSMB1132003	SSMB-JY2	2/50S	A=21.3, B=2.5, C=1.0
SSMB1132004	SSMB-(E)JY2.5	2.6/50S	A=23.1, B=2.8, C=1.6
SSMB1132005	SSMB-(E)JY2.5D	2.6/50D	A=23.3, B=3.4, C=1.6
SSMB1132006	SSMB-JY3	3/50S	A=22.8, B=3.1, C=1.6

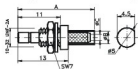
Straight Bulkhead Cable Jack, MD1

SSMB1132001	SSMB-JY2A	2/50S	A=22.0, B=3.1, C=1.0
SSMB1132007	SSMB-(E)JY2.5A	2.6/50S	A=22.5, B=2.8, C=1.6
SSMB1132008	SSMB-(E)JY2.5DA	2.6/50D	A=22.5, B=3.4, C=1.6
SSMB1132002	SSMB-JY3A	3/50S	A=22.0, B=3.1, C=1.6

Right Angle Cable Plug, MD4

SSMB2212006	SSMB-KW2E	2/50S	A=11.4, B=2.5, C=1.0
SSMB2212004	SSMB-(E)KW2.5	2.6/50S	A=11.4, B=2.8, C=1.6
SSMB2212005	SSMB-(E)KW2.5D	2.6/50D	A=11.4, B=3.4, C=1.6
SSMB2212003	SSMB-KW3	3/50S	A=11.4, B=3.1, C=1.6

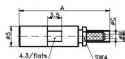
Straight Cable Plug, MD5

SSMB1212001	SSMB-K2	2/50S	A=23.5, B=2.5, C=1.0
SSMB1212004	SSMB-(E)K2.5	2.6/50S	A=25.5, B=2.8, C=1.6
SSMB1212005	SSMB-(E)K2.5D	2.6/50D	A=25.5, B=3.4, C=1.6
SSMB1212006	SSMB-K3	3/50S	A=25.0, B=3.1, C=1.6

2. PCB MOUNT RECEPTACLES

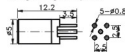
Straight Plug Receptacle

Part Number	GB Type	Remarks
SSMB1215001	SSMB-KHD	