



Applications

Aerospace : Pilot-helmet head set
(audio interconnection)
civil & military aircrafts
civil & military helicopters

Standards

Proprietary product line



Description

Low silhouette push-pull type audio connector with quick release function for radio communications

Resistance to fluids

fluid	type	designation
fuel		ISO 1817 Liquid B
hydraulic	petroleum based	OM-15, NATO H-515, OX-30
lubricating oils	naval diesel	OMD-113, NATO O-278
	turbine	OX-38, NATO-149
cleaning		trichloroethane isopropyl alcohol methanol / ethanol
de-icing	isopropanol	AL-11, NATO S-737, AL-34, NATO S-1746

Characteristics

Mechanical

- Release force : 250 N < F < 400 N
- 100% scoop-proof design
- Polarization by 5 keys
- Endurance : 500 cycles
- Finish : conductive black plating
- Insulator : thermosetting plastic
- Grommet and seals : silicone elastomer
- Contact material : copper alloy
plating : gold over nickel
- Vibration : 55 Hz to 2000 Hz at 10g (6 hours)

Electrical

- Crosstalk on mated pair : ≤ 110 dB at 8 kHz
- Contact resistance : $\leq 0,01$ m Ω within 5 mA - 500 mA
- Insulation resistance : $\geq 10^5$ M Ω at 20°C with 60% humidity 500 Vdc
- Operating voltage : size 20 : 1800 V . 50Hz
size 22 : 1300 V . 50Hz

Climatic

- Temperature range : -45°C to +125°C
- Watertight : 28 PSI, 2 bars

Contacts

contact size	\varnothing (mm)	I (A)	R (m)	admissible wires						
				AWG			insulator (mm)			
				cross section (mm ²)	min	average	max			
22D	0.775	5	8	22	24	28	28	0.76	1.20	1.37
	0.749			0.38	0.22	0.15	0.095			
20	1.041	7.5	4.7	20	22	24		1.02	1.83	2.11
	0.991			0.60	0.38	0.22				

Connector selector guide

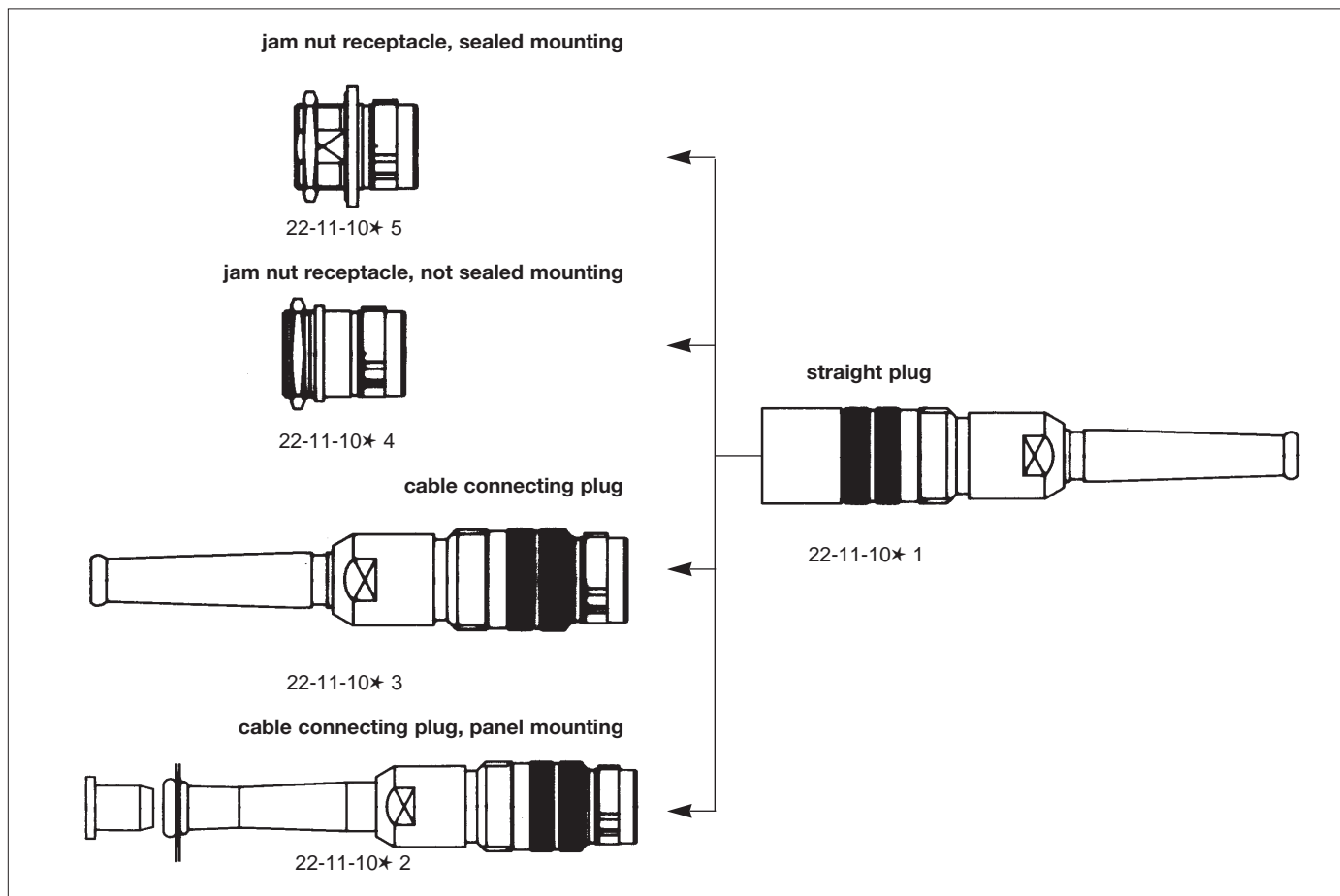



Contact layouts

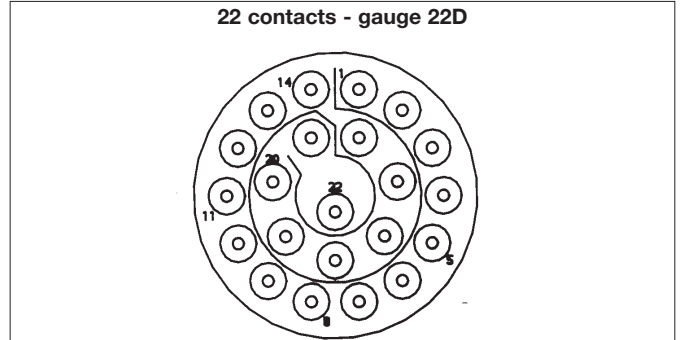
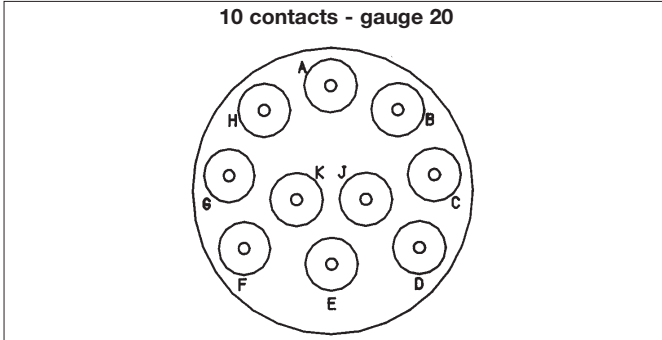

Dimensions

Plug

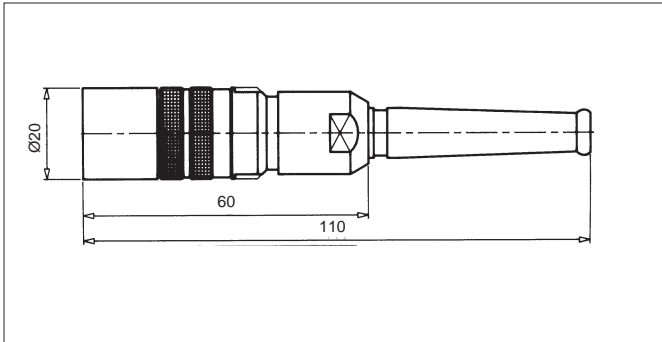

part numbers	layouts	weight
22 - 11 - 10 - 01	10 - gauge / male	30g
22 - 11 - 10 - 11	10 - gauge / female	30g
22 - 11 - 10 - 31	22 - gauge / female	31g

Cable connecting plug, panel mounting

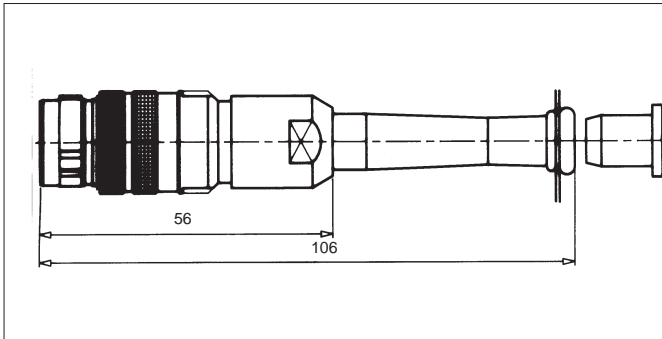

part number	layout	weight
22 - 11 - 10 - 02	10 - gauge / female	29g

Cable connecting plug

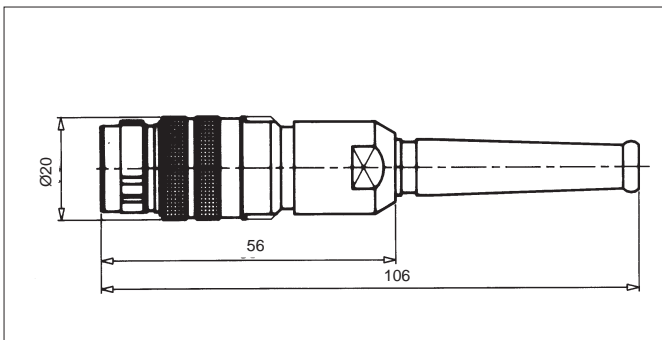

part numbers	layouts	weight
22 - 11 - 10 - 05	10 - gauge / female	27g
22 - 11 - 10 - 35	22 - gauge / male	28g



Jam-nut receptacle, sealed mounting

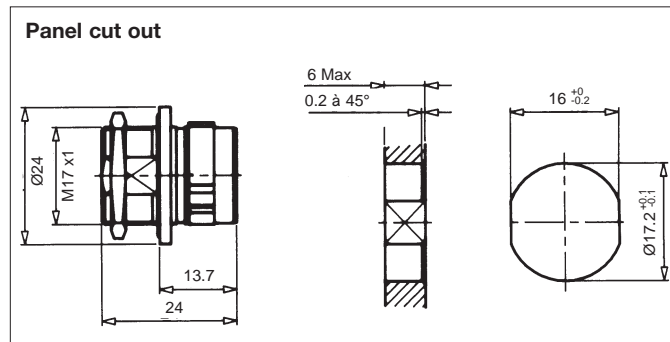

part numbers	layouts	weight
22 - 11 - 10 - 03	10 - gauge / female	11g
22 - 11 - 10 - 13	10 - gauge / male	11g
22 - 11 - 10 - 33	22 - gauge / male	12g

Jam-nut receptacle, not sealed mounting

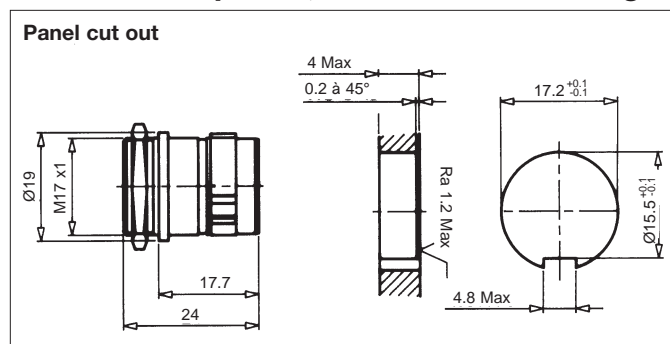

part numbers	layouts	weight
22 - 11 - 10 - 04	10 - gauge / female	10g
22 - 11 - 10 - 34	22 - gauge / male	11g

Mated connectors

Jam-nut receptacle, without sealed mounting and plug

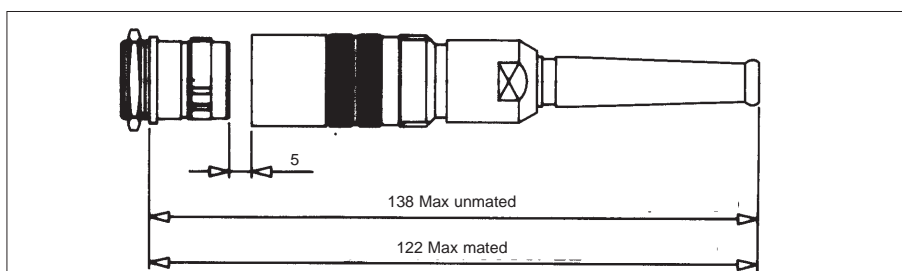

Jam-nut receptacle, with sealed mounting and plug

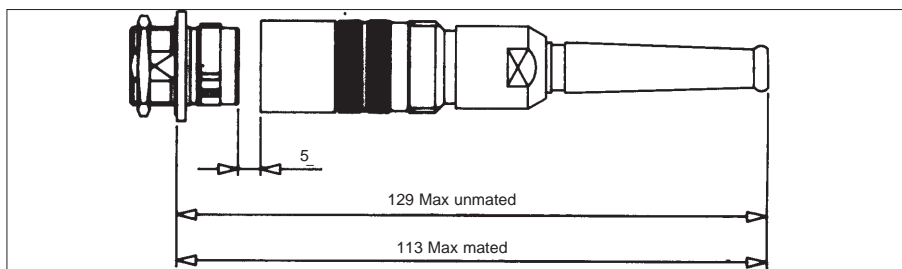

Plug with cable connecting plug

