

CATALOG NUMBER	"A" INTERFACE
----------------	---------------

1R3M1-0503-01

FULL DETENT

1R5M1-0503-01

SMOOTH BORE

MATERIAL AND FINISH

G3PO HOUSING AND
1.85 mm HOUSING:

CRES 303; PASSIVATED

CENTER CONTACT:

BeCu; GOLD PLATE OVER NICKEL PLATE

DIELECTRICS:

VIRGIN PTFE

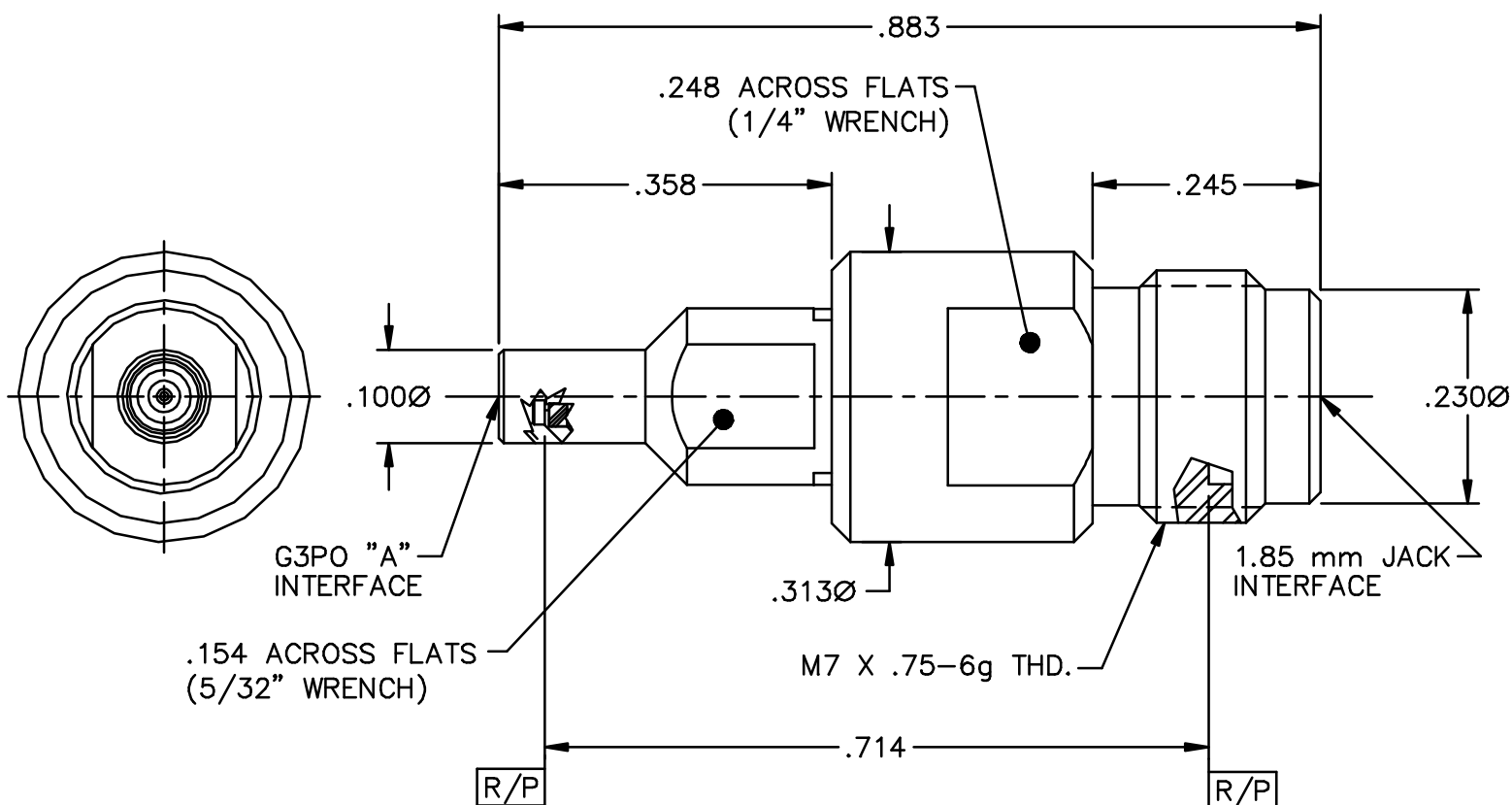
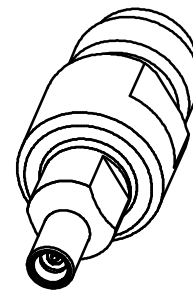

This drawing and any data contained herein is the property of Corning Gilbert Inc., and constitutes and contains proprietary and confidential information. Neither receipt nor possession of this drawing confers or transfers any right to duplicate, use or disclose any information contained herein except as expressly authorized by Corning Gilbert Inc.

G3PO MALE TO 1.85 mm
JACK ADAPTER
(TAB DETENT)

IDENT CODE:
82316

REVISION: A

Corning Gilbert Inc.

SOURCE FILE: SK-2358

DWG. NO.: OL-1RXM1-0503-01

ASSY. PROC.:

—