



## Machine Pin Socket Straight Type 1.778mm / SMT R/A Type 2.0mm

### Specifications

Current Rate: 3 AMP  
 Insulation Resistance:  $\geq 1000M\Omega$  at  $V=100V$ .  
 Contact Resistance:  $\leq 4m\Omega$ /Contact.  
 Dielectric Voltage: 1000V AC for one minute  
 Operation Temperature:  $-40^{\circ}C$  to  $+105^{\circ}C$

### Material

Insulator: Polyester, UL 94V-0  
 ©Standard: PPS  
 Terminal: Copper Alloy  
 Plated: Selective Gold

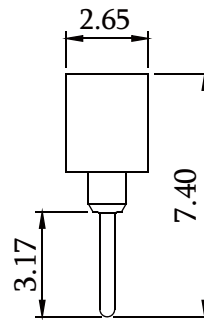
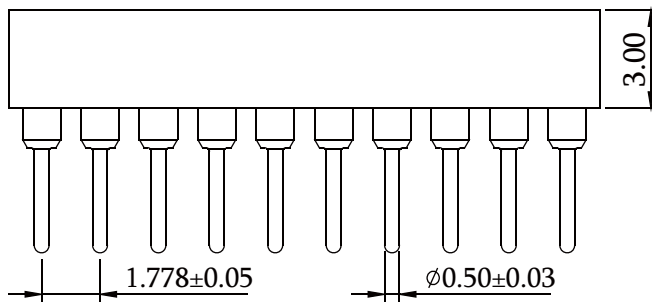
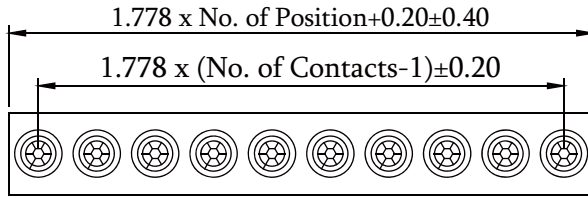
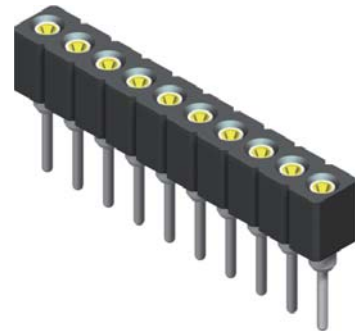

Part No.: MS7S-1XX-U

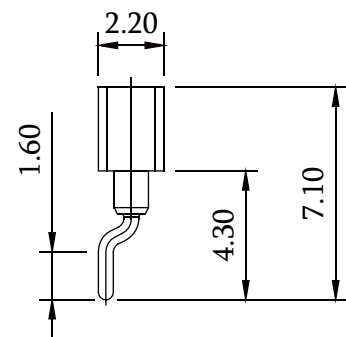
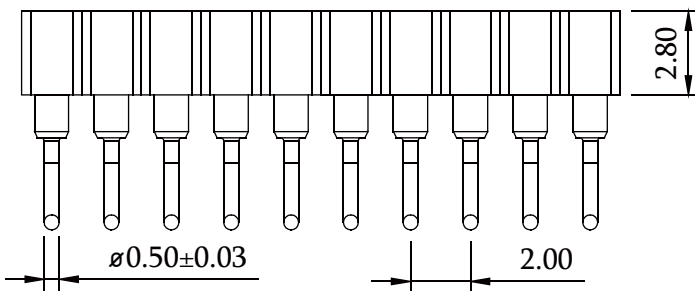
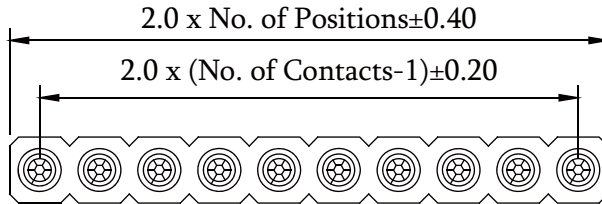

Part No.: MS2MR-1XX-U

## ORDER INFORMATION

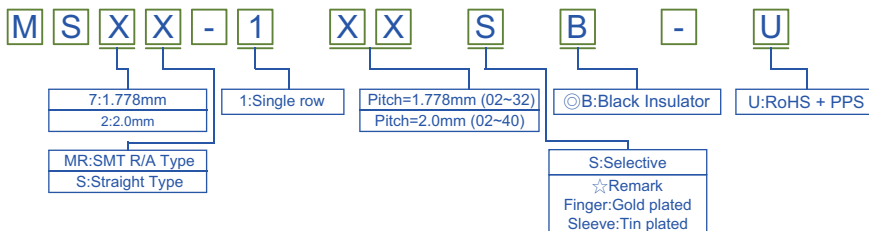

©: Standard Recommended

Machine Pin Socket

Pb ROHS