



T19P

3/4" rectangular multiturn fully sealed container cermet trimmer

– military and professional grade

0,5 W at 70°C
MIL-R-22097
CECC 40 101-802
(DLDV)
GAM T1

Potentiometers
and trimmers

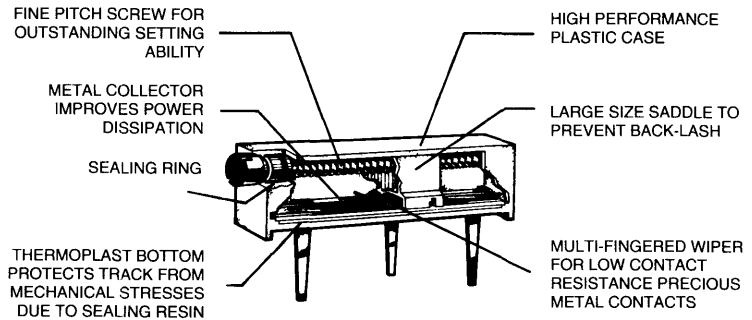
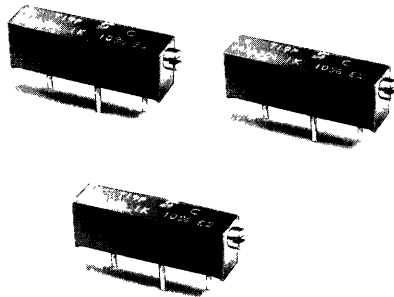

T19P - PM63

DL.DV

DL : > 100 Ω
DV : 100 Ω

SHAFT

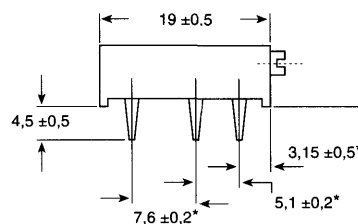
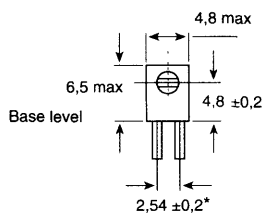
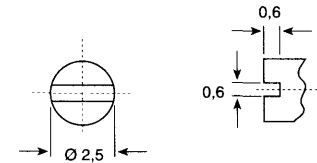
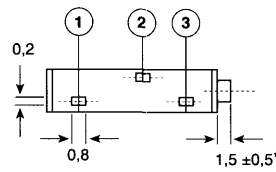

CIRCUIT DIAGRAM

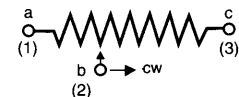

* To be measured at base level
Dimensions in mm

SPECIFICATIONS

MECHANICAL

MECHANICAL TRAVEL...	18 turns ±5
OPERATING TORQUE (max. Ncm)...	2
END STOP TORQUE ...	clutch action
UNIT WEIGHT (max. g)...	1

ENVIRONMENTAL

TEMPERATURE RANGE...	-55°C +125°C
CLIMATIC CATEGORY...	55 / 125 / 56
SEALING...	fully sealed container IP67

ELECTRICAL

RESISTIVE ELEMENT...	cermet
ELECTRICAL TRAVEL...	15 turns ±1
RESISTANCE RANGE...	10 Ω...2,2 MΩ
Standard series E3 (1 - 2,2 - 4,7)	
on request series 1 - 2 - 5	
TOLERANCE standard...	±10%
on request...	±5%
POWER RATING linear...	0,5 W at +70°C
logarithmic...	not applicable
TEMPERATURE COEFFICIENT...	see table 2
LIMITING ELEMENT VOLTAGE (linear law)...	250 V
CONTACT RESISTANCE VARIATION ...	2% R _n or 1 Ω
END RESISTANCE (typical)...	1 Ω
DIELECTRIC STRENGTH (RMS)...	1000 V
INSULATION RESISTANCE (500 V DC)...	10 ⁶ MΩ

PERFORMANCE

Table 1

CECC 41100				TYPICAL VALUES AND DRIFTS		
TESTS	CONDITIONS	$\frac{\Delta R_T}{R_T}$ (%)	REQUIREMENTS	$\frac{\Delta R_{1-2}}{R_{1-2}}$ (%)	$\frac{\Delta R_T}{R_T}$ (%)	$\frac{\Delta R_{1-2}}{R_{1-2}}$ (%)
CLIMATIC SEQUENCE	Phase A dry heat 125°C Phase B damp heat Phase C cold -55°C Phase D damp heat 5 cycles	± 2%		± 3%	± 0,5%	± 1%
LONG TERM DAMP HEAT	56 days	± 2 % Dielectric strength : 700 V Insulation resistance : > 100 MΩ		± 3%	± 0,5 % Dielectric strength : 1000 V Insulation resistance : > 10 ⁴ MΩ	± 1%
ROTATIONAL LIFE	200 cycles	± 2 % Contact res. variat.: < 3% Rn			± 2 % Contact res. variat.: < 1% Rn	
LOAD LIFE	1000 h at rated power 90°/30° - ambient temp. 70°C	± 2 % Contact res. variat.: < 3% Rn		± 3%	± 1 % Contact res. variat.: < 2% Rn	± 2%
RAPID TEMPERATURE CHANGE	5 cycles -55°C at +125°C	± 1,5 %		$\frac{\Delta V_{1-2}}{V_{1-3}} \pm 1\%$	± 0,5 %	$\frac{\Delta V_{1-2}}{V_{1-3}} \leq \pm 1\%$
SHOCKS	50 g at 11 m secs 3 successive shocks in 3 directions	± 1%		± 2%	± 0,1%	± 0,3%
VIBRATIONS	10-55 Hz 0,75 mm or 10 g during 6 hours	± 1 %		$\frac{\Delta V_{1-2}}{V_{1-3}} \pm 2\%$	± 0,1 %	$\frac{\Delta V_{1-2}}{V_{1-3}} \leq \pm 0,3\%$

Potentiometers
and trimmers

STANDARD RESISTANCE ELEMENT DATA

Table 2

Standard resistance values	LINEAR LAW			T.C. - 55°C + 125°C
	Max. power at +70°C	Max. working voltage	Max. cur. through element	
Ω	W	V	mA	ppm/°C
10 22 47	0,5	2,2 3,3 4,8	224 150 103	0 +200
100 220 470 1 k 2,2 k 4,7 k 10 k 22 k 47 k 100 k 220 k 470 k 1 M 2,2 M		7 10,5 15,3 22,4 33,2 48,5 70,7 105 153 224 250 250 250 250	70 47 32 22 15 10 7 4,8 3,2 2,2 1,1 0,53 0,25 0,11	±100

MARKING

Printed :

- SFERNICE trademark
- series NF version if applicable
- ohmic value (in Ω, kΩ, MΩ)
- tolerance in %
- manufacturing date
- marking of terminal : (c).

PACKAGING

- In plastic box of 50 pieces : BLISTER.
- In magazine pack by 25 pieces (tube) code "TU" or no code.

POWER RATING CHART

Fig. 2

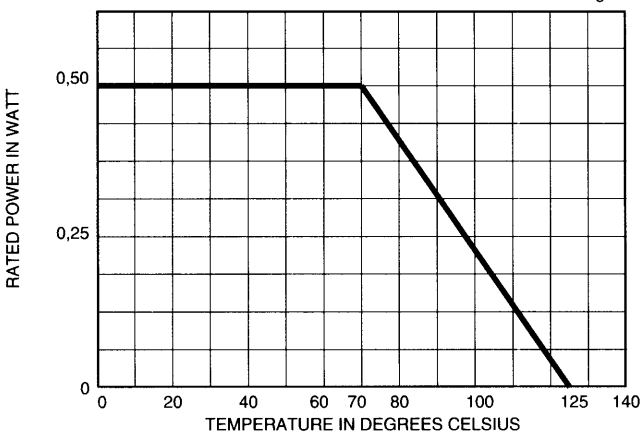

ORDERING PROCEDURE

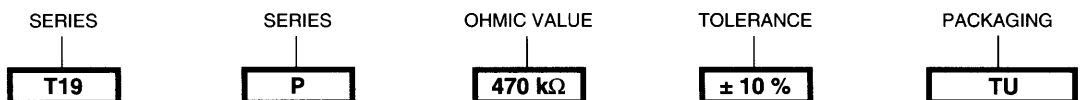

N.B.: On delivery the wiper is positioned at mid-travel.

TU : Tube or no code
BLISTER