

Rev	AWO #	Description	Date	Appr
-	10551	RELEASED	10/21/10	

APPROVED: \_\_\_\_\_ TITLE: \_\_\_\_\_  
 DATE: \_\_\_\_\_

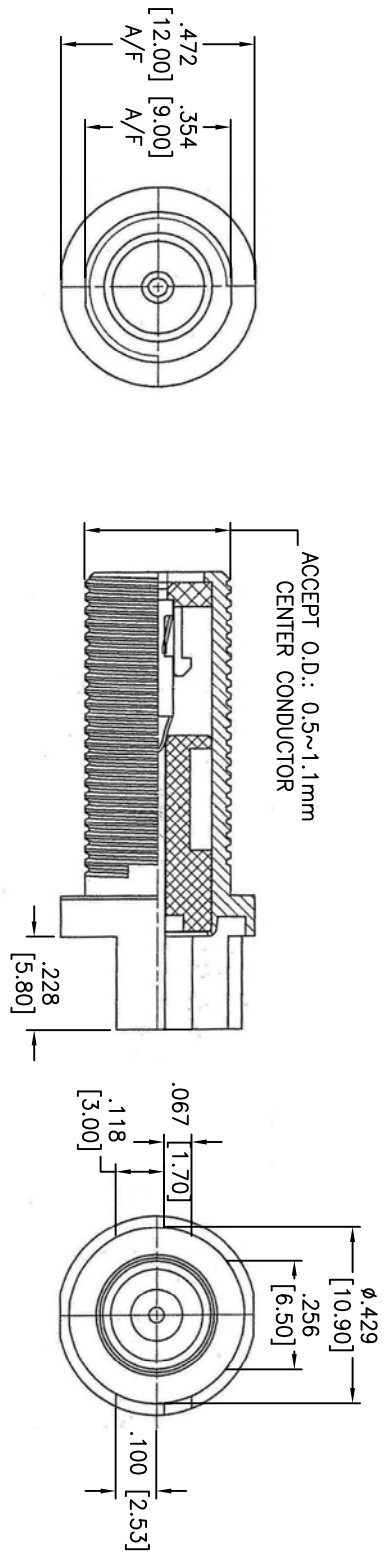

BODY	ZINC	TIN
INSULATOR	PP	BLACK
CONTACT PIN	P-BRONZE	TIN
INSULATOR	PP	BLACK
DESCRIPTION	MATERIAL	FINISH

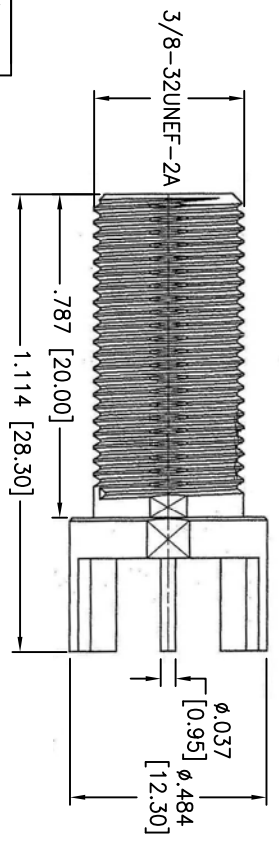

**SPECIFICATIONS:**

Electrical:  
 Frequency range: 0-2 GHz  
 Working Voltage: 250 VRMS max.  
 Dielectric Withstanding Voltage: 500 VRMS min.  
 Contact Resistance: 5 Milliohms max. (Center Contact)  
 2 Milliohms max. (Outer Contact)  
 Insulator Resistance: 1000 Megohms min.  
 Environmental:  
 Lead free, RoHS compliant.



UNLESS OTHERWISE SPECIFIED  
 ALL DIMENSIONS ARE INCHES [MM]  
 TOLERANCES: EXCEPT AS NOTED  
 INCHES                    Holes

.X	± .10	ØX	± .10
.XX	± .020	ØXX	± .015
.XXX	± .015	ØXXX	± .010

APPROVALS

DRAWN	DY	DATE
CHECKED		10/21/10
APPROVED		

**ADAM TECH**  
 909 Rahway Avenue, Union, NJ 07083  
 Phone: 908-687-5000 Fax: 908-687-5710

TITLE: F JACK PCB EDGE MOUNT RECEPTACLE

SIZE	PART NO.	REV.
X	RF4-41-P-00-75	-
REF:	S00049T	SCALE: NTS
		SHEET 1 OF 1