

High Frequency Current Transformers

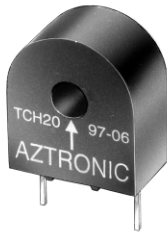

DIMENSIONS in millimeters

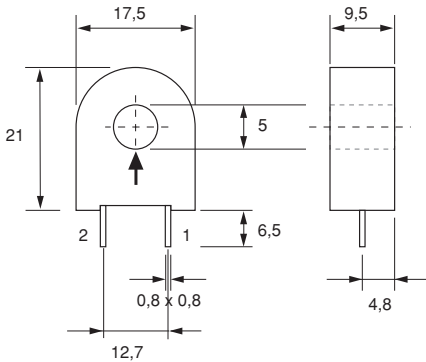

FEATURES

- TCH current transformers are designed for AC current measurement for frequencies from 20kHz to 100kHz or current limitation on switching power supplies or DC/DC converters
- Measurement is done using a lead going through the center of the transformer
- No temperature rise, no disturbance can be noted

TYPICAL APPLICATION

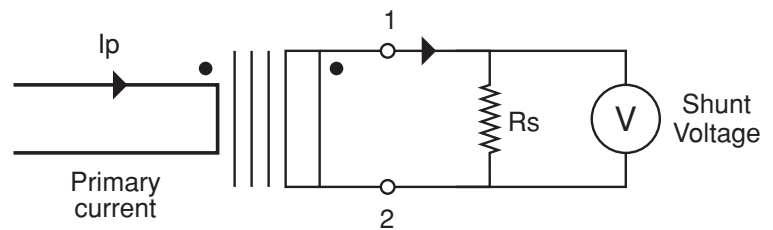

MECHANICAL SPECIFICATIONS

Case UL 94 V0
 Unit Weight 6g

CLIMATIC SPECIFICATIONS

Temperature Range Shelf - 55°C + 85°C
 Working - 30°C + 75°C

MARKING

Print marked: manufacturer, series, model, manufacturing date (code). Arrow showing reference for phase matching with 1-2 winding.

ELECTRICAL SPECIFICATIONS

Frequency Range 20kHz/100kHz
 Insulation 4k VRMS

| | TCH 5 | | TCH 10 | | TCH 20 | |
|---|--|------|--|------|--|------|
| Ratio | 1: 50 | | 1: 100 | | 1: 200 | |
| Shunt Resistance to Add to the Circuit RS (Ω) | 50 | 1000 | 50 | 1000 | 50 | 1000 |
| Primary Current max. (A) | 5 | 1 | 10 | 2 | 20 | 4 |
| Ratio | Shunt Voltage (V) Primary Current (A) | | Shunt Voltage (V) Primary Current (A) | | Shunt Voltage (V) Primary Current (A) | |
| | 1 | 20 | 0.5 | 10 | 0.25 | 5 |
| Winding Resistance 1-2 (Ω) | 0.20 | | 1.5 | | 11.5 | |

TCH 5 with shunt 50Ω

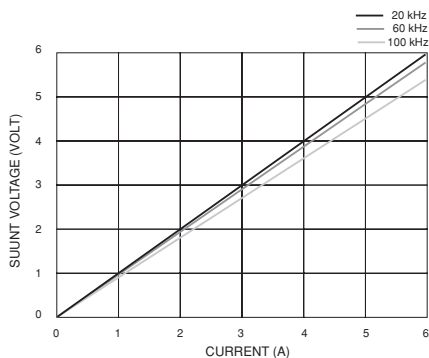

TCH 10 with shunt 50Ω

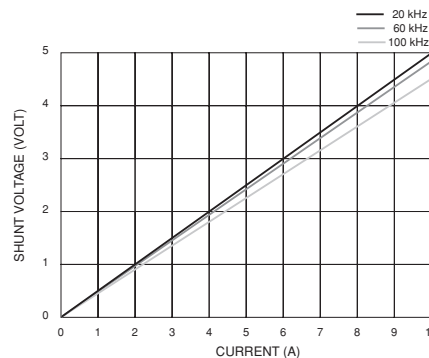

TCH 20 with shunt 50Ω

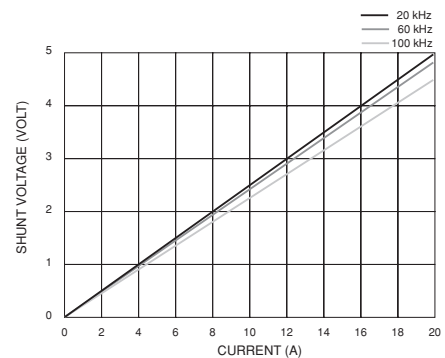

PACKAGING

50 pieces in a sectioned box

ORDERING INFORMATION

TCH
 SERIES

10
 MODEL