

- 1.0 PERFORMANCE
- 1.1 FREQUENCY RANGE: DC-11GHz
- 1.2 VOLTAGE RANGE: 1000V RMS (sea level)
- 1.3 NOMINAL IMPEDANCE: 50 OHMS
- 1.4 DWV: 2500V RMS @ 60Hz (sea level)
- 1.5 TEMPERATURE RANGE: -65°C TO +165°C
- 2.0 MATERIALS
- 2.1 DIELECTRIC: TEFLON, ASTM-D-1710
- 2.2 CENTER CONTACT: BERYLLIUM COPPER ASTM-B-196
- 2.3 LOCKING RING: PHOSPHOR BRONZE, ASTM-B-159, SPRING TEMPER
- 2.4 OTHER METAL PARTS: BRASS, ASTM-B-16
- 2.5 GASKET: SILICON RUBBER, ZZ-R-765, GR. 50, RED FINISHES
- 3.0 FINISHES
- 3.1 CENTER CONTACT: SEE TABLE
- 3.2 ALL OTHER METAL PARTS: SEE TABLE
- 4.0 MECHANICAL
- 4.1 INTERFACE IN ACCORDANCE WITH MIL-STD-348

DRAWING

	BODY	CONTACT
UG-27 D/U	Ni	GOLD
UG-27 D/U SI	Si	GOLD

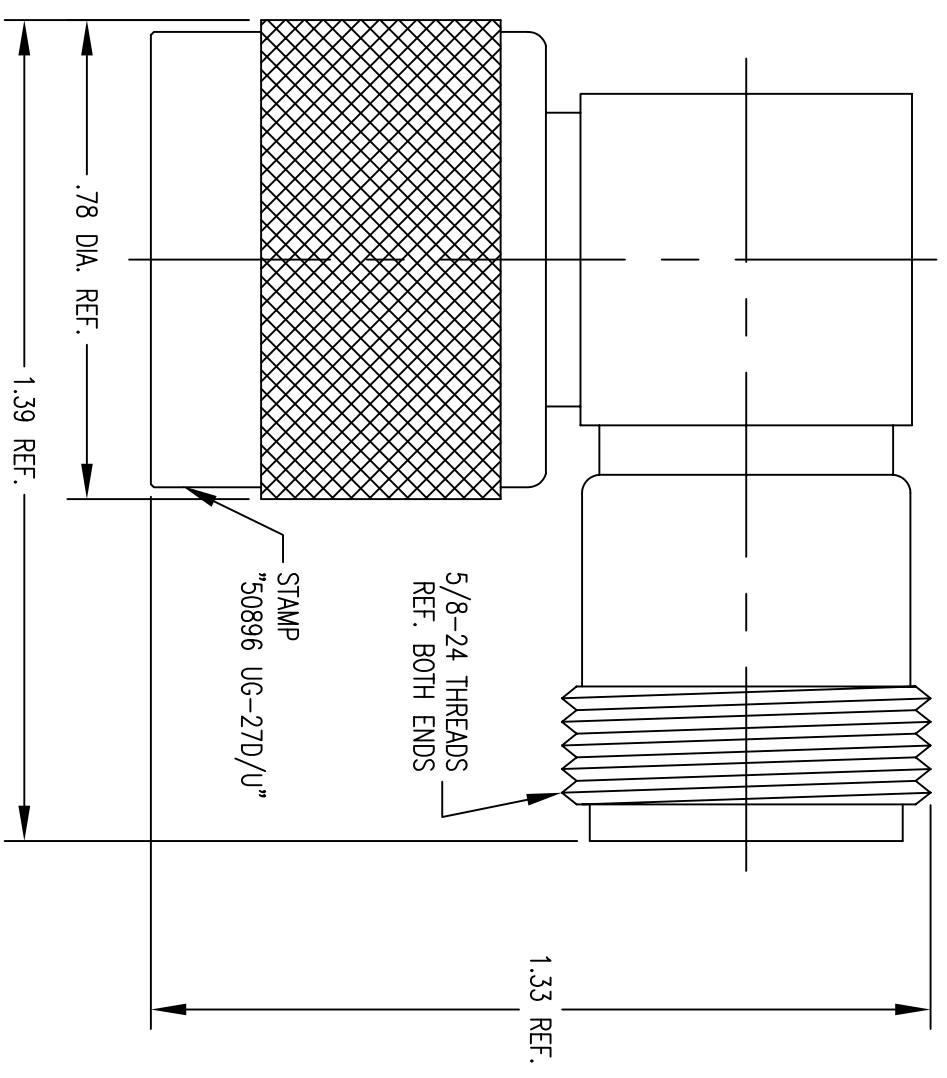

THIS DRAWING CONTAINS CONFIDENTIAL INFORMATION PROPRIETARY TO SAN-TRON INC. IT MUST NOT BE REPRODUCED OR DISCLOSED TO OTHERS OR USED IN ANY OTHER WAY, IN WHOLE OR PART EXCEPT AS AUTHORIZED IN WRITING BY SAN-TRON INCORPORATED.

UNLESS OTHERWISE SPECIFIED:  
 ALL DIMENSIONS ARE IN INCHES.  
 ALL DIMENSIONS ARE AFTER PLATING.  
 ALL MACHINED SURFACES  $\phi_3$ /MAX.  
 .XXX =  $\pm$ .005 .XX =  $\pm$ .01 FRACTIONAL =  $\pm$ 1/64  
 .XXX MAX. TIR ANG.  $\pm$  1/2°

**SAN-TRON, INC.**  
 4 NEWBURYPORT TPK. IPSWICH MA USA 01938  
 TEL: 978 - 356 -1585 FAX: 978 - 356 -1573  
 WWW.SANTRON.COM E MAIL: santron@santron.com

**RIGHT ANGLE ADAPTER**  
 N(M)-N(F)

MATERIAL: SEE NOTE 2.0  
 FINISH: SEE TABLE

Rev.	Revisions	Disp.	Date	Dwn.	Appd.
A	ORIGINAL	NEW	03/03/03	X	X
B	ADDED CHART		03/06/03	LAP	FSH
RECOM. STOCK SIZE FT/M PCS					

THIRD ANGLE PROJECTION	DWN	JMB	5/31/00	CHKD	SJS	11/16/00	APPR	FSH	11/16/00	SCALE	3:1	DWG NO.	OL-27D-1	REV.	B
------------------------	-----	-----	---------	------	-----	----------	------	-----	----------	-------	-----	---------	----------	------	---