

Optocoupler with Phototransistor Output

Description

The CNY64/ 65/ 66 consist of a phototransistor optically coupled to a gallium arsenide infrared-emitting diode in a 4-lead plastic package.

The single components are mounted in opposite oneanother, providing a distance between input and output for highest safety requirements of > 3 mm.

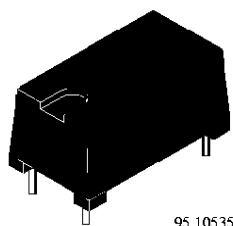

95 10535

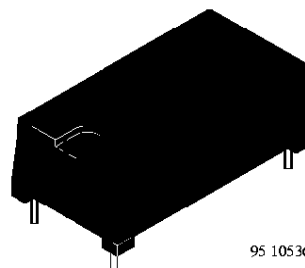

95 10536

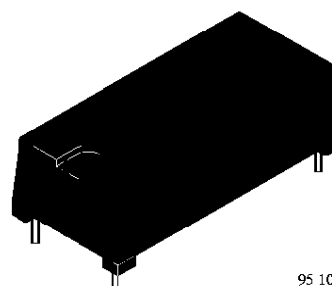

95 10537

Application

Circuits for safe protective separation against electrical shock according to safety class II (reinforced isolation):

- For application class I - IV at mains voltage ≤ 300 V
- For application class I - IV at mains voltage ≤ 600 V
- For application class I - III at mains voltage ≤ 1000 V according to VDE 0884, table 2, suitable for:

Switch-mode power supplies, computer peripheral interface, microprocessor system interface, line receiver.



0884

These couplers perform safety functions according to the following equipment standards:

- | | |
|---|---|
| <ul style="list-style-type: none"> • VDE 0884/08.87
Optocoupler providing protective separation • VDE 0804
Telecommunication apparatus and data processing • VDE 0805/IEC 950/EN 60950
Office machines (applied for reinforced isolation for mains voltage ≤ 400 V_{RMS}) | <ul style="list-style-type: none"> • VDE 0860/IEC 65
Safety for mains-operated electronic and related household apparatus • VDE 0700/IEC 335
Household equipment • VDE 0160
Electronic equipment for electrical power installation • VDE 0750/IEC 601
Medical equipment |
|---|---|

Features

- Approvals:
BSI: BS 415, BS 7002
FIMKO (SETT): EN 950
 Underwriters Laboratory (UL) 1577
 recognized-file No. E-76222
VDE 0884 Certificate number 76814

VDE 0884 related features:

- Rated impulse voltage (transient overvoltage)
 $V_{10TM} = 8 \text{ kV peak}$
- Isolation test voltage (partial discharge test voltage)
 $V_{pd} = 2.8 \text{ kV peak}$
- Rated insulation voltage (RMS includes DC)
 $V_{IOWM} = 1000 V_{RMS} (1450 \text{ V peak})$
- Rated recurring peak voltage (repetitive)
 $V_{IORM} = 1000 V_{RMS}$
- Creepage current resistance according to
 VDE 0303/IEC 112
 Comparative Tracking Index: (CTI) = 200
- Thickness through insulation > 3 mm

General features:

- Isolation materials according to UL94-VO
- Pollution degree 2
 (DIN/VDE 0110 part 1 resp. IEC 664)
- Climatic classification 55/085/21 (IEC 68 part 1)
- Special construction:
 Therefore extra low coupling capacity
 typical 0.3 pF, high Common Mode Rejection
- Low temperature coefficient of CTR
- Current Transfer Ratio (CTR) = 50 to 300%
- CNY64/65 also available in CTR groups A and B

Pin Connection

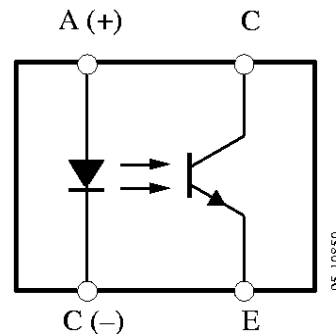

Absolute Maximum Ratings

Input (Emitter)

Parameters	Test Conditions	Symbol	Value	Unit
Reverse voltage		V_R	5	V
Forward current		I_F	75	mA
Forward surge current	$t_p \leq 10 \mu\text{s}$	I_{FSM}	1.5	A
Power dissipation	$T_{amb} \leq 25^\circ\text{C}$	P_{tot}	120	mW
Junction temperature		T_j	100	$^\circ\text{C}$

Output (Detector)

Parameters	Test Conditions	Symbol	Value	Unit
Collector emitter voltage		V_{CEO}	32	V
Emitter collector voltage		V_{ECO}	7	V
Collector current		I_C	50	mA
Collector peak current	$t_p/T = 0.5, t_p \leq 10 \text{ ms}$	I_{CM}	100	mA
Power dissipation	$T_{amb} \leq 25^\circ\text{C}$	P_{tot}	130	mW
Junction temperature		T_j	100	$^\circ\text{C}$

Coupler

Parameters	Test Conditions	Symbol	Value	Unit
AC isolation test voltage (RMS)		V_{IO}	8.2	kV
Total power dissipation	$T_{amb} \leq 25^{\circ}\text{C}$	P_{tot}	250	mW
Ambient temperature range		T_{amb}	-55 to +85	$^{\circ}\text{C}$
Storage temperature range		T_{stg}	-55 to +100	$^{\circ}\text{C}$
Soldering temperature	2 mm from case, $t \leq 10$ s	T_{sd}	260	$^{\circ}\text{C}$

Maximum Safety Ratings ¹⁾ (according to VDE 0884)

Input (Emitter)

Parameters	Test Conditions	Symbol	Value	Unit
Forward current		I_{si}	120	mA

Output (Detector)

Parameters	Test Conditions	Symbol	Value	Unit
Power dissipation	$T_{amb} \leq 25^{\circ}\text{C}$	P_{si}	250	mW

Coupler

Parameters	Test Conditions	Symbol	Value	Unit
Rated impulse voltage		V_{IOTM}	8	kV
Safety temperature		T_{si}	180	$^{\circ}\text{C}$

- 1) This device is used for protective separation against electrical shock only within the maximum safety ratings. This must be ensured by using protective circuits in the applications.

Derating Diagram

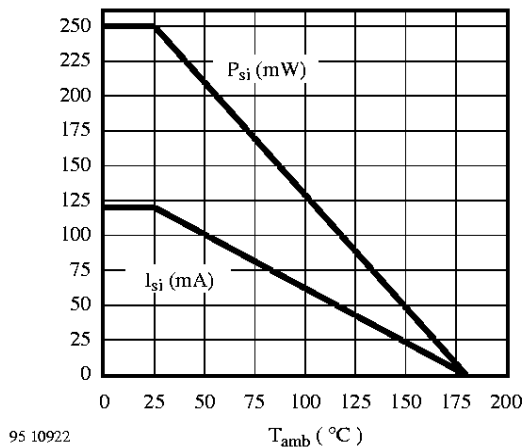

Electrical Characteristics

T_{amb} = 25°C

Input (Emitter)

Parameters	Test Conditions	Type	Symbol	Min.	Typ.	Max.	Unit
Forward voltage	I _F = 50 mA		V _F		1.25	1.6	V
Junction capacitance	V _R = 0, f = 1 MHz		C _j		50		pF

Output (Detector)

Parameters	Test Conditions	Type	Symbol	Min.	Typ.	Max.	Unit
Collector emitter voltage	I _C = 1 mA		V _{CEO}	32			V
Emitter collector voltage	I _E = 100 μA		V _{ECO}	7			V
Collector emitter cut-off current	V _{CE} = 20 V, I _f = 0		I _{CEO}			200	nA

Coupler

Parameters	Test Conditions	Type	Symbol	Min.	Typ.	Max.	Unit
AC isolation test voltage (RMS)	f = 50 Hz, t = 1 s		V _{IO}	8.2			kV
Collector/emitter saturation voltage	I _F = 10 mA, I _C = 1 mA		V _{CEsat}			0.3	V
Cut-off frequency	V _{CE} = 5 V, I _F = 10 mA, R _L = 100 Ω		f _c		110		kHz
Coupling capacitance	f = 1 MHz		C _k		0.3		pF
I _C /I _F	V _{CE} = 5 V, I _F = 10 mA	CNY64 CNY65 CNY66	CTR	0.5	1	3	
		CNY64A CNY65A		0.63		1.25	
		CNY64B CNY65B		1		2	

Switching Characteristics (Typical Values)

$V_S = 5\text{ V}$

Type	$R_L = 100\ \Omega$ (see figure 1)						$R_L = 1\ \text{k}\Omega$ (see figure 2)			
	$t_d[\mu\text{s}]$	$t_r[\mu\text{s}]$	$t_{on}[\mu\text{s}]$	$t_s[\mu\text{s}]$	$t_f[\mu\text{s}]$	$t_{off}[\mu\text{s}]$	$I_C[\text{mA}]$	$t_{on}[\mu\text{s}]$	$t_{off}[\mu\text{s}]$	$I_F[\text{mA}]$
CNY64, 65, 66	2.6	2.4	5.0	0.3	2.7	3.0	5	25	42.5	10

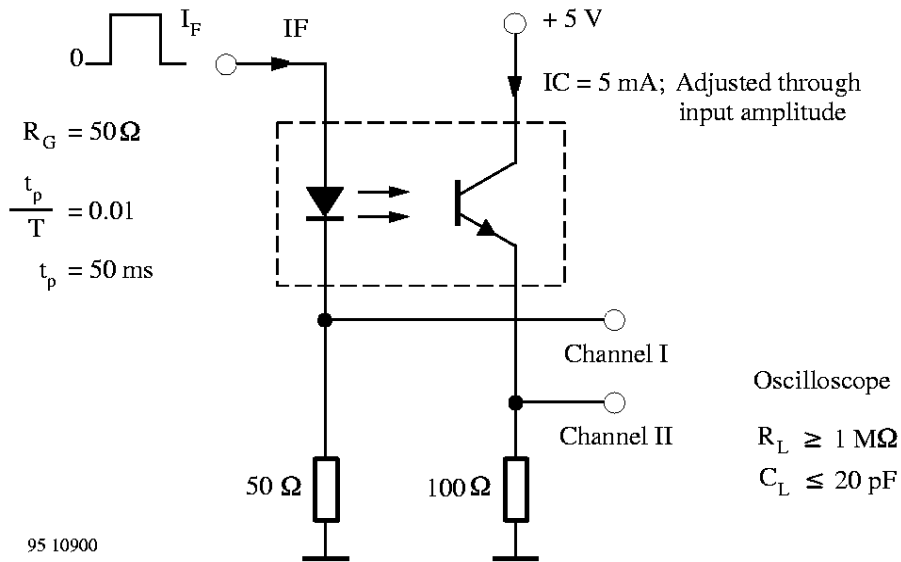

Figure 1. Test circuit, non-saturated operation

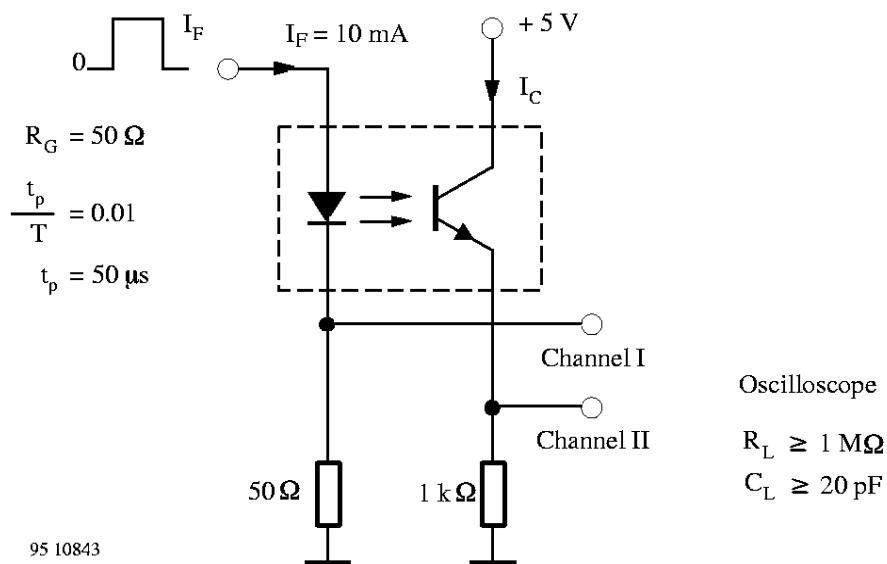

Figure 2. Test circuit, saturated operation

Insulation Rated Parameters (according to VDE 0884)

Parameters		Test Conditions	Symbol	Min.	Typ.	Max.	Unit
Partial discharge test voltage	Routine test	10% $t_{test} = 1s$	V_{pd}	2.8			kV
	Lot test (sample test)	$t_{Tr} = 10s$, $t_{test} = 60s$ (see figure 3)	V_{IOTM}	8			kV
			V_{pd}	2.2			kV
Insulation resistance		$V_{IO} = 500V$	R_{IO}	10^{12}			Ω
		$V_{IO} = 500V$, $T_{amb} = 100^{\circ}C$	R_{IO}	10^{11}			Ω
		$V_{IO} = 500V$, $T_{amb} = 180^{\circ}C$ (construction test only)	R_{IO}	10^9			Ω

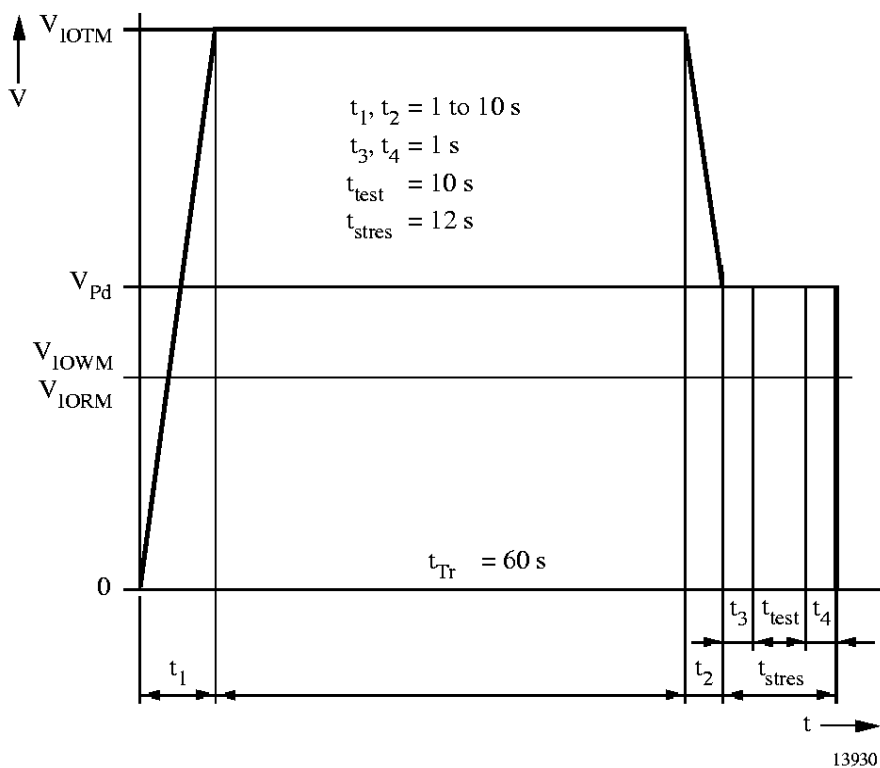

Figure 3. Test pulse diagram for sample test according to DIN VDE 0884

Typical Characteristics ($T_{amb} = 25^{\circ}\text{C}$, unless otherwise specified)

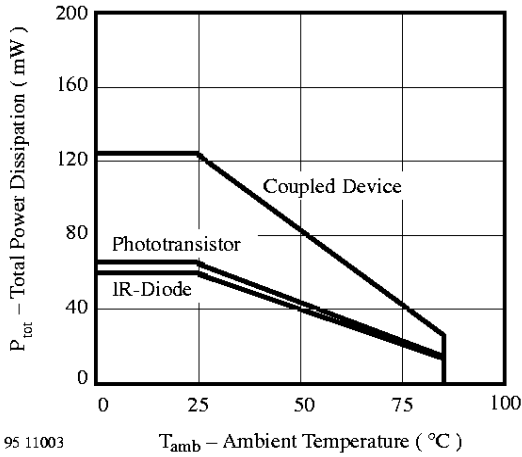

Figure 4. Total Power Dissipation vs. Ambient Temperature

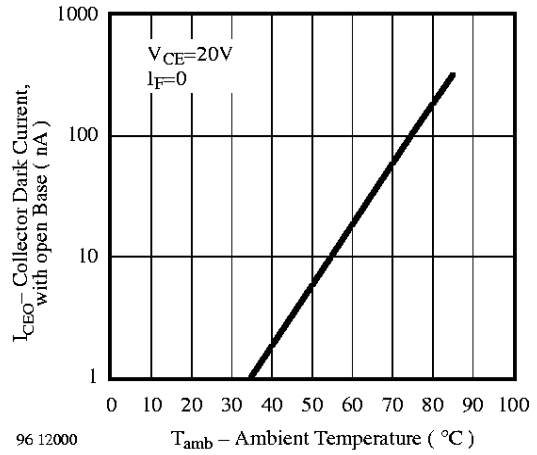

Figure 7. Collector Dark Current vs. Ambient Temperature

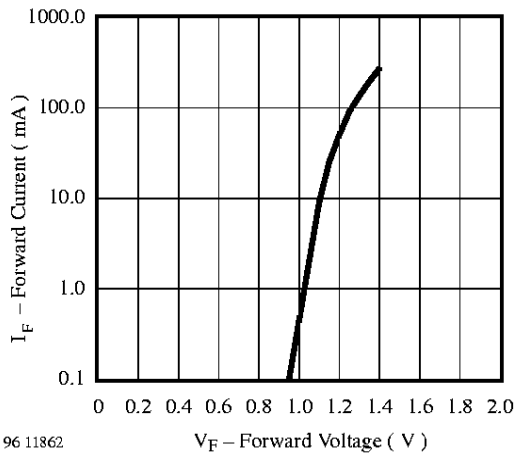

Figure 5. Forward Current vs. Forward Voltage

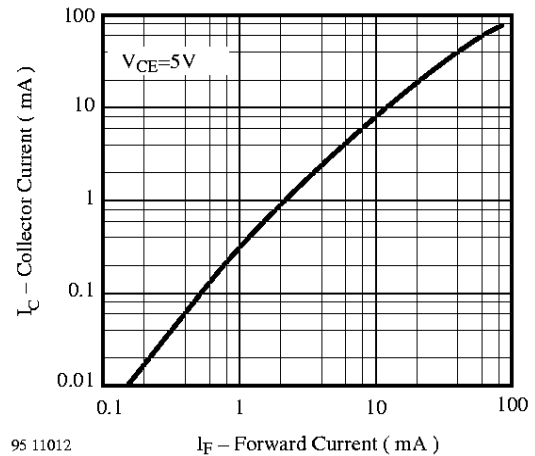

Figure 8. Collector Current vs. Forward Current

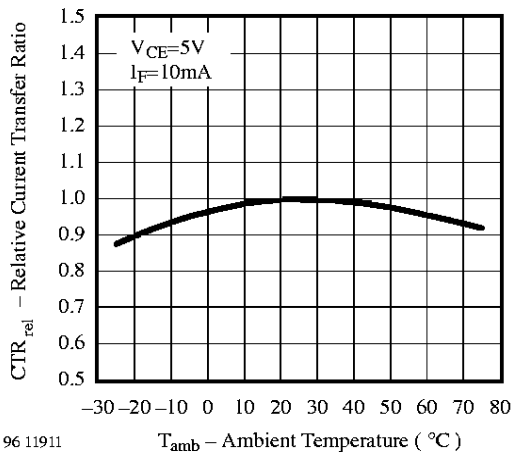

Figure 6. Rel. Current Transfer Ratio vs. Ambient Temperature

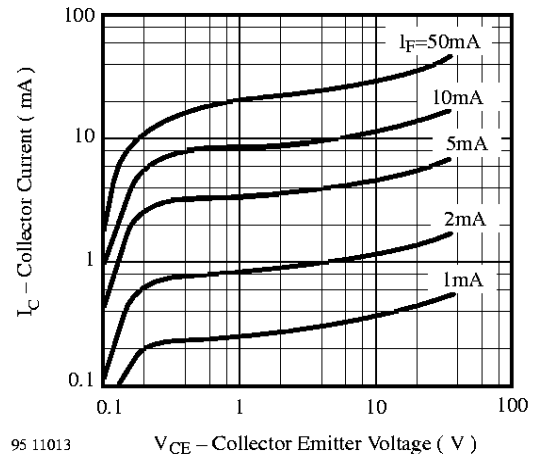

Figure 9. Collector Current vs. Collector Emitter Voltage

Typical Characteristics ($T_{amb} = 25^{\circ}\text{C}$, unless otherwise specified)

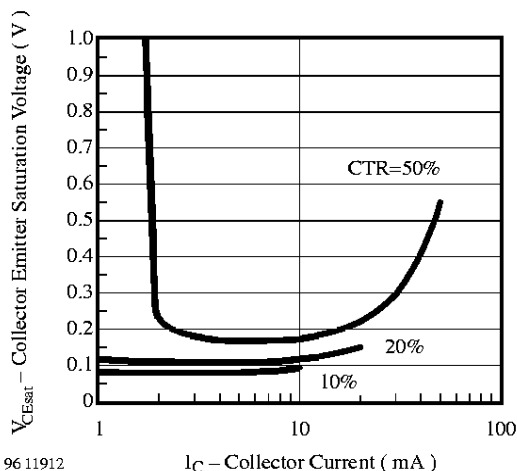

Figure 10. Collector Emitter Sat. Voltage vs. Collector Current

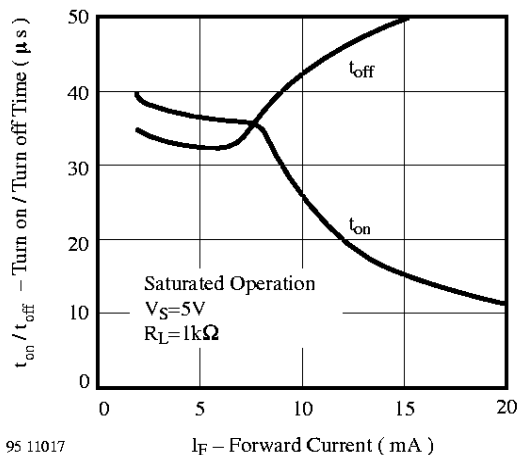

Figure 12. Turn on / off Time vs. Forward Current

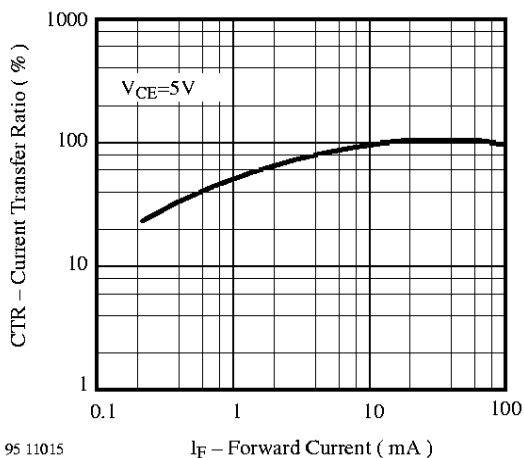

Figure 11. Current Transfer Ratio vs. Forward Current

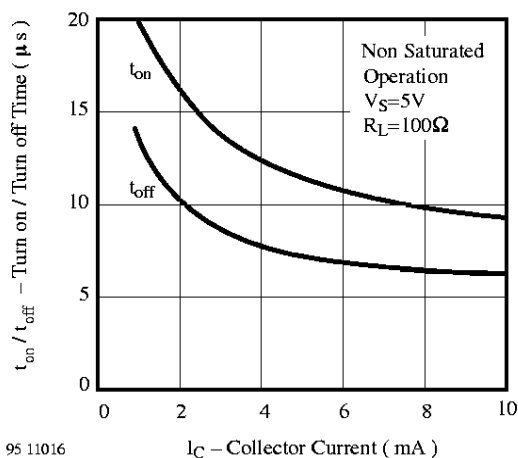
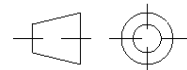
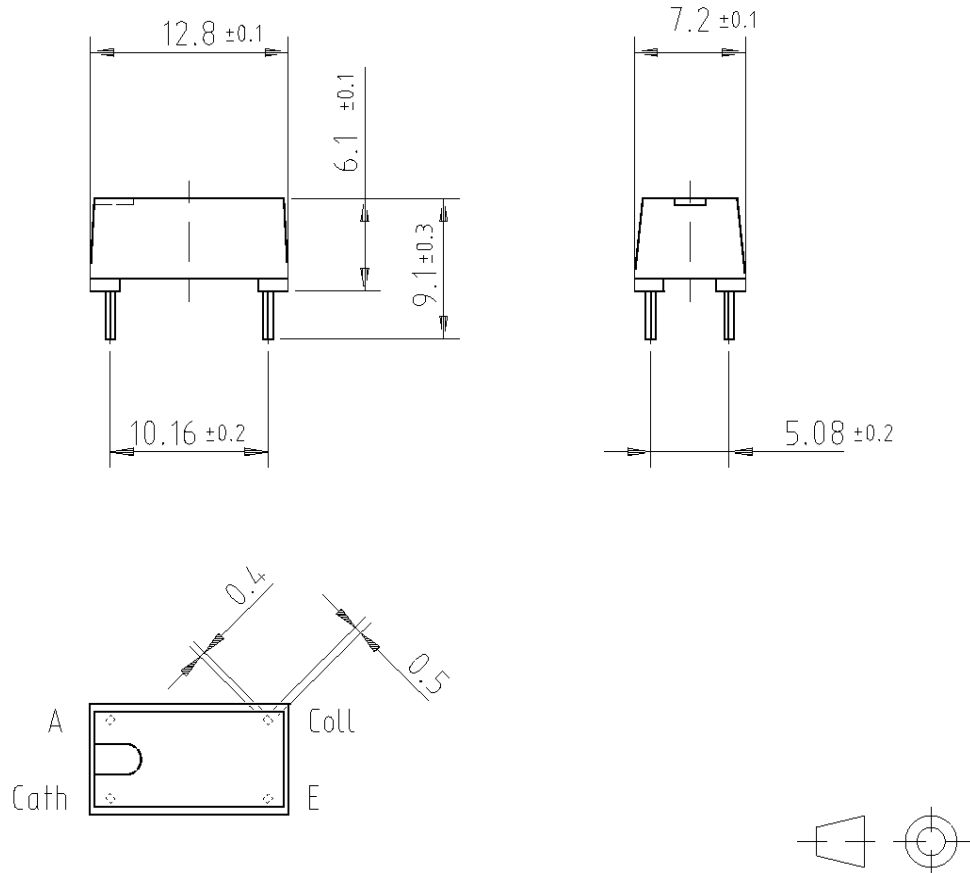

Figure 13. Turn on / off Time vs. Collector Current

Dimensions of CNY64 in mm



14765

technical drawings
according to DIN
specifications

weight: ca. 0.73 g
creeping distance: $\cong 9.5$ mm
air path: $\cong 9.5$ mm

after mounting on PC board

Dimensions of CNY65 in mm

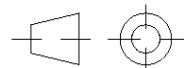
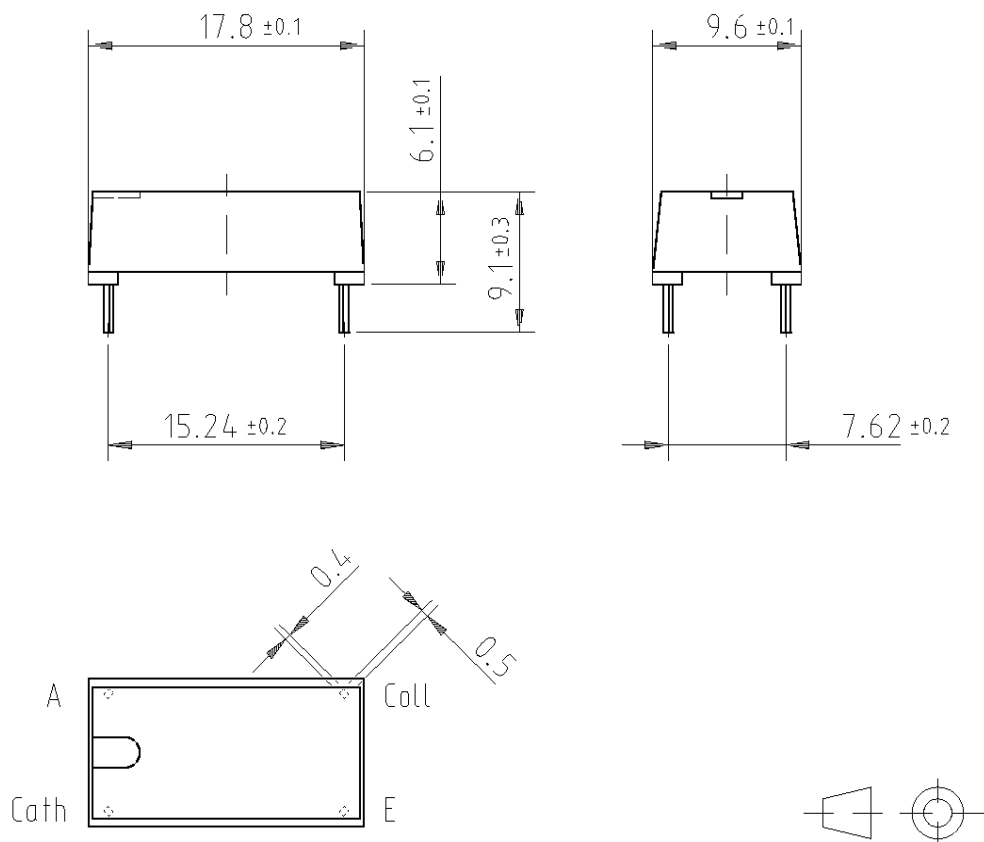

technical drawings
according to DIN
specifications

14763

weight: ca. 1.40 g
 creeping distance: ≥ 14 mm
 air path: ≥ 14 mm

after mounting on PC board

Dimensions of CNY66 in mm

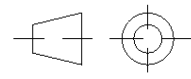
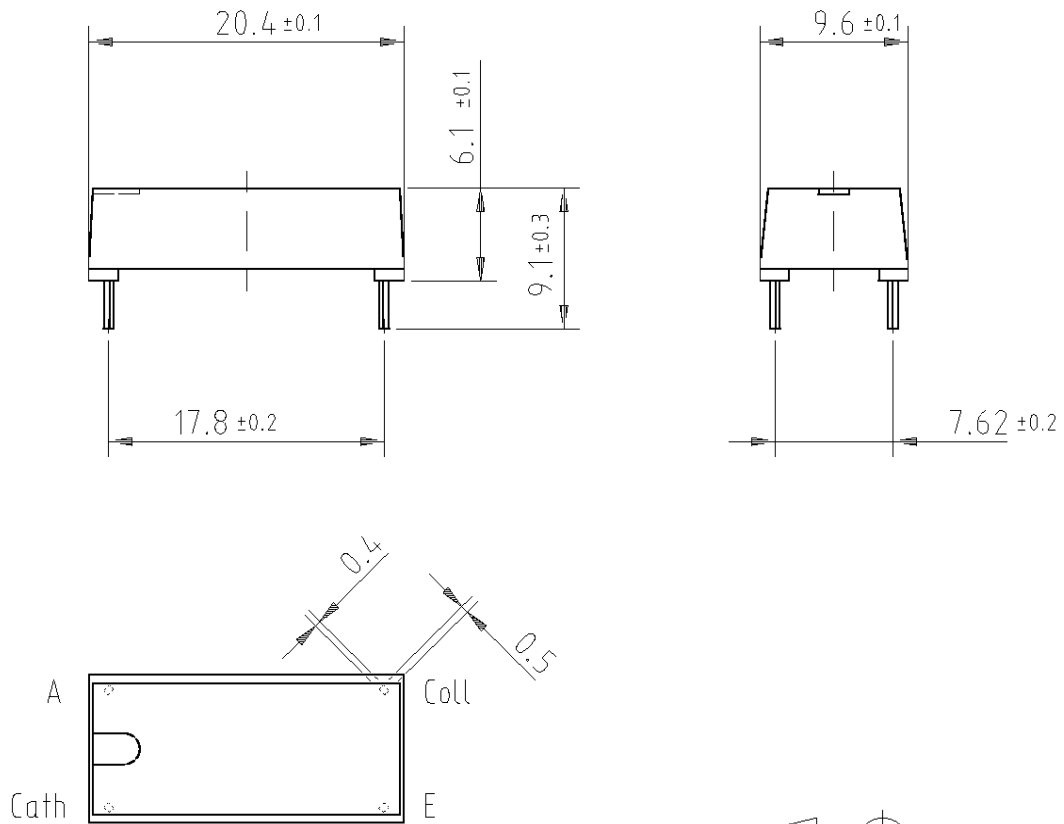

technical drawings
according to DIN
specifications

14764

weight: ca. 1.70 g
creeping distance: $\cong 17$ mm
air path: $\cong 17$ mm

after mounting on PC board

Ozone Depleting Substances Policy Statement

It is the policy of **TEMIC TELEFUNKEN microelectronic GmbH** to

1. Meet all present and future national and international statutory requirements.
2. Regularly and continuously improve the performance of our products, processes, distribution and operating systems with respect to their impact on the health and safety of our employees and the public, as well as their impact on the environment.

It is particular concern to control or eliminate releases of those substances into the atmosphere which are known as ozone depleting substances (ODSs).

The Montreal Protocol (1987) and its London Amendments (1990) intend to severely restrict the use of ODSs and forbid their use within the next ten years. Various national and international initiatives are pressing for an earlier ban on these substances.

TEMIC TELEFUNKEN microelectronic GmbH semiconductor division has been able to use its policy of continuous improvements to eliminate the use of ODSs listed in the following documents.

1. Annex A, B and list of transitional substances of the Montreal Protocol and the London Amendments respectively
2. Class I and II ozone depleting substances in the Clean Air Act Amendments of 1990 by the Environmental Protection Agency (EPA) in the USA
3. Council Decision 88/540/EEC and 91/690/EEC Annex A, B and C (transitional substances) respectively.

TEMIC can certify that our semiconductors are not manufactured with ozone depleting substances and do not contain such substances.

We reserve the right to make changes to improve technical design and may do so without further notice.

Parameters can vary in different applications. All operating parameters must be validated for each customer application by the customer. Should the buyer use **TEMIC** products for any unintended or unauthorized application, the buyer shall indemnify **TEMIC** against all claims, costs, damages, and expenses, arising out of, directly or indirectly, any claim of personal damage, injury or death associated with such unintended or unauthorized use.

TEMIC TELEFUNKEN microelectronic GmbH, P.O.B. 3535, D-74025 Heilbronn, Germany
Telephone: 49 (0)7131 67 2831, Fax number: 49 (0)7131 67 2423