

Model 77 Medium Power, 7/16 Connectors

dc to 6.0 GHz
25 Watts



Features

- /// Optimized for Wireless OEM & Test Applications.
- /// Low Intermodulation Design.
- /// Designed to meet environmental requirements of MIL-A-3933.

Specifications

NOMINAL IMPEDANCE: 50 Ω

FREQUENCY RANGE: dc to 6.0 GHz

MAXIMUM DEVIATION OVER FREQUENCY:

Nominal ATTN (dB)	Deviation (dB)
10, 20	± 0.70
30	± 1.20

MAXIMUM SWR:

Frequency (GHz)	SWR
dc - 3	1.20
3 - 6	1.30

3rd ORDER INTERMODULATION (77-XX-XX-LIM Only): Reflected Levels (IM3), -100 dBc and Through Levels (IM3), -110 dBc with two input signals @ 869 MHz and 891 MHz with average carrier power levels of +41 dBm each.

POWER RATING (mounted horizontally): 25 watts **average (unidirectional)** to 25°C ambient temperature, derated linearly to 2.5 watts @ 125°C. Maximum power rating into output is 10 watts **average**. 5 kilowatt **peak** (5 μsec pulse width; 0.25% duty cycle).

POWER COEFFICIENT: <0.002 dB/dB/watt

TEMPERATURE COEFFICIENT: <0.0004 dB/dB/°C

TEMPERATURE RANGE: -55 °C to 125 °C

TEST DATA: Swept data plots of SWR from 50 MHz to 6 GHz supplied.

CONNECTORS: 7/16 connector that conforms to DIN 47223, IEC 169-4, VG 95250, CECC 22 190.

Connector Options	Type/Description
1	7/16 Female
2	7/16 Male

CONSTRUCTION: Black, finned aluminum body, silver plated brass connectors

WEIGHT: 280 g (10 oz.) maximum

PHYSICAL DIMENSIONS:

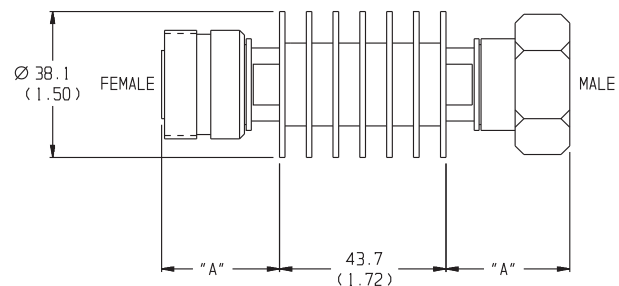

Connector	DIM A
7/16 Male	32.3 (1.27)
7/16 Female	30.7 (1.21)

NOTE: All dimensions are given in mm (inches) and tolerances are $XX \pm 0.8$ (0.03) unless otherwise specified.

MODEL NUMBER DESCRIPTION:

Example:

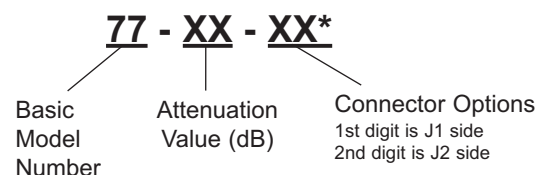

*Unit is bi-directional & full power may be applied to either J1 or J2.