

DRAWING NO  
C - 345713

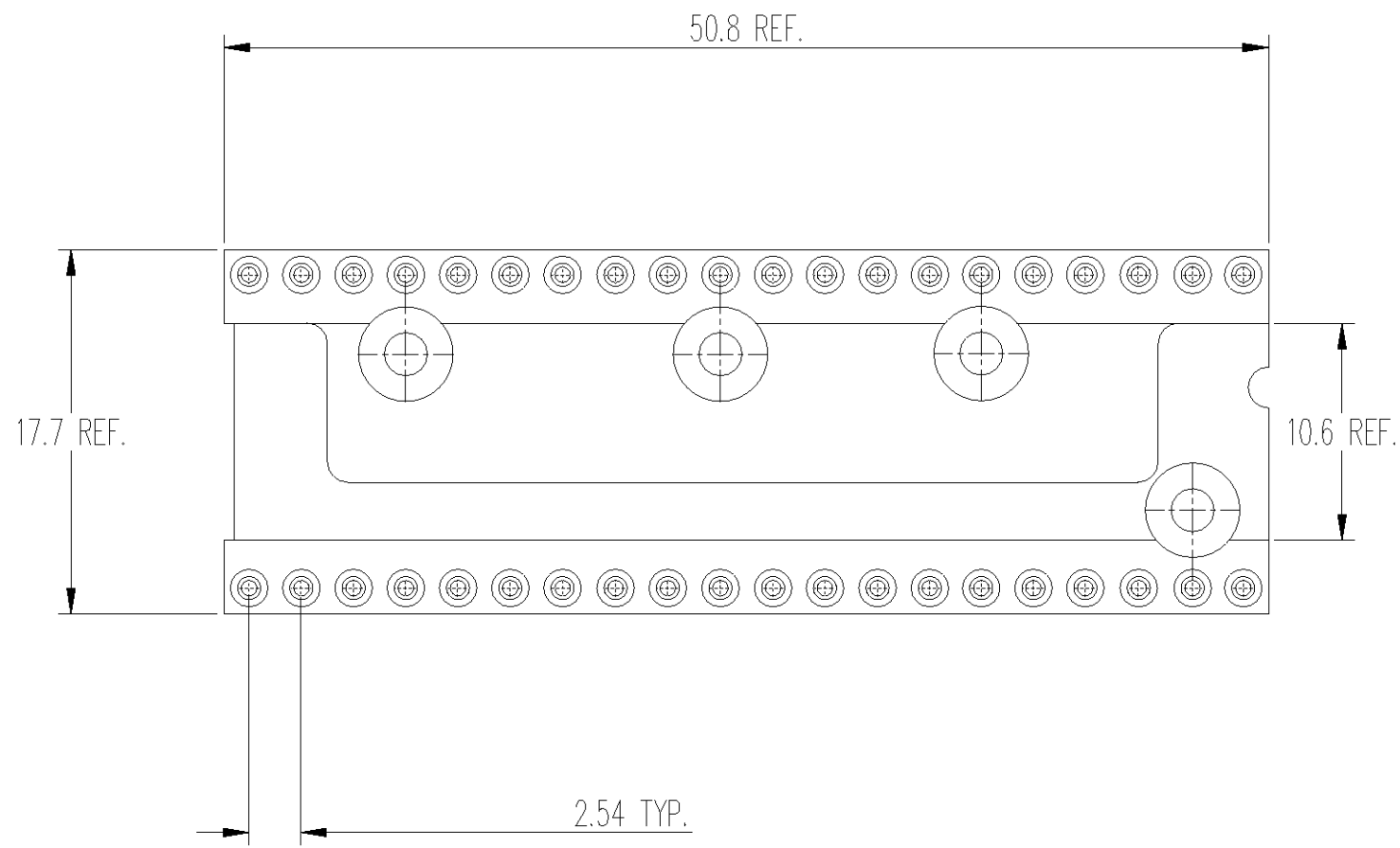
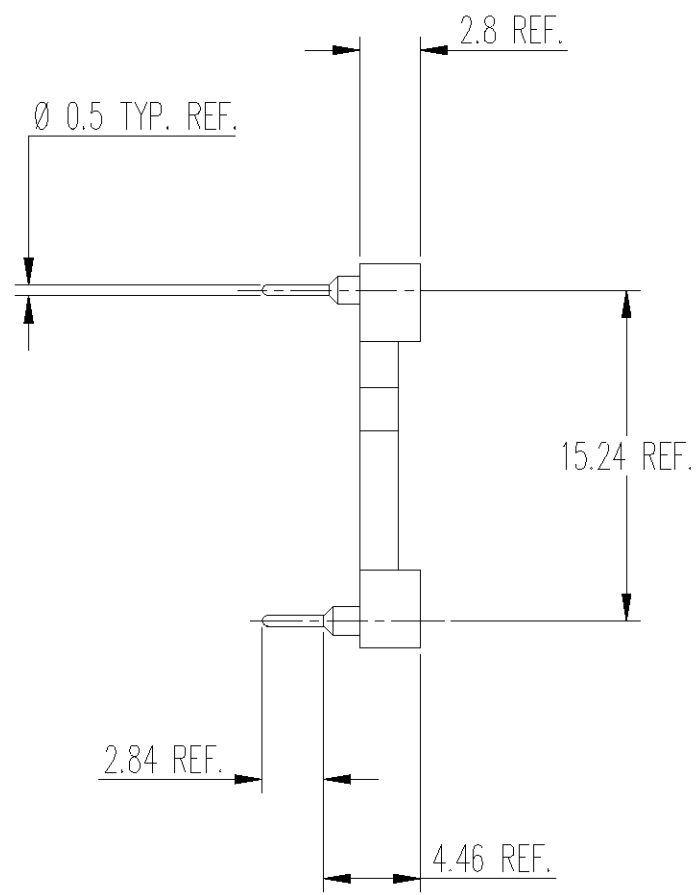

- NOTE :
- MATERIAL
    - INSULATOR : GLASSFILLED THERMOPLASTIC POLYESTER
    - SLEEVE : BRASS
    - CLIP : STAMPED BERYLLIUM COPPER
  - INNER SPRING CONTACT ACCEPT Ø 0.40 TO 0.56 OR RECTANGULAR PIN 0.25 x 0.45
  - MECHANICAL DATA WITH A Ø 0.43 TEST PIN :
    - INSERTION FORCE : 3.1N MAX.
    - EXTRACTION FORCE : 0.5N MIN.
    - MECHANICAL LIFE : 100 CYCLES MIN.

SOLDER TAIL PLATING	INNER CONTACT PLATING	DASH NUMBER	SOLDER TAIL PLATING	INNER CONTACT PLATING	DASH NUMBER
5µm Sn/Pb OVER 2-3µm Ni	0.25µm 18c. Au	-1	0.25µm Au OVER 2-3µm Ni	0.25µm 18c. Au	1- -1
	0.50µm 18c. Au	-2		0.50µm 18c. Au	1- -2
	0.75µm 18c. Au	-3		0.75µm 18c. Au	1- -3
	0.75µm 24c. Au	-4		0.75µm 24c. Au	1- -4
	5µm MIN. Sn/Pb	-5		0.1µm FLASH 24c. Au	1- -6
	0.1µm FLASH 24c. Au	-6			

DIMENSIONS	mm								DRAWN S.CHANDEVAVLT 24 MAR 98	THIS INFORMATION IS CONFIDENTIAL AND IS DISCLOSED TO YOU ON CONDITION THAT NO FUTHER DISCLOSURE IS MADE BY YOU TO OTHER THAN AMP PERSONNEL WITHOUT WRITTEN AUTHORIZATION FROM DSM SWITZERLAND.			
									CHECKED A. BOLIS				
SURFACE TEXTURE									APPROVED P.-A. MEIER 26 MAR 98	NAME			
CONCENTRICITY		0.15							CUSTOMER DRAWING	CLOSED FRAME .600" DIP IC SOCKET - 40 POS.			
PRODUCT SPEC.			P	REV	ECN	DRWN	DATE	APVD	FOR REFERENCE ONLY				
DSM DECOLLETAGE SA SAINT-MAURICE CH 1890 SAINT-MAURICE (VS)								LOC EK	SCALE 2/1	SIZE A4	DRAWING NO C - 345713	SHEET 1 of 1	REVISION B1

WAS 300-40-CC  
WAS DRAWING 345810