

Technical Data:

Material:

- Contact(metal housing): Brass Machined(option)
- Terminal screw: Steel galvanized and chromated
- Solder Pin: Brass with Tin plated
- Insulator body(housing): Polyamide(Glass filled)(UL94V-0)

Electrical

- Voltage rating: 300VAC
- Current rating: 20 Amps/way max
- Contact resistance: 20mΩ(max)
- Insulation resistance: 5000MΩ/1000V
- Withstanding Voltage: 2500VAC(1min) Test time=60sec/1pcs
- Wire range: 12-30AWG

Mechanical:

- Torque: 4kgf.cm/M3
- Operating temperature: -30°C to +120°C
- Soldering reliability:
Test temperature= 245°C±10°C
5 seconds max

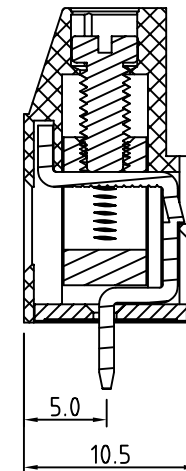
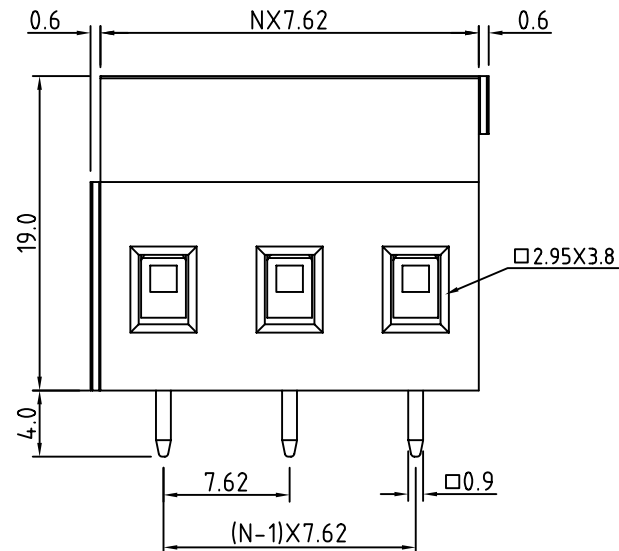
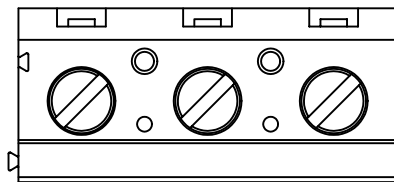

N=Number of contacts

P.C.B LAYOUT

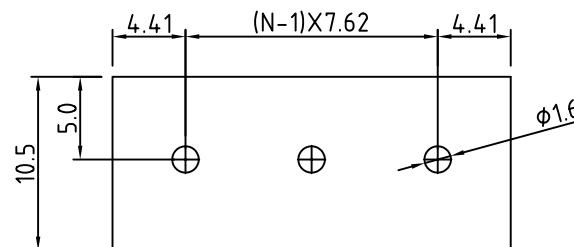

MORETHANALL
CONNECTORS
ASSEMBLIES

PART NO. TBH076-D19-xx

DWG NO. TBH076-D19-xx

APPROVED BY CY

TOLERANCES ARE

DESCRIP TION: 7.62mm SERIES 180° 02P ~ 24P

FILE NO.

DRAWING BY

.X ±0.30
.XX ±0.10
.XXX
AWG

煜倫有限公司

UNIT / mm

SCALE 1:1

PROJECTION

AREA

REVISIONS

HK

DATE