

20D-1C10N1-40

PCB Mount

PRODUCT DESCRIPTIONS



The 20D-1C□0N1-40 is one of 20D 1 Form C series. Non electrostatic shield configuration provides cost effectiveness, and design flexibility for wide range of applications including OEM designs.

- De Facto Standard 1 Form C
- 5.0V/12.0V Coil
- Low Power Consumption / Higher Coil Resistance
- Breakdown Voltage 1500V (Between Contacts to Coil)

SPECIFICATIONS



20D 1 Form C Series		20D-1C□0N1-40		
Parameters	Units	1 Form C		Test Conditions
Coil Specifications				
Nominal Coil Voltage	VDC	5.0	12.0	
Coil Resistance	Ω	230	1500	±10% @ 20°C
Operate Voltage	VDC Max	3.75	8.8	@ 20°C
Release Voltage	VDC Min	0.7	1.2	@ 20°C
Contact Ratings				
Switching Voltage	Volts	100		Max DC/Peak AC resistance
Switching Current	Amps	0.25		Max DC/Peak AC resistance
Carry Current	Amps	0.5		Max DC/Peak AC resistance (@ 30°C)
Contact Rating	Watts	3		Max DC/Peak AC resistance
Life Expectancy	x10 ⁶ Cycle	100		@ 1V 10mA
Contact Resistance	mΩ	150		Max initial @ operate voltage
Contact Resistance Stability	mΩ	5.0		Max initial @ operate voltage
Relay Specifications				
Insulation Resistance	Ω Min	10 ¹¹		Between Contacts
	Ω Min	10 ¹¹		Contacts to coil @ 100V 20°C 65%RH
Dielectric Strength (Static)	VDC Min	200		Between contacts
	VDC Min	1500		Contacts to coil
Operate Time (Including Bounce)	msec Max	1.0		@ nominal coil voltage 30 Hz square wave
Release Time	msec Max	2.0		Diode suppression
Measurement Reference Conditions			Environmental Ratings	
Temp: 15°C to 35°C Humidity: 25% to 75%RH Atmospheric Pressure: 860 to 1060hpa			Storage temp: -35°C to +100°C Operate temp: -20°C to +85°C Vibration: 20G's to 2000Hz Shock: 50G's	

Ordering Code:

20D-1C□0N1-40

□=1 (5.0VDC), 2(12.0VDC)

Dimensions All Dimensions are mm (inch)

Schematic <Top View>

20D-1C□0N1-40

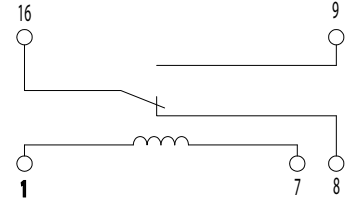
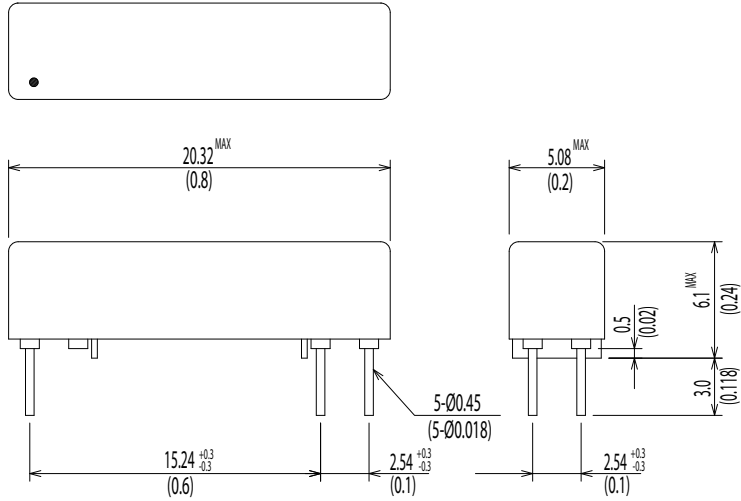

Relay Socket Part Number: SX-5-□.□

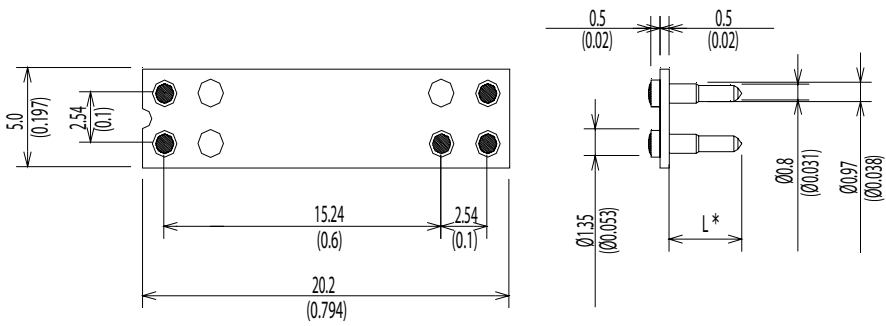

Ordering Code:

SX-5-□.□

□.□ = 1.6(*3.3mm), 3.2(*4.0mm), 4.8(*5.3mm)