

SMB Connectors, 75 Ohm BT 43

Features

- Widely used in data transmission and telecommunication applications
- BT 43 connector developed from the SMB range and feature snap-on and latching variant
- Most BT 43 connectors are available as fully crimped connectors.
- BT 43 and 75 Ω connectors available in solder and crimp versions

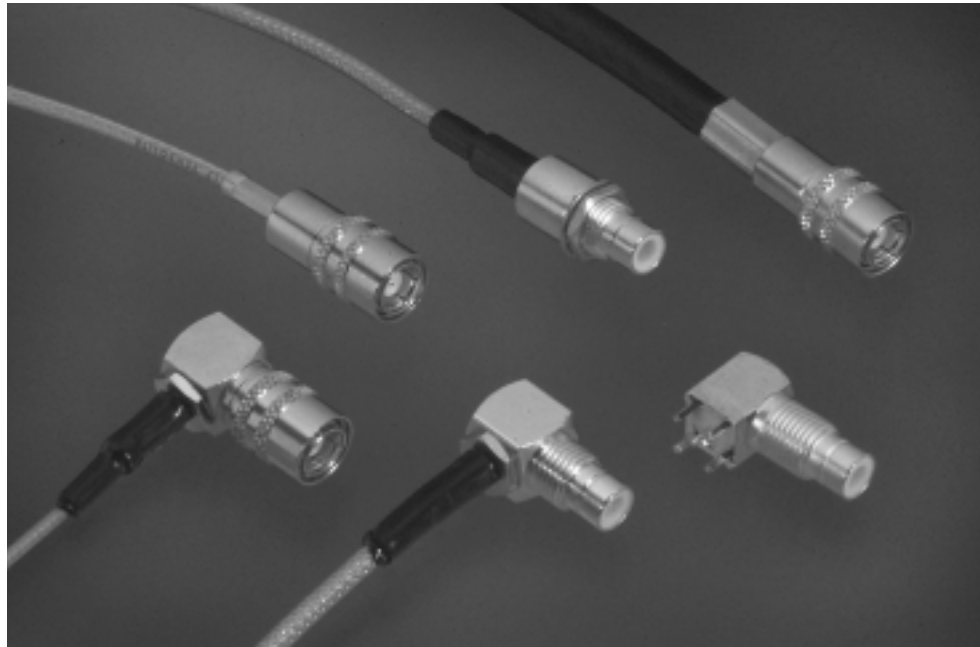

The AMP range of 75 ohm SMB (SMZ) connectors are designed to meet the increasing demands of the Telecommunications market, and are designed in accordance with BS9210 F0022.

Specifications

- Max working voltage (dc)** — 500 V
- Max proof voltage (dc)** — 1.5 kV
- Contact resistance (inner)** — 5 milliohm
- Contact resistance (outer)** — 1 milliohm
- Bodies and other parts** — Brass

Female center contacts — Copper Alloy

Male center contacts — Copper Alloy

Outer contacts — BeCu

Plating — Contacts and critical surfaces — Gold
Other parts — Nickel

Insulators — P.T.F.E.

SMB Connectors, 75 Ohm BT 43 (Continued)

Straight Socket, Snap-On

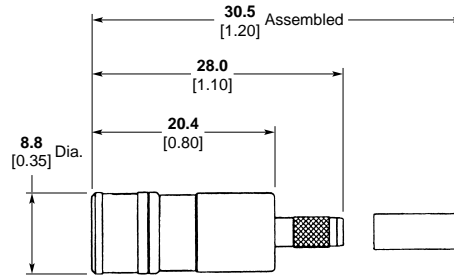

Cable Type	Termination Method		Body Plating	M/A-COM Model No.	Part No.
	Inner	Outer			
RG179B/U	Solder	Crimp	Selective Gold	B67A53T022X	1408053-1
RG179B/U	Crimp	Crimp	Selective Gold	B67A54T022X	1311097-1
BT3002, TZC75024	Crimp	Crimp	Selective Gold	B67A54T437X	1361579-1
BT2002	Crimp	Crimp	Selective Gold	B67A54T117X	1311098-1

Straight Socket, Latching, Crimp/Crimp

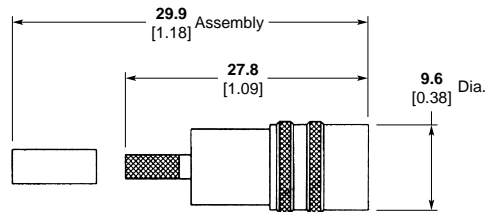

Cable Type	Body Plating	M/A-COM Model No.	Part No.
RG179B/U	Selective Gold	B67A64T022X	1311099-1
BT2003	Selective Gold	B67A64T062X	1311100-1
BT2002	Selective Gold	B67A64T117X	1311101-1
BT2001	Selective Gold	B67A64T280X	1311696-1
BT3002, TZC75024	Selective Gold	B67A64T437X	1311102-1
RG59B/U, RG140/U, URM90	Selective Gold	B67A64TA25X	1313507-1

Straight Socket, Latching, Solder/Crimp

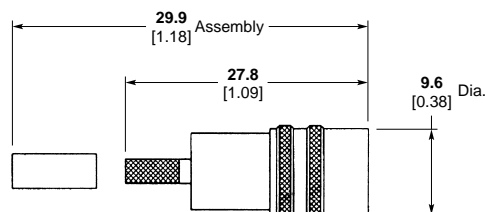

Cable Type	Body Plating	M/A-COM Model No.	Part No.
RG179B/U	Selective Gold	B67A44T022X	1312112-1
BT2003	Selective Gold	B67A44T062X	1314669-1
BT2002	Selective Gold	B67A44T117X	1312113-1



RF Coax Connectors

SMB Connectors, 75 Ohm BT 43 (Continued)

Right Angle Socket, Snap-On, Solder/Crimp

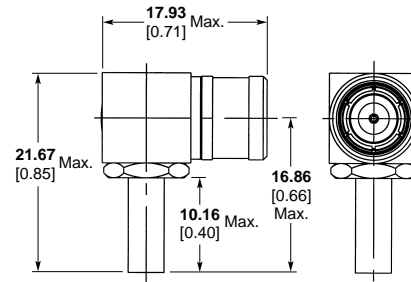

Cable Type	Body Plating	M/A-COM Model No.	Part No.
RG179B/U	Selective Gold	B67B42T022X	1311103-1
BT3002, TZC75024	Selective Gold	B67B42T437X	1311104-1
BT2002	Selective Gold	B67B42T117X	1314675-1

Right Angle Socket, Latching, Solder/Crimp

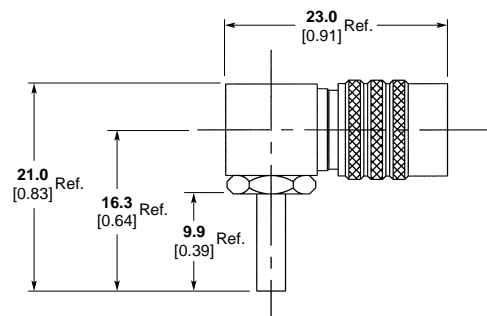

Cable Type	Body Plating	M/A-COM Model No.	Part No.
RG179B/U	Selective Gold	B67B44T022X	1311106-1
BT2003	Selective Gold	B67B44T062X	1311698-1
BT2002	Selective Gold	B67B44T117X	1311108-1
BT3002, TZC75024	Selective Gold	B67B44T437X	1311111-1
3M: 043, 031C, CS4456, Gore: GCX	Selective Gold	B67B44T693X	1328162-1
RG59B/U, RG140/U	Selective Gold	B67B44TA25X	1313508-1

Straight Free Plug, Crimp/Crimp

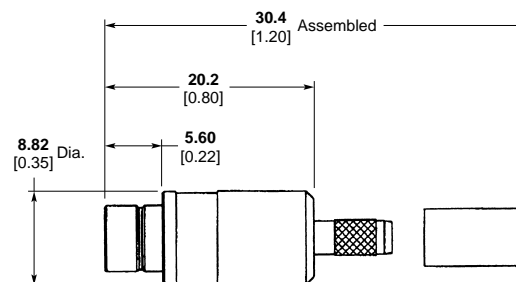

Cable Type	Body Plating	M/A-COM Model No.	Part No.
RG179B/U	Selective Gold	B67E64T022X	1408041-1



RF Coax Connectors

SMB Connectors, 75 Ohm BT 43 (Continued)

Straight Bulkhead Plug

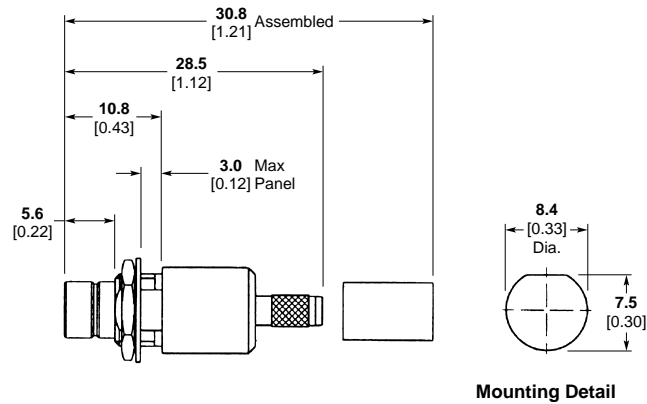

Cable Type	Termination Method		Body Plating	M/A-COM Model No.	Part No.
	Inner	Outer			
RG179B/U	Solder	Crimp	Selective Gold	B67H46T022X	1312370-1
BT2002	Solder	Crimp	Selective Gold	B67H46T117X	1311114-1
RG179B/U	Crimp	Crimp	Selective Gold	B67H66T022X	1311120-1
BT500B, BT2003, BT2003A	Crimp	Crimp	Selective Gold	B67H66T062X	1311701-1
BT2002	Crimp	Crimp	Selective Gold	B67H66T117X	1311121-1
BT3002, TZC75024	Crimp	Crimp	Selective Gold	B67H66T437X	1311122-1

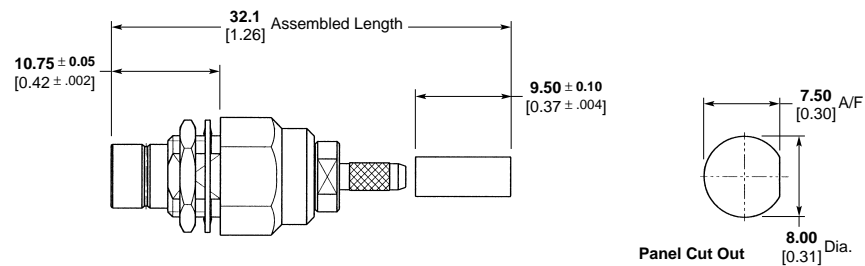

Cable Type	Termination Method		Body Plating	M/A-COM Model No.	Part No.
	Inner	Outer			
3M: 043, 031C, CS4456, Gore: GCX	Crimp	Crimp	Selective Gold	B67H16T493X	1313511-1

Right Angle Bulkhead Plug, Solder/Crimp

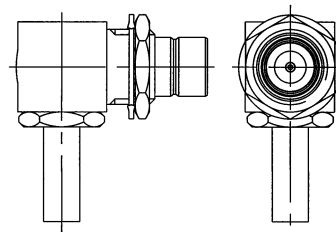

Cable Type	Body Plating	M/A-COM Model No.	Part No.
RG179B/U	Selective Gold	B67H49T022X	1311115-1
BT2002	Selective Gold	B67H49T117XP2	1314694-1



RF Coax Connectors

SMB Connectors, 75 Ohm BT 43 (Continued)

DDF Plug, Crimp/Crimp

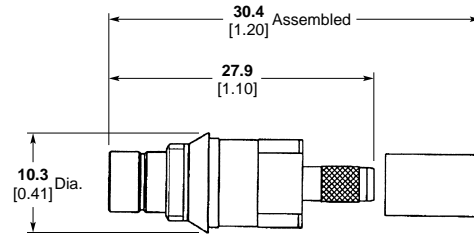

Cable Type	Body Plating	M/A-COM Model No.	Part No.
RG179B/U	Selective Gold	B67H64T022X	1327083-1
BT2003	Selective Gold	B67H64T062X	1311117-1
BT2002	Selective Gold	B67H64T117X	1311700-1
B2001	Selective Gold	B67H64T280X	1313883-1
BT3002, TZC75024	Selective Gold	B67H64T437X	1311118-1
RG59B/U, RG140/U, URM90	Selective Gold	B67H64TA25X	1313887-1

DDF Plug, Crimp/Crimp

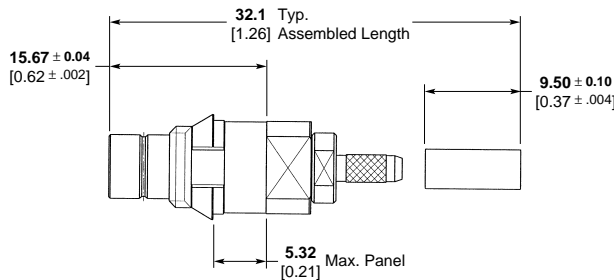

Part No. 1313512-1

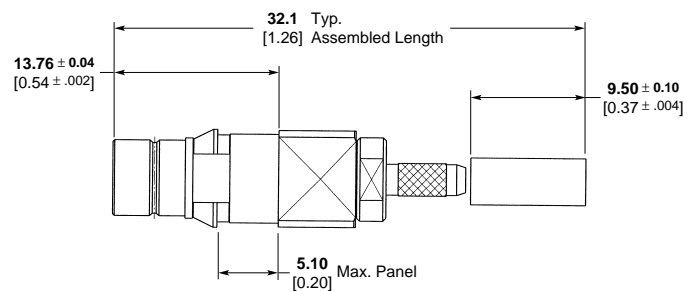

Part No. 1311699-1

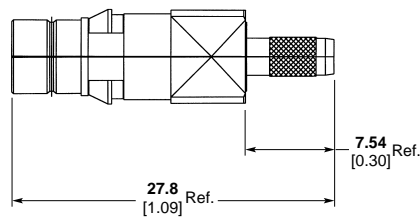

Part No. 1314422-1

Cable Type	Body Plating	M/A-COM Model No.	Part No.
3M: 043, 031C, CS4456, Gore: GCX	Selective Gold	B67H14T493	1313512-1
3M: 043, 031C, CS4456, Gore: GCX	Selective Gold	B67H15T493	1311699-1
RD179, 124431 (Filotex), 1366 (Orebro), K02253D-1, K02253-2 (Shuner)	Selective Gold	B67H74T463X	1314422-1

SMB Connectors, 75 Ohm BT 43 (Continued)

**Right Angle PCB Socket,
Bulkhead Mount**

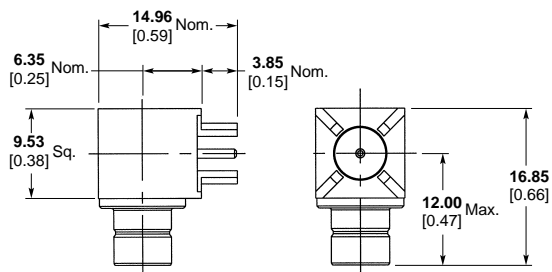

Body Plating	M/A-COM Model No.	Part No.
Selective Gold	B67N25T999X	1314102-1
Selective Gold	B67N10T999X	1311126-1

PCB Plug 43/1D

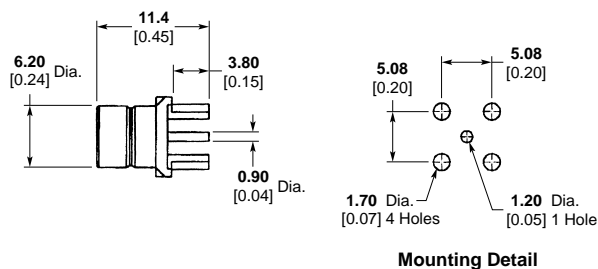

Body Plating	M/A-COM Model No.	Part No.
Selective Gold	B67N08T999X	1311125-1

PCB Plug 43/1E

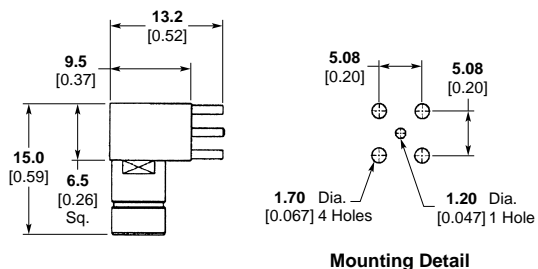

Body Plating	M/A-COM Model No.	Part No.
Selective Gold	B67N12T999X	1314103-1



RF Coax Connectors

SMB Connectors, 75 Ohm BT 43 (Continued)

Straight Adapter Plug-Plug

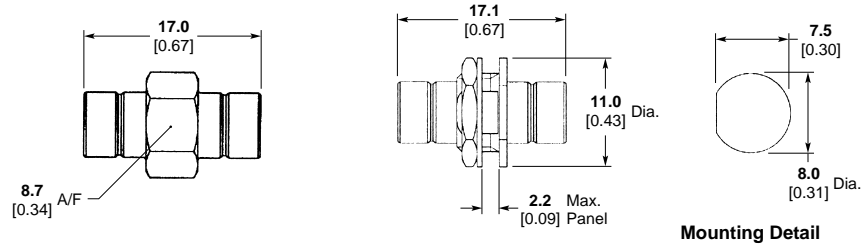

Part No. 1313364-1

Part No. 1311127-1

Body Plating	M/A-COM Model No.	Part No.
Selective Gold	1B67P34G999X	1313364-1
Selective Gold	2B67R53G999X	1311127-1

BT 43 Socket Termination 75 ohm



Body Plating	M/A-COM Model No.	Part No.
Selective Plating	B67Z41T999X	1311702-1

Tester 430A

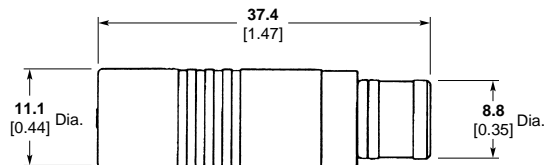

Body Plating	M/A-COM Model No.	Part No.
Selective Plating	B67Z50T999X	1311703-1

Extraction Tool 65A

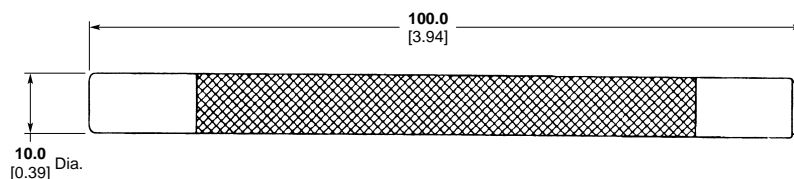

M/A-COM Model No.	Part No.
127669-92	1311164-1