

Connectors

SMM Microminiature Receptacles Panel · Bulkhead · Printed Circuit

Straight Flange Mount Female Jack Receptacle - 4 Hole

Model Number

SMM-5819-15-TRM-00

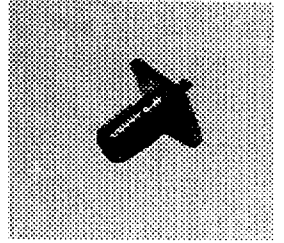
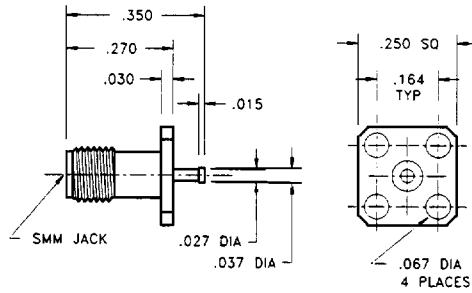

Note: Standard finish is gold plating, for passivated stainless steel change -00 suffix to -02.

Straight Bulkhead Feedthru Female Jack Receptacle- Rear Mount

Model Number

SMM-5019-11-TRM-00

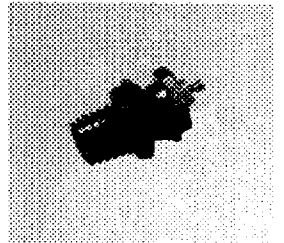
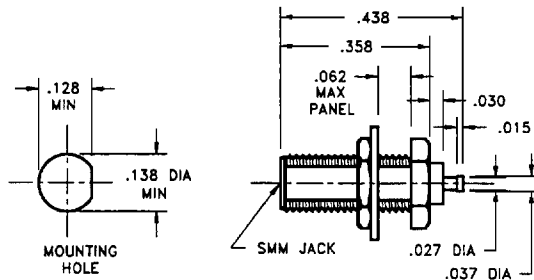

Note: Standard finish is gold plating, for passivated stainless steel change -00 suffix to -02.

Straight Printed Circuit Board Mount Female Jack Receptacle

Model Number

SMM-5010-93-PCB-00

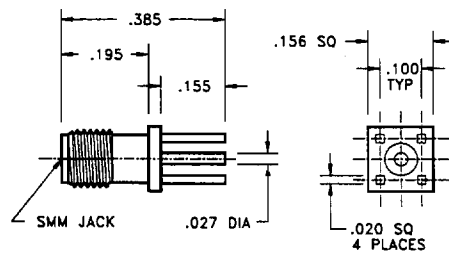

Note: Standard finish is gold plating for direct soldering to printed circuit board.

Right Angle Printed Circuit Board Mount Female Jack Receptacle

Model Number

SMM-5010-94-PCB-00

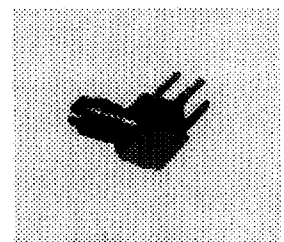
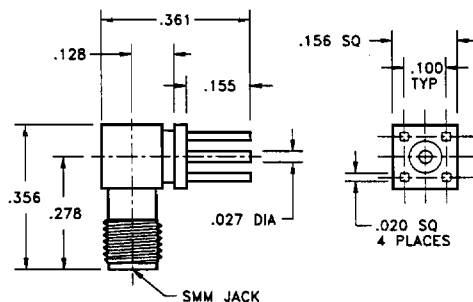

Note: Standard finish is gold plating for direct soldering to printed circuit board.