

A Series Crystal



- **RoHS Compliant Available**
- **Wide Frequency Range**
- **AT Cut**
- **Resistance Weld**



Frequency Range	1.8432MHz to 160.000MHz max
Frequency Tolerance / Stability	(See Part Number Guide for Options)
Operating Temperature Range	(See Part Number Guide for Options)
Storage Temperature	-55°C to +125°C
Aging	±5ppm / first year Max
Shunt Capacitance	7pF Max
Load Capacitance	20pF Standard (See Part Number Guide for Options)
Equivalent Series Resistance	See ESR Chart
Mode of Operation	Fundamental, 3 rd OT or 5 th OT
Drive Level	2mW Max

Environmental & Mechanical Detail

Shock	MIL-STD-883, Method 2002 Cond B
Solderability	MIL-STD-883, Method 2003
Solvent Resistance	MIL-STD-202, Method 215
Vibration	MIL-STD-883, Method 2007, Cond A
Gross Leak Test	MIL-STD-883, Method 1014, Cond C
Fine Leak Test	MIL-STD-883, Method 1014, Cond A2
MSL	Level 1 per IPC/JEDEC J-STD 20

ESR Chart

Frequency Range	ESR (Ohms)	Mode / Cut
1.8432MHz to 1.999MHz	800 Max	Fund / AT
2.000MHz to 2.399MHz	550 Max	Fund / AT
2.400MHz to 2.999MHz	350 Max	Fund / AT
3.000MHz to 3.199MHz	250 Max	Fund / AT
3.200MHz to 3.499MHz	200 Max	Fund / AT
3.500MHz to 3.599MHz	150 Max	Fund / AT
3.600MHz to 3.999MHz	120 Max	Fund / AT
4.000MHz to 4.999MHz	100 Max	Fund / AT
5.000MHz to 5.999MHz	70 Max	Fund / AT
6.000MHz to 40.000MHz	40 Max	Fund / AT
24.000MHz to 75.000MHz	40 Max	3 rd OT / AT
75.001MHz to 160.000MHz max	100 Max	5 th OT / AT

Part Number Guide

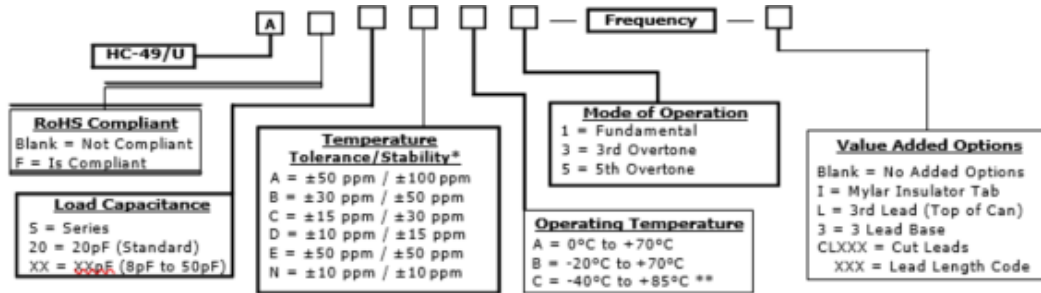

* Please consult with MMD sales department for any other parameters or options.
 ** Not all Frequency Tolerance/Stability options available at this temperature range.

Mechanical Details

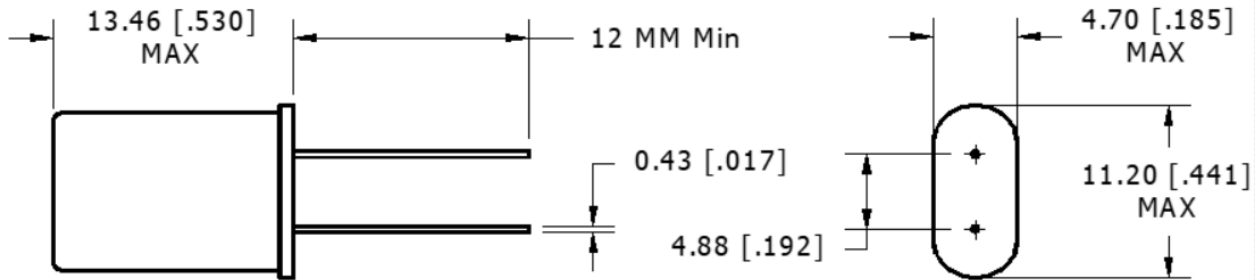

DIMENSIONS IN BRACKETS ARE IN INCHES

3 Lead Base

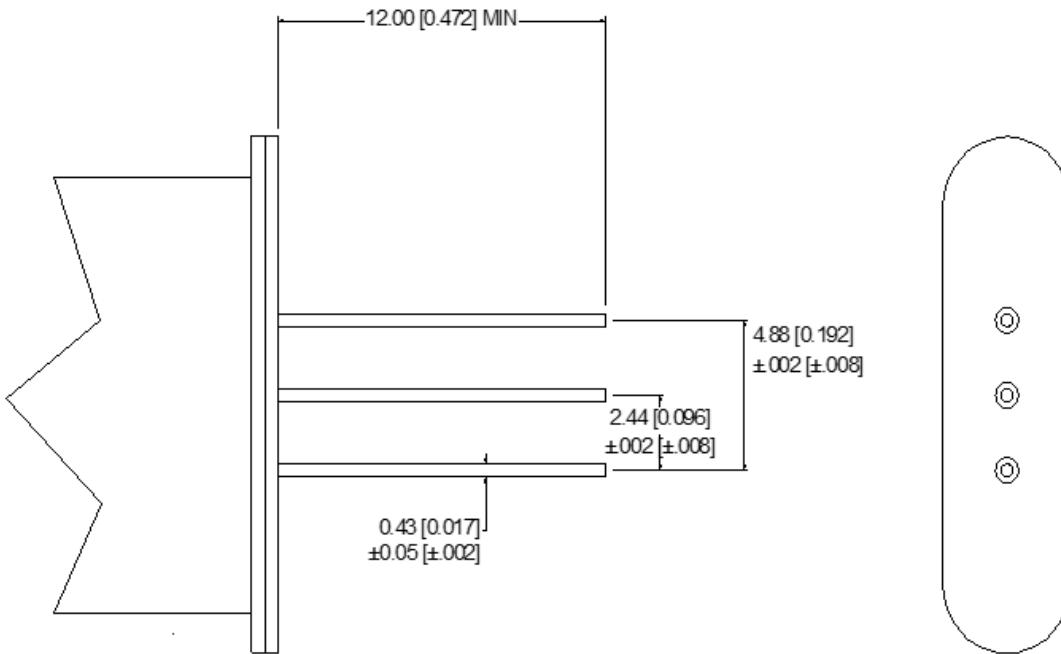

Note: This drawing is intended for lead dimension only. Please refer to the appropriate MMD Spec Sheet for additional package dimensions.