

Receptacle (Right Angle)



- Panel mount I/O receptacle
- Ribbon type contact —proven performing contact and won't bend and break
- Excellent EMI protection
- Available with ground lock feature
- Current rating 0.5 amp
- Easy to use latching system

Physical

Insulation Material : Glass Reinforced Polyester U.L 94V-0 (Black)
Contact Material : Copper Alloy
Contact Plating : Selective Gold Plating
Shroud Material : Steel
Shroud Plating : Nickel
Lock Stand Material : Zinc
Lock Stand Plating : Nickel

Electrical

Current Rating : 0.5 Amp
Insulation Resistance : >500 M Ohms
Withstanding Voltage : 500V RMS for 1 minute

Environmental

Temperature Rating : -55°C~85°C

Ordering Information

102XX—52□2○○

- ▶ Plating Thickness Suffix
VC = 0.76 μ m Min. Gold selective plating
VE = 0.5 μ m Min. Gold selective plating
JL = 0.3 μ m Ave. Gold selective plating
- ▶ Solder Tail Length
2 = 3.9mm
- ▶ Retention Feature
0 = Screw Lock (M2.6)
1 = Screw Lock (M2.5)
A = Ground Lock (M2.6)
B = Ground Lock (M2.5)
- ▶ Pin Configurations
5 = Right Angle
- ▶ Contact Quantity
14 - 100
(A0 = 100 pos.)

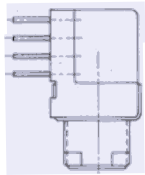

Screw Lock
(-5202, -5212)

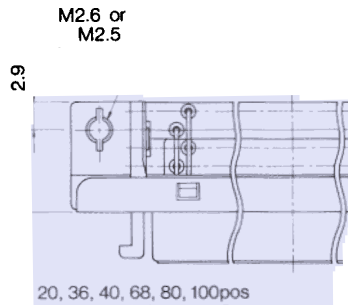

row
row/

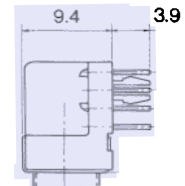

M2.6
or M2.5

Ground Lock
(-52A2, -52B2)

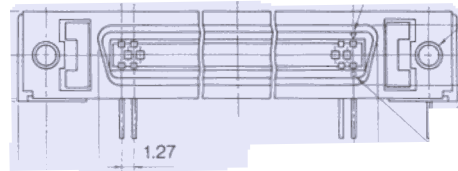

A
D
B
C

Recommended Panel Cut-out

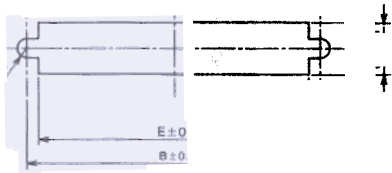

Thickness: mm Max. include W

Recommended Hole Pattern
(Viewed from connector side)

[Note: Screw Lock ϕ 2.8
Ground Lock ϕ 2.6]

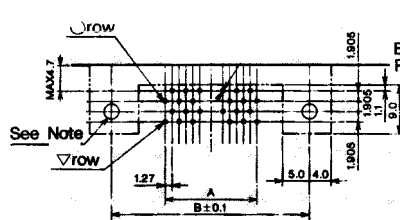

14P, 26P, 50P

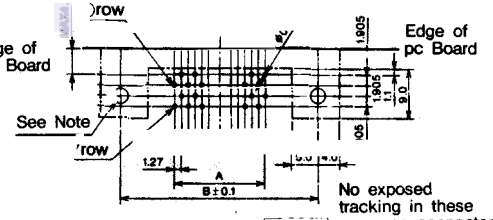

20P, 36P, 40P, 68P, 80P, 100P

Contact QTY	Part Number	A	B	C	D	E
14	10214-52□2○○	7.62	23.64	29.5	12.6	19.9
20	10220-52□2○○	11.43	27.45	33.4	16.4	23.8
26	10226-52□2○○	15.24	31.26	37.2	20.2	27.6
36	10236-52□2○○	21.59	37.61	43.5	26.6	33.9
40	10240-52□2○○	24.13	40.15	46.1	29.1	36.5
50	10250-52□2○○	30.48	46.50	52.4	35.5	42.8
68	10268-52□2○○	41.91	57.93	63.8	46.9	54.2
80	10280-52□2○○	49.53	65.55	71.5	54.5	61.9
100	102A0-52□2○○	62.23	78.25	84.2	67.2	74.6