

PLCC-SMD Socket 1,27 mm

Series

082

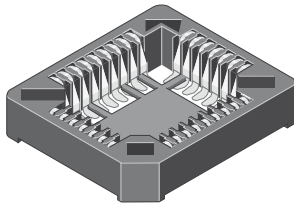

Rated current	1,0 A
Rated voltage	100 V _{RMS} / V _{DC}
Withstand voltage	600 V _{RMS} for 1 minute
Material contact	Phosphor bronze
Material insulator	High temp. thermoplast UL94V-0
Operating temperature	-40°C to +85°C
Max. processing temper.	260°C for 10 seconds

pitch	1,27
termination	
max. pincount	084

All dimensions in mm.

Variation

Removal Tool

086

PCB Layout

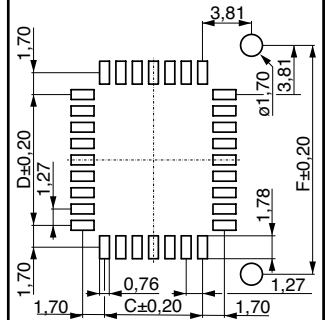
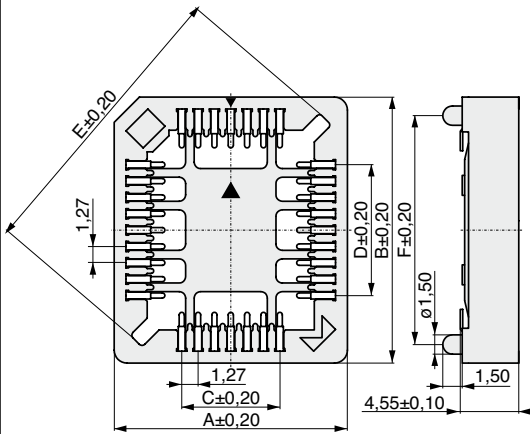
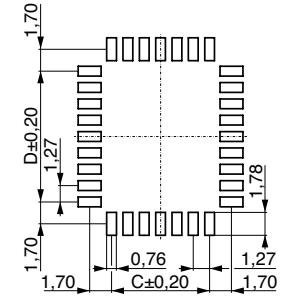
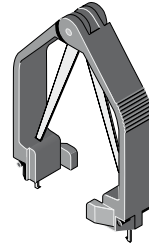
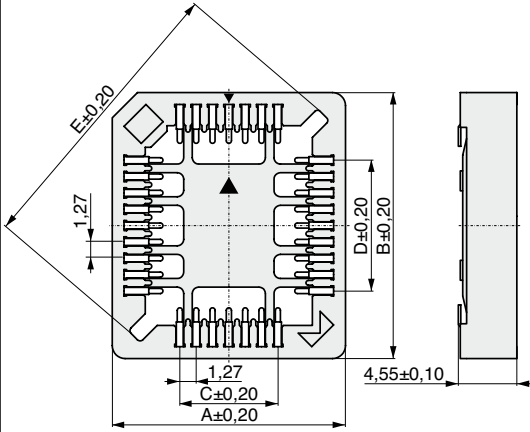

086-1-00

n	no. of contacts						available in variation
	A	B	C	D	E	F	
020	15,24	15,24	5,08	5,08	16,70	12,70	1 2
028	17,78	17,78	7,62	7,62	20,30	15,24	1 2
032	17,78	20,32	7,62	10,16	22,50	17,78	1 2
044	22,86	22,86	12,70	12,70	27,50	20,32	1 2
068	30,82	30,82	20,32	20,32	38,30	27,94	1 2
084	35,90	35,90	25,40	25,40	45,50	33,02	1 2

Colour:
0 = Black
7 = Brown

Packaging:
R = Reel
T = Tube

Variation (1,2)

No. of contacts

Colour

Packaging (R,T)

Order code:

082-?-?222-?-?-X0



www.mpe-connector.de

Product group
10

CS090812_V2