

SD

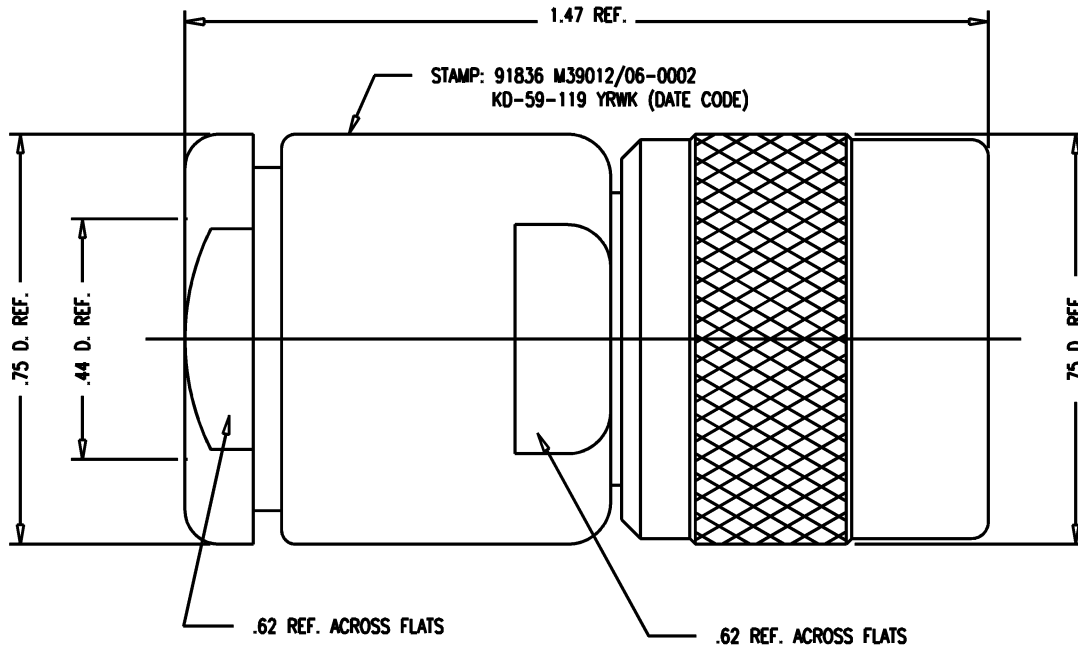

NOTES:

1. FOR USE WITH RG-8, 9, 213 & 214/U CABLES.
2. FOR CABLING INSTRUCTIONS SEE CP-1022.
3. INTERFACE PER MIL-STD-348, FIG. 302-1.
4. MATERIALS:
 - INSULATOR- TEFLON, ASTM-D-4894
 - GASKETS-SILICONE RUBBER, ZZ-R-765
 - OUTER CONTACT } BER. COP., ASTM-B-196
 - SPRING WASHER }
 - ALL OTHER PARTS-BRASS, ASTM-B16
5. FINISHES:
 - CENTER CONTACT } GOLD PLATE PER MIL-G-45204
 - ALL OTHER METAL PARTS-SILVER PLATE PER QQ-S-365
6. ELECTRICAL CHARACTERISTICS:
 - NOMINAL IMPEDANCE-50 OHMS
 - WORKING VOLTAGE-1000 VRMS
 - FREQUENCY RANGE-DC TO 11 GHZ

M39012/06-0002

REVISIONS	
ISSUE	CHANGES
0	ER 5727 03/09/68
1	CN 8318 A WLA 02/20/70
2	CN 10482 A CC 11/13/71
3	CN 12527 A JL 08/01/73
4	CN 15077 A GA 01/07/76
5	CN 20440 C KOR 05/08/80
6	CN 23169 E JEP 04/13/82
7	CN 32263 A LNM 06/07/90
8	CN 37668 C REDRAWN TML 11/16/98
9	CN 37840 E TML 05/27/99
KD59119S	

SCALE 4:1	
APPROX SURFACE AREA	
KD-59-119	
USED ON	
REF: SUPERSEDES UG-573B/U	
PLUG, C	
DRAWN TML	DATE 11/17/98
DESIGN	DATE
APPR.	DATE

KINGS
ELECTRONICS CO., INC.
TUCKAHOE, NEW YORK 10707

M39012/06-0002

SD