

UHF CONNECTORS

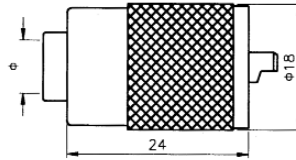

2750 SERIES.

PLUG TWIST ON (PL.259)



Part Number	Ω	Cable
2750-31521	50	RG-58
2750-35521	50	RG-213
2750-32721	75	RG-59

REDUCER (RG-58)

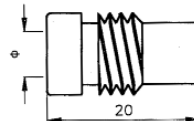

Part Number
2750-00001

JACK SOLDER BULKHEAD

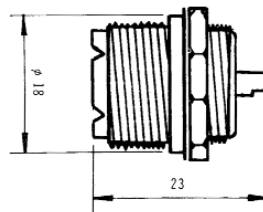

Part Number	Ω
2750-31556	50
2750-31756	75

RECOMMENDED HOLE PATTERN



JACK SOLDER PANEL

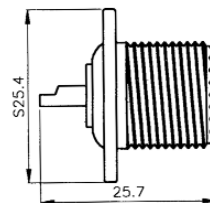

Part Number	Ω
2750-31557	50
2750-31757	75

RECOMMENDED HOLE PATTERN

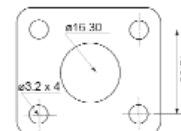

PLUG ATTACHED CRIMP

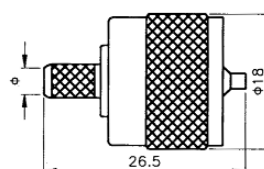

Part Number	Ω	Cable
2750-31501	50	RG-58
2750-35501	50	RG-213

UHF CONNECTORS



2750 SERIES.

PLUG ATTACHED CRIMP

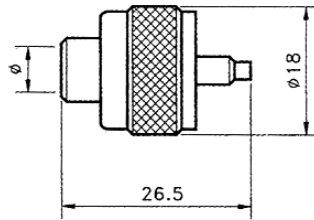

Part Number	Ω	Cable
2750-31522	50	RG-58
2750-32722	75	RG-59

PLUG CLAMP

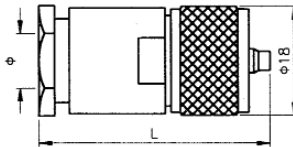

Part Number	Ω	Cable
2750-31541	50	RG-58
2750-35541	50	RG-213

PLUG RIGHT ANGLE TWIST ON

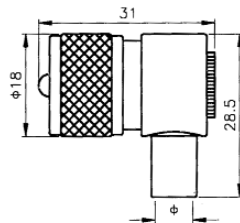

Part Number	Ω	Cable
2750-31523	50	RG-58

JACK CLAMP

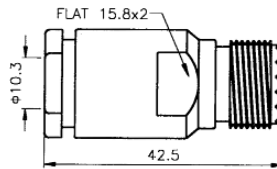

Part Number	Ω	Cable
2750-35542	50	RG-213

PLUG ATTACHED CRIMP

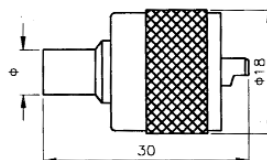

Part Number	Ω	CABLE
2750-31502	50	RG-58