

Laser DIODE

LD785-SH300



S/N: 785P300CK30.A01

Center Wavelength: 788.8 nm

Fiber Type: NA

Test Date: 10/3/2017



Diode Package: TO 9 mm

Connector: NA

Tested By: SooAn



QA: Pass

Summary of Test Data (CW, T_{case}=25°C)

Parameter	Symbol	Value	Unit
Fiber Output Power	P _{op}	300.0	mW
Operating Current@P _{op}	I _{op}	374.5	mA
Operating Voltage@P _{op}	V _{op}	2.14	V
Threshold Current	I _{th}	79.6	mA
Slope Efficiency	ΔP/ΔI	0.99	W/A

Absolute Maximum Ratings

Parameter	Ratings	Unit
Laser Diode Current*	435	mA
Optical Output Power*	350	mW
LD Reverse Voltage*	2	V
Storage Temperature	-40 to 85	°C
Case Temperature	-10 to 50	°C

* CW, T_{case}=25°C

LASER RADIATION
AVOID EXPOSURE TO BEAM
CLASS 3B LASER PRODUCT

CAUTION- use of controls or adjustments or performance of procedures other than those specified herein may result in hazardous radiation exposure. There are no user serviceable parts in this product. When proper power is applied to this product, Laser radiation will be emitted from TO-window.

785P300CK30.A01
LIV

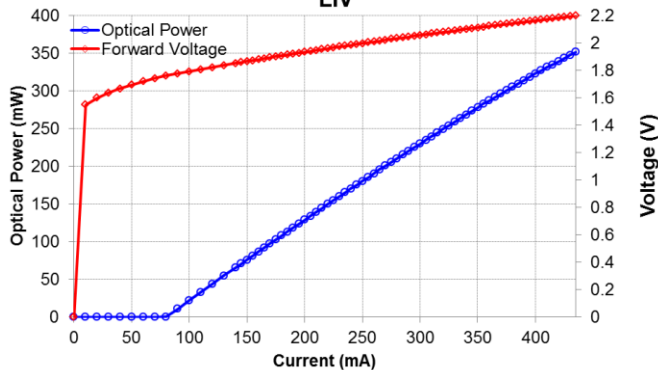

Diode Bottom View

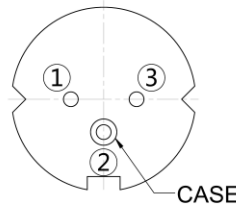

Pin Code H

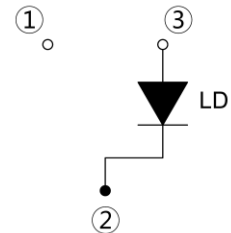

Important Notes:

1. The maximum ratings mean the limitation over which the laser should not be operated even instant time.
2. To protect the laser diode from damage due to static electricity (ESD), please follow proper ESD handling precautions.
3. To ensure safe operation use only with a suitable power source that complies with the pertinent requirements for laser systems as specified in IEC-60825-1 "Safety of Laser Products."



USA, Canada, and South America

Thorlabs, Inc.
 56 Sparta Avenue
 Newton, NJ 07860, USA

Tel: 973-579-7227
 Fax: 973-300-3600

Europe

Thorlabs GmbH
 85221 Dachau, Germany
 Tel: +49-(0)8131-5956-0

Scandinavia

Thorlabs Sweden AB
 400 20 Göteborg, Sweden
 Tel: +46-31-733-30-00

UK and Ireland

Thorlabs LTD.
 Cambridgeshire CB7 4EX, GB
 Tel: +44 (0)1353-654440

Japan and Asia

Thorlabs Japan Inc.
 Toshima-ku, Tokyo 170-0013, Japan
 Tel: +81-3-5979-8889

France

Thorlabs SAS
 78600 Maisons-Laffitte, France
 Tel: +33 (0) 970 444 844

China

Thorlabs China
 Shanghai, China
 Tel: +86 (0)21-32513486



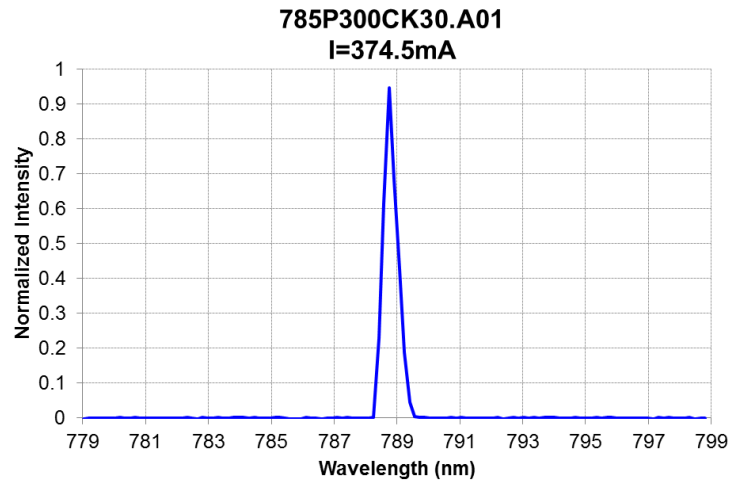

$T_{\text{case}}=25^{\circ}\text{C}$, $I_{\text{op}}=374.5\text{mA}$
Spectrum measured by CCS175.