

SMPM33SBS-0405

SMPM Plug Smooth Bore For RG405
Fitting M38999 Size 12 Insert 18GHz VSWR 1.3* 50Ω

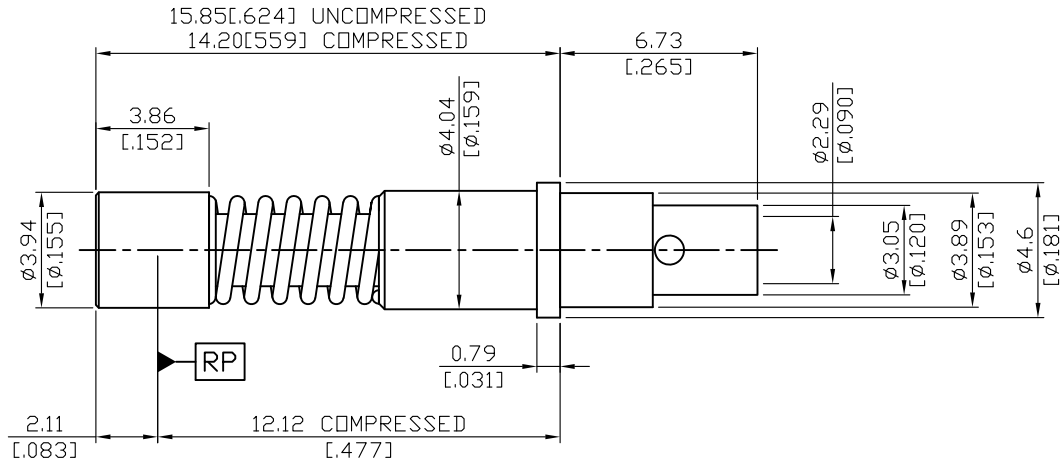

*Using 5002

Parts	Material	Plating (Micro-inch)
Spring	Stainless Steel	Passivated
Ferrule	Stainless Steel	Passivated
Contact Pin	Beryllium Copper	Gold 4 Over Nickel-Phosphorus Alloy 80 Over Copper 20
Insulator	Teflon	
Body	Stainless Steel	Passivated

Suitable Cables: SS405; 5002; T-Flex405; Multibend405; Semi-rigid.085; Multiflex86;
Formable .085; RG405

This part number complies with RoHS.

Notice: JYEBAO reserves the right to make modifications deemed appropriate.

SMPM	SMPM33BS-0405																						
<div data-bbox="113 331 513 376" style="border: 1px solid black; padding: 2px;">Interface</div> <p>MIL STD-348B</p>																							
<div data-bbox="113 495 513 539" style="border: 1px solid black; padding: 2px;">Electrical Data</div> <table border="0" style="width: 100%;"> <tr> <td style="width: 50%;">Impedance</td> <td style="width: 50%;">50Ω</td> </tr> <tr> <td>Frequency range</td> <td>DC to 18GHz</td> </tr> <tr> <td>VSWR</td> <td>≤ 1.3 (18GHz)</td> </tr> <tr> <td>Insertion loss</td> <td>≤ 0.1 x √f(GHz) dB</td> </tr> <tr> <td>Insulation resistance</td> <td>≥ 5000 MΩ</td> </tr> <tr> <td>Contact resistance inner conductor</td> <td>≤ 6mΩ</td> </tr> <tr> <td>Contact resistance outer conductor</td> <td>≤ 2mΩ</td> </tr> <tr> <td>Dielectric withstanding voltage (at sea level)</td> <td>325</td> </tr> </table>				Impedance	50Ω	Frequency range	DC to 18GHz	VSWR	≤ 1.3 (18GHz)	Insertion loss	≤ 0.1 x √f(GHz) dB	Insulation resistance	≥ 5000 MΩ	Contact resistance inner conductor	≤ 6mΩ	Contact resistance outer conductor	≤ 2mΩ	Dielectric withstanding voltage (at sea level)	325				
Impedance	50Ω																						
Frequency range	DC to 18GHz																						
VSWR	≤ 1.3 (18GHz)																						
Insertion loss	≤ 0.1 x √f(GHz) dB																						
Insulation resistance	≥ 5000 MΩ																						
Contact resistance inner conductor	≤ 6mΩ																						
Contact resistance outer conductor	≤ 2mΩ																						
Dielectric withstanding voltage (at sea level)	325																						
<div data-bbox="113 1021 513 1088" style="border: 1px solid black; padding: 2px;">Mechanical Data</div> <table border="1" style="width: 100%; border-collapse: collapse;"> <thead> <tr> <th style="width: 50%;"></th> <th style="width: 25%;">Full Detent</th> <th style="width: 25%;">Smooth bore</th> <th style="width: 10%;"></th> </tr> </thead> <tbody> <tr> <td>Engagement force</td> <td>3.5 typical</td> <td>1.5 typical</td> <td>lbs</td> </tr> <tr> <td>Disengagement force</td> <td>5 typical</td> <td>1.5 typical</td> <td>lbs</td> </tr> <tr> <td>Durability (mating)</td> <td>≥ 100</td> <td>≥ 1000</td> <td></td> </tr> <tr> <td>Contact pin captivation</td> <td colspan="3" style="text-align: center;">≥ 1.5lbs</td> </tr> </tbody> </table>					Full Detent	Smooth bore		Engagement force	3.5 typical	1.5 typical	lbs	Disengagement force	5 typical	1.5 typical	lbs	Durability (mating)	≥ 100	≥ 1000		Contact pin captivation	≥ 1.5lbs		
	Full Detent	Smooth bore																					
Engagement force	3.5 typical	1.5 typical	lbs																				
Disengagement force	5 typical	1.5 typical	lbs																				
Durability (mating)	≥ 100	≥ 1000																					
Contact pin captivation	≥ 1.5lbs																						
<div data-bbox="113 1357 513 1413" style="border: 1px solid black; padding: 2px;">Environmental Data</div> <table border="0" style="width: 100%;"> <tr> <td style="width: 50%;">Temperature range</td> <td style="width: 50%;">-65°C to +165°C</td> </tr> <tr> <td>Thermal shock</td> <td>MIL-STD-202, Method 107, Condition B</td> </tr> <tr> <td>Moisture resistance</td> <td>MIL-STD-202, Method 106</td> </tr> <tr> <td>Corrosion</td> <td>MIL-STD-202, Method 101, Condition B</td> </tr> <tr> <td>RoHS</td> <td>Compliant</td> </tr> </table>				Temperature range	-65°C to +165°C	Thermal shock	MIL-STD-202, Method 107, Condition B	Moisture resistance	MIL-STD-202, Method 106	Corrosion	MIL-STD-202, Method 101, Condition B	RoHS	Compliant										
Temperature range	-65°C to +165°C																						
Thermal shock	MIL-STD-202, Method 107, Condition B																						
Moisture resistance	MIL-STD-202, Method 106																						
Corrosion	MIL-STD-202, Method 101, Condition B																						
RoHS	Compliant																						
<div data-bbox="113 1715 513 1760" style="border: 1px solid black; padding: 2px;">Tooling</div> <table border="0" style="width: 100%;"> <tr> <td style="width: 50%;">Soldering gauge 0.2mm thick</td> <td style="width: 50%;">ST-0.2</td> </tr> <tr> <td>Soldering fixture</td> <td>ST-008</td> </tr> <tr> <td>Insert for 0.85inch semi-rigid cable</td> <td>ST-009</td> </tr> <tr> <td>Locator tool</td> <td>ST-011</td> </tr> </table>				Soldering gauge 0.2mm thick	ST-0.2	Soldering fixture	ST-008	Insert for 0.85inch semi-rigid cable	ST-009	Locator tool	ST-011												
Soldering gauge 0.2mm thick	ST-0.2																						
Soldering fixture	ST-008																						
Insert for 0.85inch semi-rigid cable	ST-009																						
Locator tool	ST-011																						

Notice: JYEBAO reserves the right to make modifications deemed appropriate.

JYE BAO CO., LTD.

CABLE ASSEMBLY INSTRUCTION

SMPM33SBS-0405	DATE	2018/10/03	REV	—
----------------	------	------------	-----	---

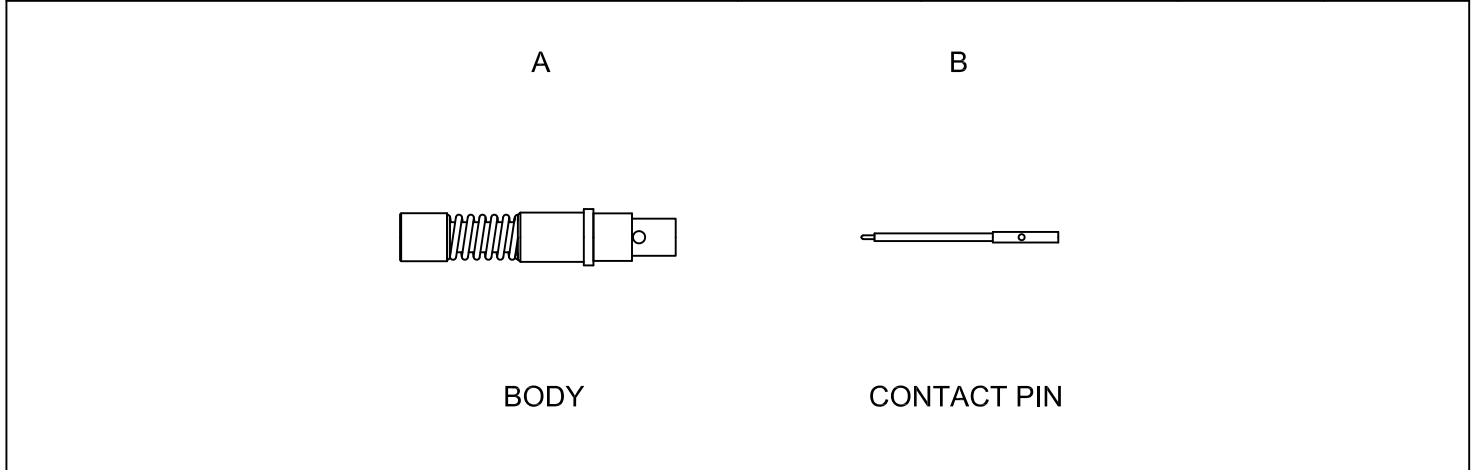
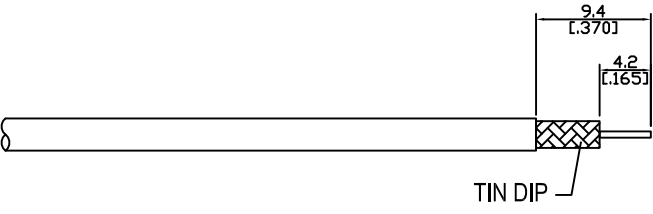
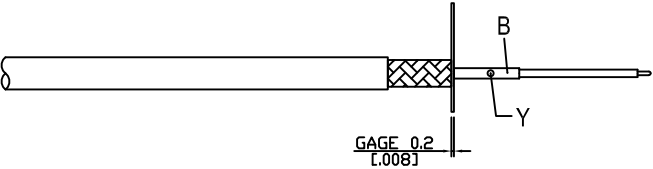
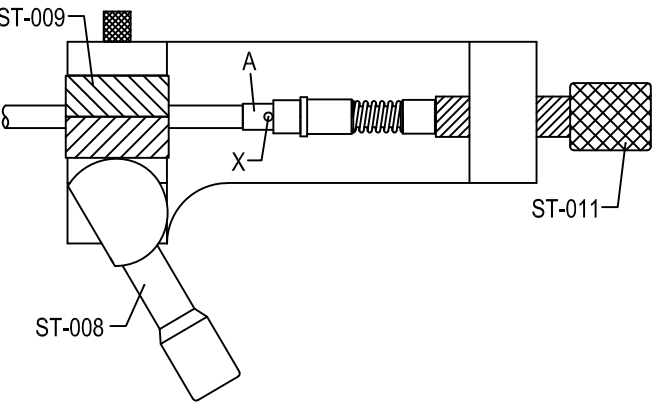

DIAGRAM	ASSEMBLY INSTRUCTION
---------	----------------------

	<p>Step 1: STRIP AS SHOWN. Step 2: TIN DIP.</p>
--	---

	<p>Step 3: PUT 0.2 MM GAGE ST-0.2 IN PLACE, INSERT CABLE'S CENTER CONDUCTOR INTO CENTER PIN " B " AND SOLDER IN " Y ".</p>
---	--

	<p>Step 4: USE SOLDERING FIXTURE " ST-008 ", INSERT TOOL " ST-009 " AND LOCATOR TOOL " ST-011 " TO FIX THE CONNECTOR. SOLDER IN " X ".</p>
---	--

This part number complies with RoHS.
 Notice: JYEBAO reserves the right to make modifications deemed appropriate.

APPROVED	CHECKED	DRAWING
		<i>Albert</i>

SMPM33SBS-0405

S11

