

PLEASE CHECK WWW.MOLEX.COM FOR LATEST PART INFORMATION

Part Number: [0190690031](#)
Status: **Active**
Overview: [Solderless Terminals](#)
Description: [Krimptite Ring Tongue Terminal for 18-22 AWG Wire](#)

Documents:

3D Model	Product Specification PS-19902-011-001 (PDF)
Drawing (PDF)	Product Specification PS-19902-013-001 (PDF)
3D Model (PDF)	RoHS Certificate of Compliance (PDF)

Agency Certification

CSA	LR18689
UL	E32244

General

Product Family	Ring and Spade Terminals
Series	19069
Crimp Quality Equipment	Yes
Overview	Solderless Terminals
Product Name	Krimptite
Taxonomy	Ring and Spade Terminals
Type	Ring
UPC	800755066234

Physical

Barrel Type	Closed
Insulation	None
Material - Plating Mating	Tin
Material - Plating Termination	Tin
Net Weight	0.340/g
Packaging Type	Bag
Plating min - Mating	2.540µm
Plating min - Termination	2.540µm
Stud Size	5-6 (M3-3.5)
Termination Interface: Style	Crimp or Compression
Wire Size AWG	18, 20, 22
Wire Size mm ²	0.35-0.80

Solder Process Data

Lead-freeProcess Capability	N/A
-----------------------------	-----

Material Info

Engineering Number	AA-120-06
--------------------	-----------

Reference - Drawing Numbers

Product Specification	PS-19902-011-001, PS-19902-013-001
Sales Drawing	SD-19069-004-001

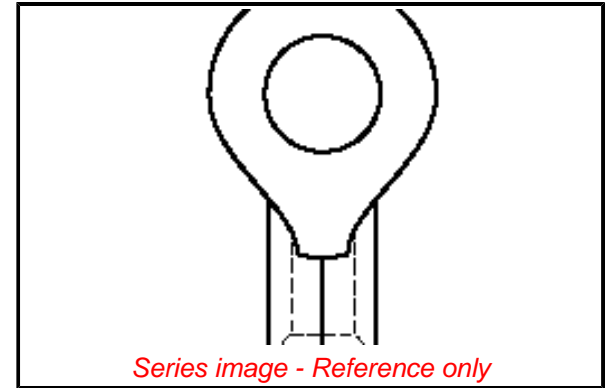

EU ELV

Not Relevant

EU RoHS

Compliant

REACH SVHC

Not Contained per -
D(2022)9120-DC (17
Jan 2023)

Halogen-Free

Status

Low-Halogen

For more information, please visit [Contact US](#)

China ROHS

ELV

RoHS Phthalates

China RoHS

Green Image

Not Relevant

Not Contained

Search Parts in this Series

[19069 Series](#)

Application Tooling | FAQ

Tooling specifications and manuals are found by selecting the products below. Crimp Height Specifications are then contained in the Application Tooling Specification document.

Global

Description	Product #
PremiumGrade Hand Crimp Tool for Krimptite/Versakrimp Terminals and Splices, 10-22 AWG and 6.0mm ² - 0.5mm ²	640030100
Crimp Head for the AT-200 Pneumatic Hand Tool	640070100
ServiceGrade Hand Crimp Tool - Ratchet	640160038

This document was generated on 04/04/2023

PLEASE CHECK WWW.MOLEX.COM FOR LATEST PART INFORMATION