

REVISION HISTORY			
REV	DESCRIPTION	DATE	APPROVED
-	REL. DCN 33116	06/05	CCC

# PRODUCT DATA DRAWING

## MATERIAL:

BODY & CAP: STAINLESS STEEL PER AMS-5640, ALLOY UNS S30300, TYPE 303. COND. A

CONTACTS: BERYLLIUM COPPER PER ASTM B196, ALLOY UNS C17300, TD04

SLEEVE & SET SCREW: BRASS PER ASTM B16, ALLOY UNS C36000

INSULATOR: PTFE PER ASTM D1710, TYPE I, GRADE 1, CLASS B

BELLOWS SPRING: ELECTRO-DEPOSITED NICKEL

RESISTOR ELEMENT: TANTALUM NITRIDE

## FINISH:

BODY & CAP: PASSIVATED PER AMS-QQ-P-35, TYPE II

CONTACTS, SLEEVE & SET SCREW: GOLD PER ASTM B488, TYPE I, CODE C, CLASS 1; OVER NICKEL PER AMS-QQ-N-290, CLASS 1, .00005" MIN.

## PERFORMANCE

IMPEDANCE: 50 OHMS  
 FREQ. RANGE: DC TO 12.4 GHz  
 VSWR: 1.25:1 DC TO 12.4 GHz

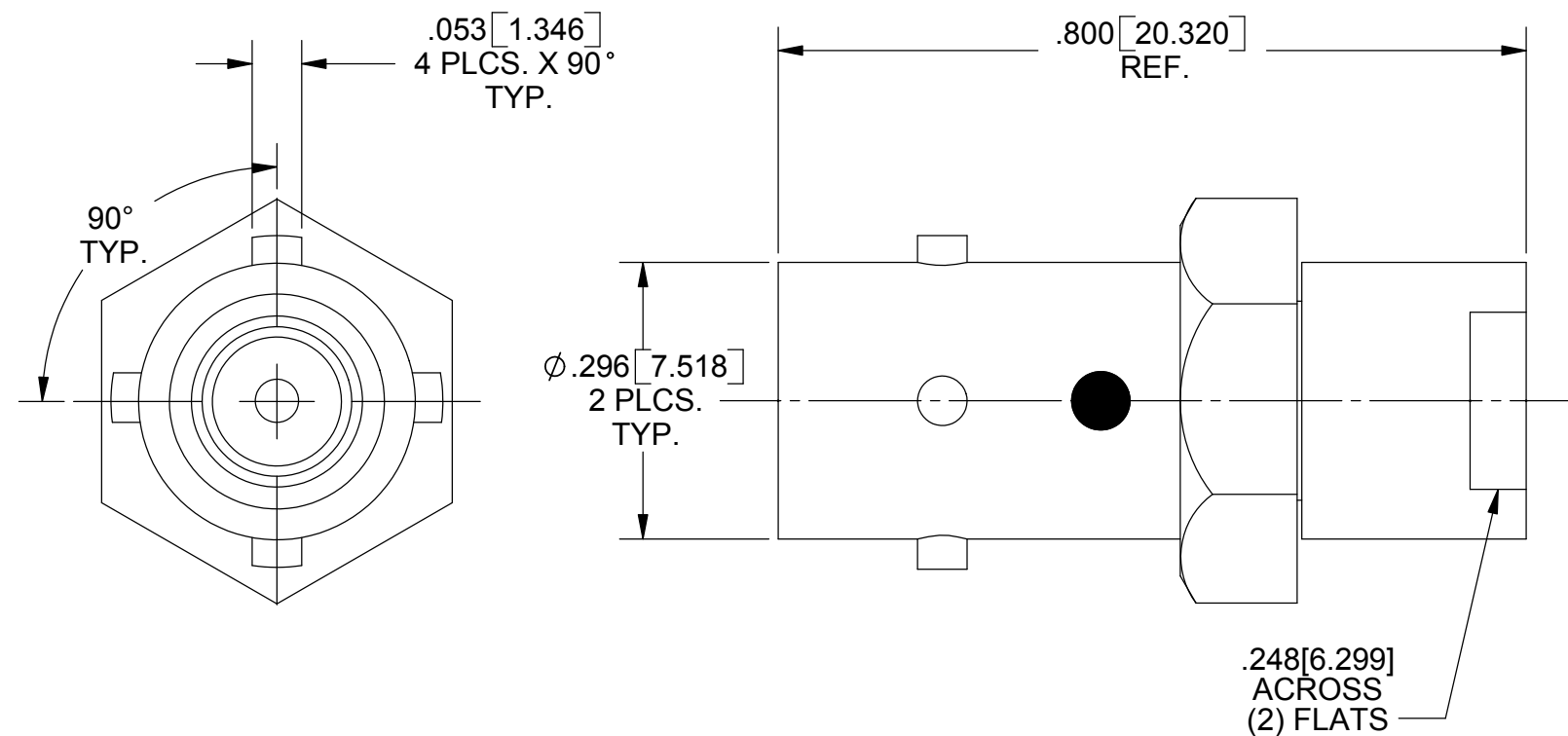

MATERIAL: SEE NOTES	DIMENSIONS ARE IN INCHES TOLERANCES: FRACTIONAL: ±1/64 ANGULAR: X° ±1'0" X*X' ±15'	UNLESS OTHERWISE SPECIFIED 1) ALL DIMENSIONS ARE IN INCHES (MILLIMETERS) 2) ALL DIMENSIONS ARE AFTER PLATING. 3) BREAK CORNERS & EDGES .005 R. MAX. 4) CHAM. 1ST & LAST THREADS. 5) SURFACE ROUGHNESS 63 MIL-STD-10. 6) DIA.'S ON COMMON CENTERS TO BE CONCENTRIC WITHIN T.I.R. 7) REMOVE ALL BURRS	<b>SV Microwave, Inc.</b> 2400 Centrepark West Drive, Suite 100 West Palm Beach, FL 33409
FINISH: SEE NOTES	DECIMAL: .X ±.030 .XX ±.010 .XXX ±.005	INTERPRET DIMENSIONS AND TOLERANCES PER ASME Y14.5M - 1994	TITLE: ZMA (90° TYP.) JACK TERMINATION
SURFACE AREA: N/A	THIRD ANGLE PROJECTION	DRAWN: MGT 06/09/05	SIZE: B CAGE CODE: 95077 DWG. NO.: SF8087-6010
PROPRIETARY THE INFORMATION CONTAINED IN THIS DRAWING IS THE SOLE PROPERTY OF SV MICROWAVE, INC. ANY REPRODUCTION IN PART OR AS A WHOLE WITHOUT THE WRITTEN PERMISSION OF SV MICROWAVE, INC IS PROHIBITED.		CHECKED: STW 01/10/03	SCALE: 5:1
		APPROVED: STW 01/10/03	SHEET 1 OF 1