

OSMT Surface Mount Coaxial Connectors (Continued)

Straight SMT PCB Mount Plug Receptacles

Multi-directional cable entry, 360° rotation. Recommended for use in passive cable applications or with supplementary cable tie-downs.

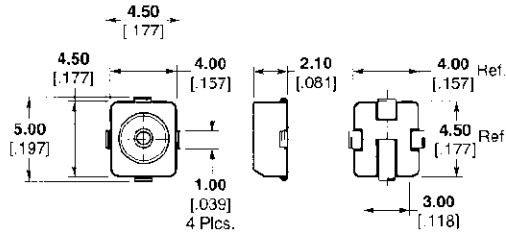

| Packaging | Quantity | M/A-COM Model No. | Part No. |
|-----------------------------------|--------------------|-------------------|------------------|
| Bulk | Customer Specified | 2367-0000-54 | 1251802-1 |
| 178 7.0 Dia. Taping | 800 pcs/reel | 2367-5001-54 | 1083946-1 |
| 330 13.3 Dia. Taping | 3000 pcs/reel | 2367-5002-54 | 1055689-1 |

Note: Requires part number 1221286-1 Engagement/Disengagement Tool.

Slotted single direction cable entry. Recommended for use in applications where bending forces may be applied to the cable.

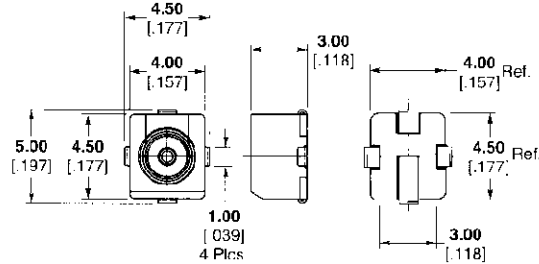

| Packaging | Quantity | M/A-COM Model No. | Part No. |
|-----------------------------------|--------------------|-------------------|------------------|
| Bulk | Customer Specified | 2367-5006-54 | 1055690-1 |
| 178 7.0 Dia. Taping | 600 pcs/reel | 2367-5015-54 | 1254242-1 |
| 330 13.3 Dia. Taping | 2500 pcs/reel | 2367-5016-54 | 1055692-1 |

Note: Requires part number 1055886-1 Disengagement Tool. Engagement requires no tooling.