

CIRCON R2.5 SERIES

The R2.5 Series Circular Connectors are used for signal transmission for junctions for BUS-systems and for controls. This new generation of connectors is available in the traditional screwing or a push pull version. The patented insulation body fits all housing designs and can fit both pins and sockets in all the termination methods.

of contacts: 8+1, 9, 12, 17



Circular Connectors Circon R2.5 Series

TECHNICAL DATA

Inserts:

Number of Contacts: 8+1, 9, 12, 17

Rated Voltage:

VDE: 8+1 contacts: 160
12 contacts: 100 (solder), 160 (crimp) 9 contacts: 160
17 contacts: 40 (solder), 125 (crimp)

UL: 250V, AC

CSA: 250V, AC

Rated Current:

VDE: 9 (1mm contacts); 25 (2mm contacts)

UL: 7.5 (1mm contacts); 22 (2mm contacts)

CSA: 7.5 (1mm contacts); 22 (2mm contacts)

Test Voltage: (kV AC)

8+1 contacts: 2.5; 9 contacts: 2.5; 12 contacts: 1.5 (solder), 2.5 (crimp); 17 contacts: 1.5

Pollution Level:

3

Temperature Range:

-40°C to 125°C

Protection Class:

IP 67 mated, DIN 40050

Wire Gauge:

Crimp: 1mm contacts: 0.6 - 1.0mm² (AWG 18 UL)
2mm contacts: 0.5 - 2.5mm² (AWG 20 - 14)

Solder: 2.5mm²

Solder pin Ø 1mm; 7.5 length

Contact Resistance:

<5

Mating Cycles:

500 (higher mating cycles depends on the application)

Material:

Housing:

Die cast zinc, nickel plated

Insulation Body:

PBT according to UL 94 V-O

Gaskets:

Viton/ H-NBR

Clamp ring:

PA 6.6

Contacts:

Copper alloy, gold plated

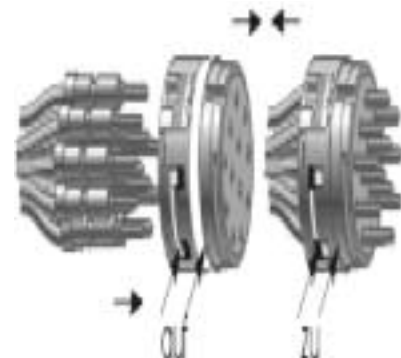
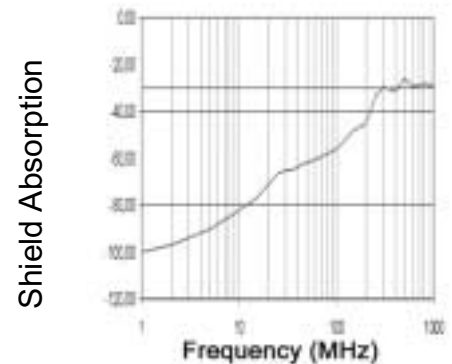

www.contactelectronics.com
800-221-1451

Circular Connectors Circon R2.5 Series

R2.5 CONNECTORS

PLASTIC CLAMP RING



These connectors mate with the connectors on the next two pages.

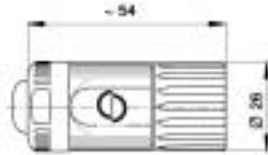

METAL CLAMP RING



These connectors can be male or female.

Plastic Clamp Ring	Metal Clamp Ring	Cable Diameter	Standard Pack
72.040000	72.041000	5.5 - 10.5 mm	5
72.040010	72.041010	5.5 - 10.5 mm	20
72.040100	72.041100	9 - 12 mm	5
72.040110	72.041110	9 - 12 mm	20
-	72.041700	7.5 - 14 mm	5
-	72.041710	7.5 - 14 mm	20

All accessories except dust cap can be added.

R2.5 PUSH PULL CONNECTOR

PLASTIC CLAMP RING



These connectors mate with the connectors on the next two pages.



METAL CLAMP RING



These connectors can be male or female.

Plastic Clamp Ring	Metal Clamp Ring	Cable Diameter	Standard Pack
72.045000	72.046000	5.5 - 10.5 mm	5
72.045010	72.046010	5.5 - 10.5 mm	20
72.045100	72.046100	9 - 12 mm	5
72.045110	72.046110	9 - 12 mm	20
-	72.046700	7.5 - 14 mm	5
-	72.046710	7.5 - 14 mm	20

All accessories except dust cap can be added.

R2.5 90° CONNECTOR

PLASTIC CLAMP RING



These connectors mate with the connectors on the next two pages.

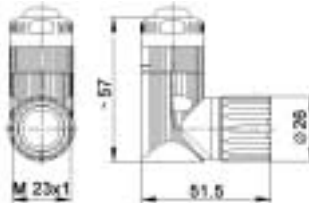

METAL CLAMP RING



These connectors can be male or female.

Plastic Clamp Ring	Metal Clamp Ring	Cable Diameter	Standard Pack
72.050000	72.050500	5.5 - 10.5 mm	5
72.050010	72.050510	5.5 - 10.5 mm	20
72.050100	72.050600	9 - 12 mm	5
72.050110	72.050610	9 - 12 mm	20
-	72.050700	7.5 - 14 mm	5
-	72.050710	7.5 - 14 mm	20

All accessories except dust cap can be added.

Circular Connectors Circon R2.5 Series

R2.5 COUPLING CONNECTORS

PLASTIC CLAMP RING



The accessories which can be added include: dust cap, clamp rings, shield ring, metal flange

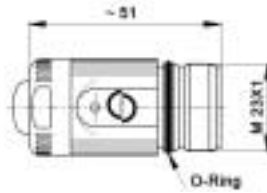

METAL CLAMP RING



These connectors can be male or female.

Plastic Clamp Ring	Metal Clamp Ring	Cable Diameter	Standard Pack
72.060000	72.061000	5.5 - 10.5 mm	5
72.060010	72.061010	5.5 - 10.5 mm	20
72.060100	72.061100	9 - 12 mm	5
72.060110	72.061110	9 - 12 mm	20
-	72.061700	7.5 - 14 mm	5
-	72.061710	7.5 - 14 mm	20

3

R2.5 PANEL MOUNT SOCKET



Dust cap is the only accessory which can be added

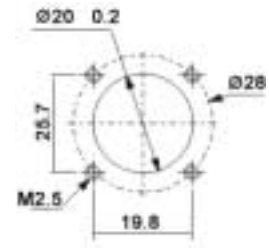
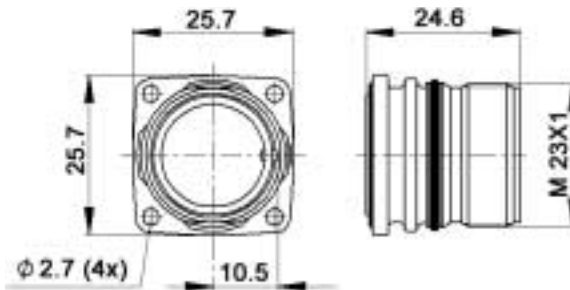

Part Number	Standard Pack
72.000000	5
72.000010	20

These connectors can be male or female.

R2.5 ANGLED PANEL MOUNT SOCKET



Dust cap is the only accessory which can be added

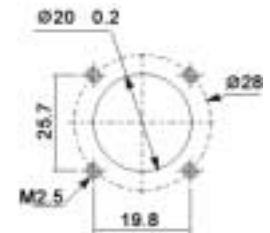
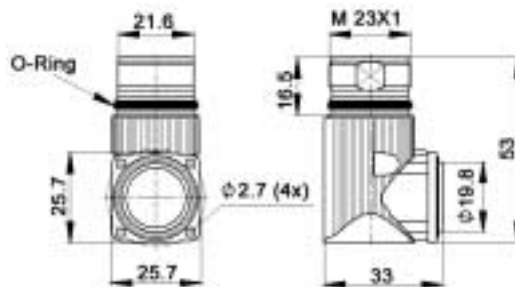

Part Number	Standard Pack
72.020000	5
72.020010	20

These connectors can be male or female.

Circular Connectors Circon R2.5 Series

R2.5 PANEL MOUNT SOCKET: PG 13.5

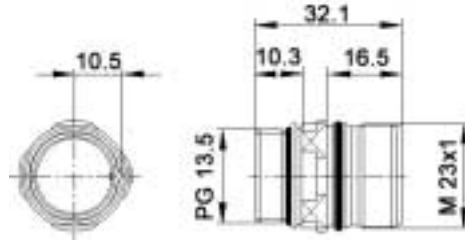

Dust cap is the only accessory which can be added

Part Number	Standard Pack
72.010000	5
72.010010	20

These connectors can be male or female.

R2.5 PANEL MOUNT SOCKET: PG 13.5 WITH LOCKING NUT

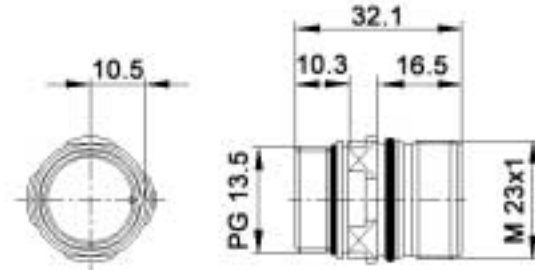

Dust cap is the only accessory which can be added

Part Number	Standard Pack
72.110000	5
72.110010	20

These connectors can be male or female.

R2.5 COUPLING WITH CENTRAL FIXING

PLASTIC CLAMP RING

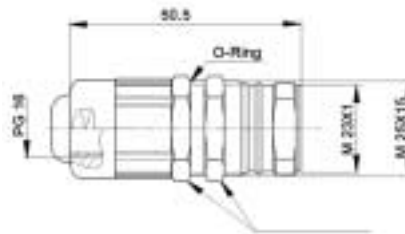

METAL CLAMP RING



No accessories can be added.

Plastic Clamp Ring	Metal Clamp Ring	Cable Diameter	Standard Pack
72.140000	72.141000	5.5 - 10.5 mm	5
72.140010	72.141010		20
72.140100	72.141100	9 - 12 mm	5
72.140110	72.141110		20
	72.141700	7.5 - 14 mm	5
	72.141710		20

These connectors can be male or female.

Circular Connectors Circon R2.5 Series

R2.5 INSULATION BODY

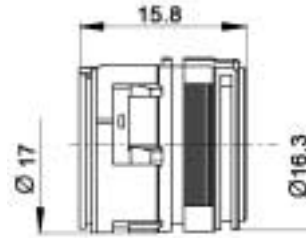

3

8+1 CONTACTS

Clockwise Numeration
Male Female

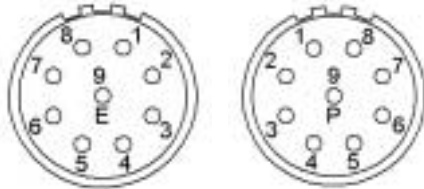

Counter Clockwise Numeration
Male Female

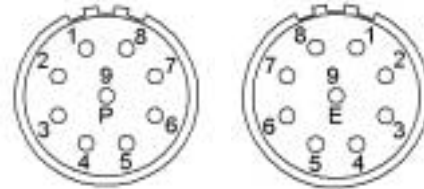

Without Contacts		Clockwise with Solder Contacts		Counter Clockwise with Solder Contacts		1 mm Contacts	2 mm Contacts	Standard Pack
Clockwise	Counter	Male	Female	Male	Female			
-	-	73.022600	73.012100	73.022100	73.012600	8	1	5
73.002110	73.002610	73.022610	73.012110	73.022110	73.012610	8	1	20

Contacts follow the insulation bodies

9 CONTACTS

Clockwise Numeration
Male Female



Counter Clockwise Numeration
Male Female

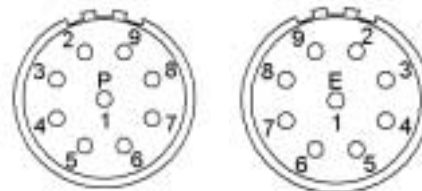

Without Contacts		Clockwise with Solder Contacts		Counter Clockwise with Solder Contacts		1 mm Contacts	2 mm Contacts	Standard Pack
Clockwise	Counter	Male	Female	Male	Female			
-	-	73.023600	73.013100	73.023100	73.013600	9	-	5
73.003610	73.003110	73.023610	73.013110	73.023110	73.013610	9	-	20

Contacts follow the insulation bodies

Circular Connectors Circon R2.5 Series

R2.5 INSULATION BODY

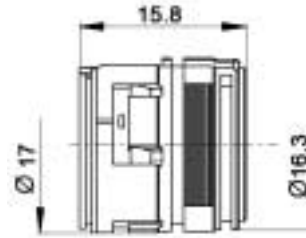

12 CONTACTS

Clockwise Numeration
Male Female

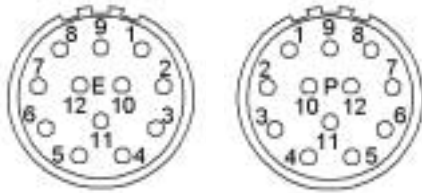

Counter Clockwise Numeration
Male Female



Without Contacts		Standard Numeration with Solder Contacts		Counter Clockwise with Solder Contacts		1 mm Contacts	2 mm Contacts	Standard Pack
Clockwise	Counter	Male	Female	Male	Female			
-	-	73.024600	73.014100	73.024100	73.014600	12	-	5
73.004610	73.004110	73.024610	73.014110	73.024110	73.014610	12	-	20

Contacts follow the insulation bodies

17 CONTACTS

Clockwise Numeration
Male Female

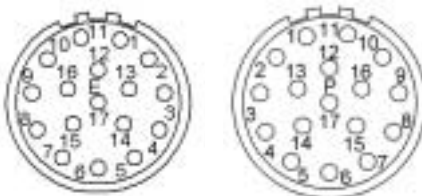

Counter Clockwise Numeration
Male Female

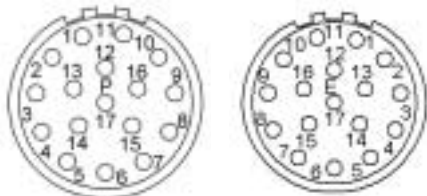

Without Contacts		Standard Numeration with Solder Contacts		Counter Clockwise with Solder Contacts		1 mm Contacts	2 mm Contacts	Standard Pack
Clockwise	Counter	Male	Female	Male	Female			
-	-	73.026600	73.016100	73.026100	73.016600	17	-	5
73.006610	73.006110	73.026610	73.016110	73.026110	73.016610	17	-	20

Contacts follow the insulation bodies

Circular Connectors Circon R2.5 Series

CONTACTS

CRIMP CONTACTS

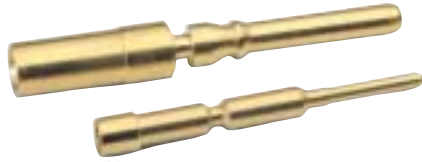

SOLDER CONTACTS



MALE CONTACTS

Contact Type	1mm Contacts 0.14 - 1.0 mm ²	2mm Contacts 1.0 - 2.5 mm ²	Standard Pack
Crimp	74.020000	74.021000	100
Solder	74.022000	74.023000	100
PCB Solder	74.024000	-	100

PCB Contacts
mount directly
to a circuit
board

FEMALE CONTACTS

Contact Type	1mm Contacts		2mm Contacts	Standard Pack
	Slot 0.14 - 1.0 mm ²	Hyper Boloid 0.14 - 1.0 mm ²	Slot 1.0 - 2.5 mm ²	
Crimp	74.020600	74.020500	74.021600	100
Solder	74.022600	74.022500	74.023600	100
PCB Solder	74.024600	-	-	100

PCB Contacts
mount directly
to a circuit
board

ACCESSORIES

*Standard Packs of 20

Cable Clamp Ring

Dia. 5.5 - 10.5 mm: 75.006710
Dia. 9 - 12 mm: 75.006810

Shield Ring

75.002010

PG 13.5 Adapter

75.006110

Distance Jacket

75.004010

Clamp Ring Plastic

75.006510

Clamp Ring Metal

75.005910

Metal Flange with seal

75.006210

Dust Cap
75.006010

www.contactelectronics.com
800-221-1451

Circular Connectors Circon R2.5 Series

R2.5 CIRCULAR TOOLS

Removal Tool
75.005100

Assembly Key
75.005200

Insertion Tool
75.005600

**Hook
Spanner**

**Fastening Tool for
Coupling Ring**
75.007500

* Standard Pack of 1

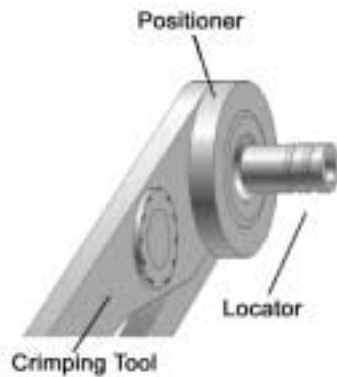

Tool Case: 75.001000

Includes:

- 2 Insertion tools
- 2 Assembly Keys
- 1 Hook spanner
- 1 Removal tool for insulation body
- 1 Removal tool for 1mm contacts
- 1 Removal tool for 2mm contacts

Part Number	Description	Standard Pack
75.008000	Small Crimping Tool: 0.06 - 1.0 mm ² (Positioner & locator included)	1
75.008100	Large Crimping Tool: 0.34 - 4.0 mm ² (Positioner included)	1
75.008600	Locator for large crimping tool: 1mm contacts	1
75.008700	Locator for large crimping tool: 2mm contacts	1
75.008400	Spare positioner for small crimping tool	1
75.008500	Spare positioner for large crimping tool	1

www.contactelectronics.com
800-221-1451

