

LCZ-2A Series
Single-Mode
φ 1.25 mm Zirconia FERRULE
- for LC Connector -

TECHNICAL SPECIFICATIONS

Seiko Instruments Inc.
OFC Division
8, Nakase 1-Chome, Mihama-ku
Chiba-shi, Chiba 261-8507, JAPAN
Telephone: +81-43-211-1211
Facsimile: +81-43-211-8039

LCZ-2A Series Single-Mode ϕ 1.25 mm Zirconia FERRULE (for LC Connector)
TECHNICAL SPECIFICATIONS

Document Number ACD-33A2-01

ACD-33A2-01 March 2003

Copyright 2003 by Seiko Instruments Inc.
All right reserved.

The information contained herein shall not reproduced or disclosed to any third party without the express written consent of **SII**.

The Specifications contained herein are subject to change without notice.

SII is a trademark of **Seiko Instruments Inc.**

Please address any questions, comments, and suggestions to:

Seiko Instruments USA Inc.

Electronics Components Division
2990 West Lomita Boulevard
Torrance, CA 90505, U.S.A.
Phone: +1-310-517-7780
Facsimile: +1-310-517-7792

Seiko Instruments GmbH

OFC Division
Siemensstraße 9b
D-63263 Neu-Isenburg, Germany
Phone: +49-6102-297-0
Facsimile: +49-6102-297-211

Seiko Instruments (H.K.) Ltd.

Sales Department
4th & 5th Floor, Wyler Center 2
200 Tai Lin Pai Road, Kwai Chung
N.T., Kowloon, Hong Kong
Phone: +852-2421-8611
Facsimile: +852-2480-5479

Seiko Instruments Taiwan Inc.

Sales Department
4F, No.40, Sec. 2, Min Chuan E. Rd.,
Taipei 104, Taiwan, R.O.C.
Phone: +886-2-2563-5001
Facsimile: +886-2-2521-9519

Seiko Instruments Singapore pte. Ltd.

Component Sales Department
2, Marsiling Lane,
Singapore, 739144, Singapore
Phone: +65-269-1370
Facsimile: +65-269-9729

TABLE OF CONTENTS

Section	Page
1. PROVISION	1
1.1. Application limit	1
2. PARTS NUMBER	1
3. GENERAL SPECIFICATIONS	2
3.1. Parts and Materials	2
3.2. Physical Dimensions	2
3.3. General Tolerances	2
4. SHIPPING INSPECTION	2
5. NOTE	2
6. PACKING	2

Table

Table 1	Parts Number	1
Table 2	Parts and Materials	2
Table 3	Physical Specifications	2
Table 4	General Tolerance	2

Figure

Figure 1	LCZ-2A Ferrule	3
----------	----------------	---

1. PROVISION

1.1 Application Limit

These specifications apply to the LCZ-2A Single-Mode ϕ 1.25 mm Zirconia Ferrule (for LC Connector) supplied by SII.

2. PARTS NUMBER

Parts number of the ferrule is shown in Table 1.

Table 1 Parts Number

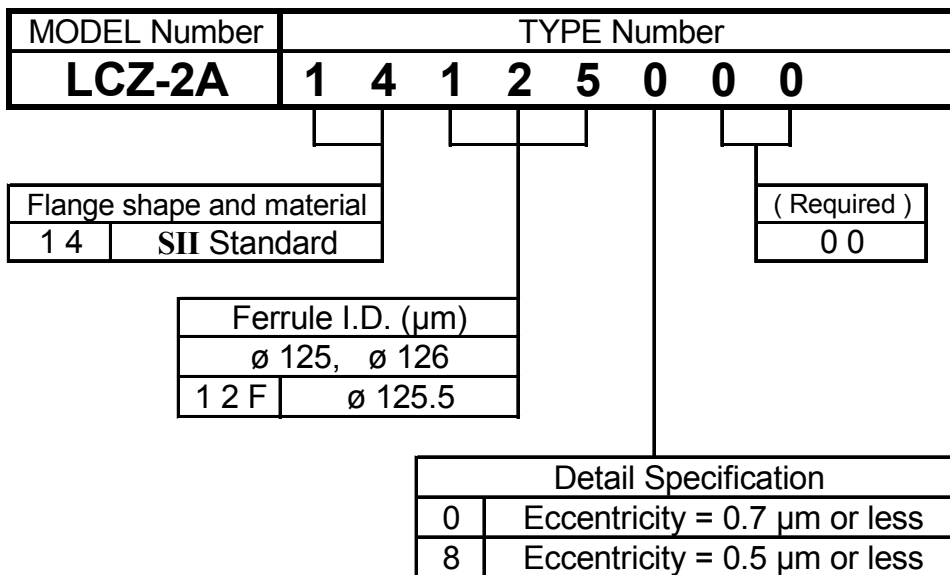

3. GENERAL SPECIFICATIONS

3.1 Parts and Materials

Parts and the materials are shown in Table 2.

Table 2 Parts and Materials

No.	Part Name	Qty	Material	Notes
①	Capillary	1	Zirconia	-
②	Flange	1	Brass	Nickel Plating

3.2 Physical Dimensions

Figure 2 shows the assembled state of LCZ-2A Ferrule.

Table 3 shows the physical specifications of LCZ-2A Ferrule.

Table 3 Physical Specifications

Items	Specifications		Remarks
Hole Concentricity	Type No.=1412*000	ϕ 0.0014 mm or less	Eccentricity = 0.0007 mm or less
	Type No.=1412*800	ϕ 0.0010 mm or less	Eccentricity = 0.0005 mm or less

3.3 General Tolerances

Permissible deviation in dimensions without tolerance indication is in accordance with JIS B 0405 class m, as shown in Table 4.

Table 4 General tolerance (JIS B 0405 class m)

Basic size step [mm]		Permissible deviation [mm]
Over	Under	
0.5	3	± 0.1
3	6	± 0.1
6	30	± 0.2
30	120	± 0.3

4. SHIPPING INSPECTION

The ferrule outer diameter, ferrule hole diameter, concentricity of ferrule hole diameter, mating length and appearance are inspected before shipping and the inspection results are enclosed.

5. PACKING

The product is packed to prevent damage during shipment.

6. NOTE

When discarding this product, please follow the regulations of your own country.

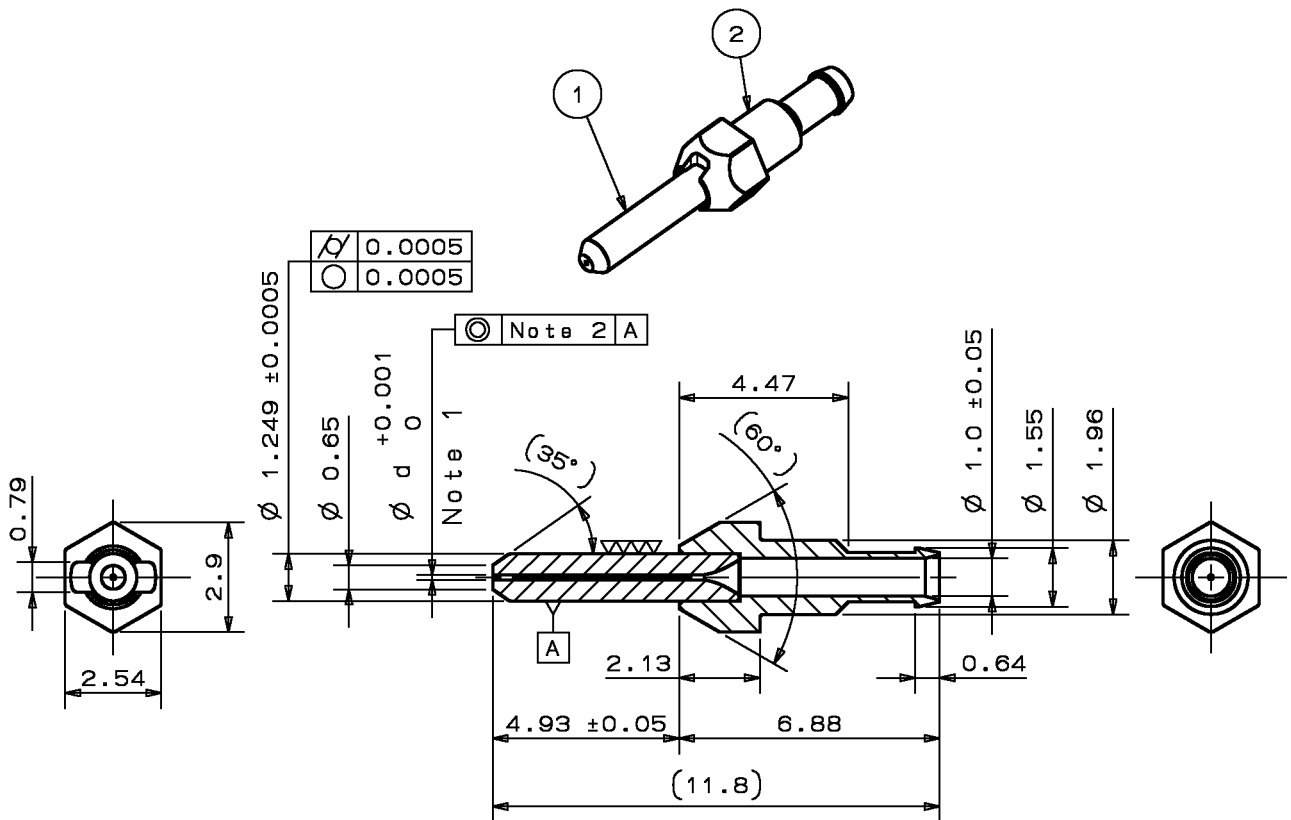

Notes 1: Differ according to the type number shown in Table 1.

2: Differ according to the physical specifications shown in Table 3.

Unit: mm

Figure 1 LCZ-2A Ferrule